



FOR LEASE

2734 East 46th Street

VERNON, CALIFORNIA 90058



Business friendly, Vernon location

RENT \$0.89 PSF gross

2000 AMPS, 3 Phase power

HEIGHT to 18'

ATTRACTIVE offices

14 CAR parking

FUTURE EXPANSION of additional 16,000 SF

\$0.89 PSF GROSS

31,360 AVAILABLE SF

14'-18' CLEAR HEIGHT

This information supplied herein is from sources we deem reliable. It is provided without any representation, warranty, or guarantee, expressed or implied as to its accuracy. Prospective Buyer or Tenant should conduct an independent investigation and verification of all matters deemed to be material, including, but not limited to, statements of income and expenses. Consult your attorney, accountant, or other professional advisor.

BILL JOSEPH
626.204.8366
bill.joseph@kidder.com
LIC N° 00702183

KIDDER.COM

Kidder Mathews

FOR LEASE

2734 East 46th Street

VERNON, CALIFORNIA 90058

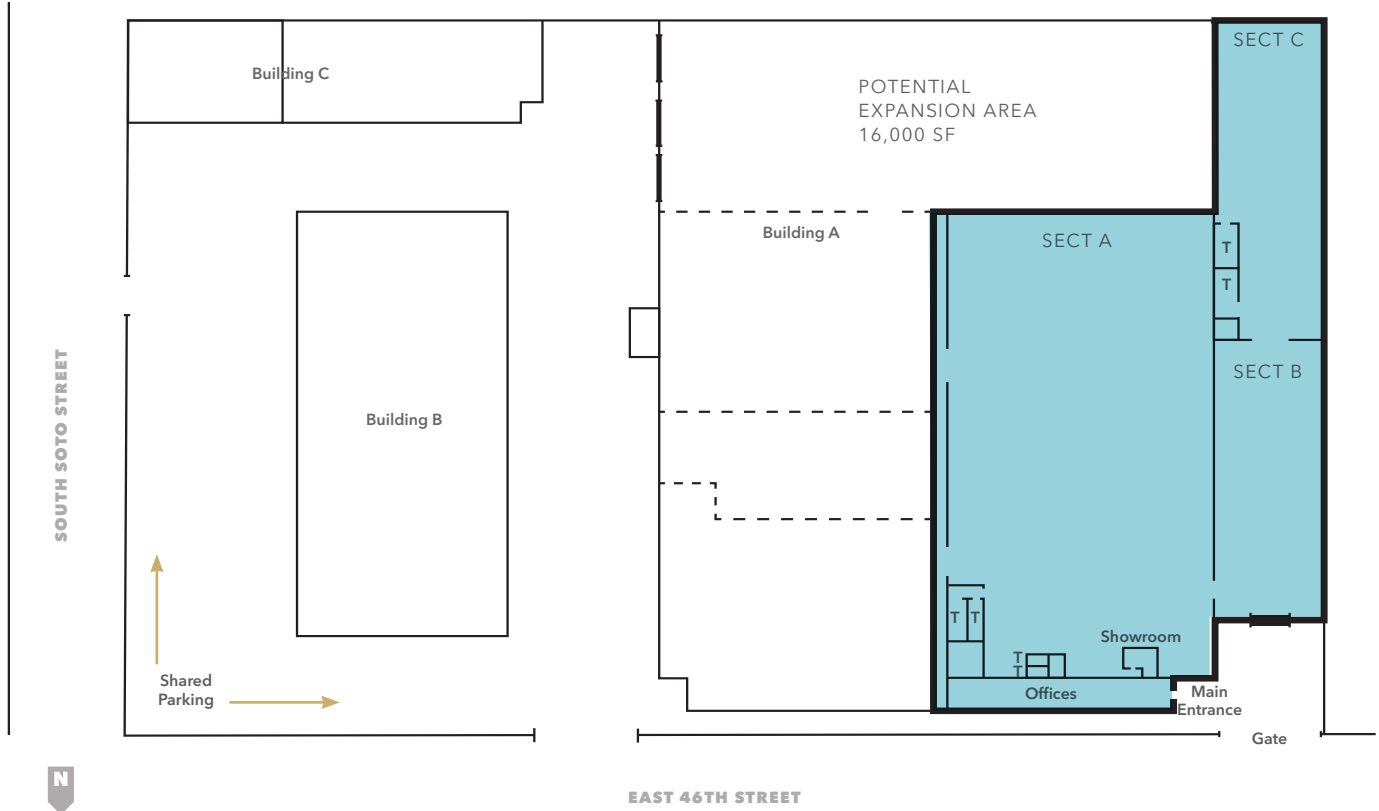

SHADED AREA DENOTES THE SUBJECT PROPERTY

Section	SF	Approximate Dimensions	Clear Height
A	18,900	107' x 175'	14'
B	4,500	42' x 107'	17'
C	5,460	42' x 130'	18'
Offices	2,500	16.5' x 153.5'	N/A
Total	31,360	All sizes and dimensions approximate, not guaranteed.	

BILL JOSEPH

D 626.204.8366

C 323.420.4282

bill.joseph@kidder.com

LIC N° 00702183

KIDDER.COM

This information supplied herein is from sources we deem reliable. It is provided without any representation, warranty, or guarantee, expressed or implied as to its accuracy. Prospective Buyer or Tenant should conduct an independent investigation and verification of all matters deemed to be material, including, but not limited to, statements of income and expenses. Consult your attorney, accountant, or other professional advisor.

