

REDEVELOPED STUDEBAKER BUILDING RETAIL SPACE AVAILABLE

667 N Broad Street
Philadelphia, PA



LISTING DETAILS

- Two First Floor Retail Spaces Available
- Retail 1: 1,578 SF
- Retail 2: 8,000 SF
- Second Floor Retail Space: 11,190 SF
- Potential 15,000 +/- SF Roof Deck
- Historic building, restored to original facade
- Open floor plans
- Ideal for restaurant or creative office space

LOCATION

BSL Station.....	500 Feet
Center City.....	0.9 Mile
Old City.....	2 Miles
Northern Liberties.....	1.5 Miles
Fishtown.....	2 Miles
Stadiums.....	7 Miles
New Jersey.....	5 Miles



BUILDING HISTORY



↓

1917 AUTOMOBILE ROW

The 65-year-old Studebaker Company took over the project, eager to move their Philadelphia location to the city's primary Automobile Row

↓

1918 STEELE & SONS

Steele & Sons designed the building for visual appeal despite its utilitarian use, much like their other buildings along North Broad and elsewhere in the city. The building was complete and showcasing Studebaker automobiles by the middle of 1918.

↓

1957 TRAFFIC COURT

In 1957, the City of Philadelphia took control of 800 North Broad and had city architect Vincent Avellino redesign each floor to be repurposed for a new Philadelphia Traffic Court. This was the role most Philadelphians remember of building, as it operated in this capacity for over three decades.

↓

1990'S CHURCH

At the end of the 1990s, the building was looking dirty, un-used, and abused. However, its salvation was imminent. A few years earlier, Greater Exodus Baptist Church—just south of the structure—had created the non-profit community outreach organization People for People, Inc

↓

2000'S SCHOOL

People for People opened a K-8 charter school in 1999, soon after Pennsylvania passed charter school enabling legislation in 1997. In 2000, the organization acquired the Studebaker building and proceeded with a head-to-toe renovation under the design of Saxon and Capers Architects. The school opened for the 2001-2002 School Year; President George W. Bush visited in April 2002.

↓

2015 STEVEN STARR

In most recent years, it's been home to Steven Starr's Catering Group, which was bought by Trust House in 2015.

○

TODAY

The historic building's original facade has been restored. Starr Events is currently a featured tenant in the Studebaker.

1ST FLOOR PLANS

SHAUN M. LYONS
Slyons@precisionrg.com
267.707.3347

STEVE JEFFRIES
Steve@precisionrg.com
267.707.3327

KEVIN HEALEY
Kevin@precisionrg.com
856.404.1627

GWEN BAKER
Gwen@precisionrg.com
570.977.3853

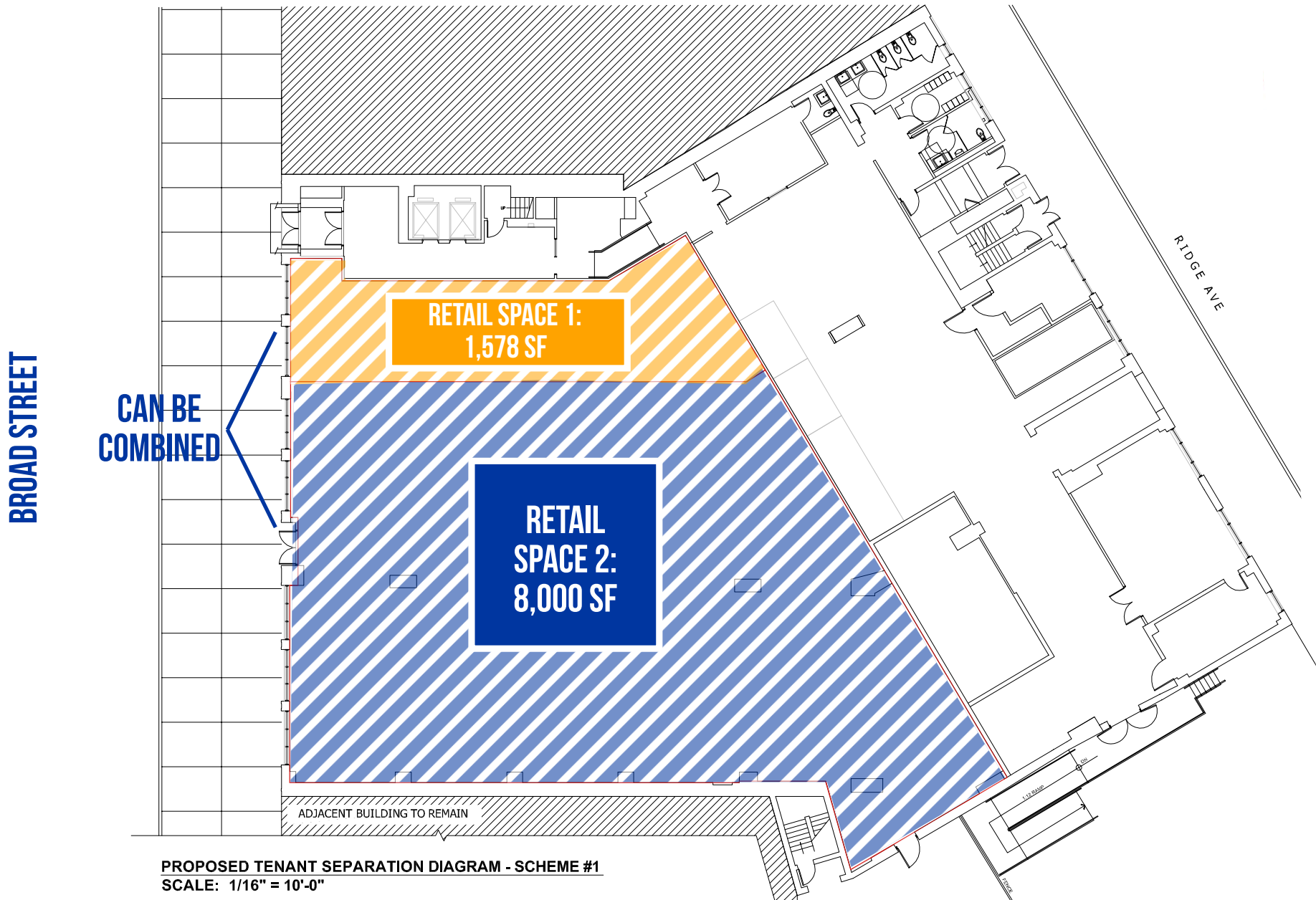

PROPOSED TENANT SEPARATION DIAGRAM - SCHEME #1
SCALE: 1/16" = 10'-0"

2ND FLOOR PLANS

SHAUN M. LYONS
Slyons@precisionrg.com
267.707.3347

STEVE JEFFRIES
Steve@precisionrg.com
267.707.3327

KEVIN HEALEY
Kevin@precisionrg.com
856.404.1627

GWEN BAKER
Gwen@precisionrg.com
570.977.3853

BROAD STREET

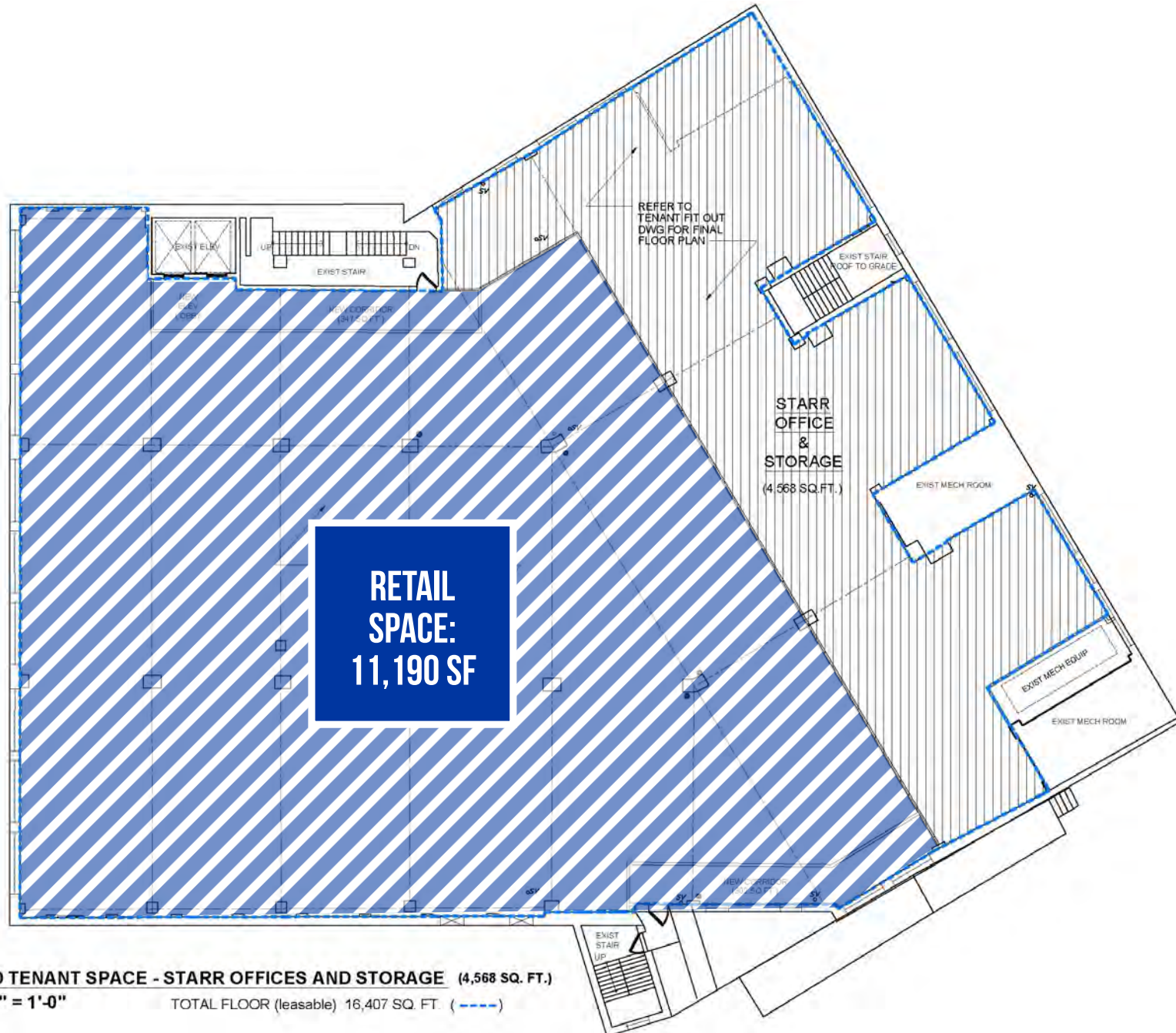

PROPOSED TENANT SPACE - STARR OFFICES AND STORAGE (4,568 SQ. FT.)

SCALE: $\frac{1}{16}" = 1'-0"$

TOTAL FLOOR (leasable) 16,407 SQ. FT. (- - - -)

AREA DEVELOPMENT

SHAUN M. LYONS
Slyons@precisionrg.com
267.707.3347

STEVE JEFFRIES
Steve@precisionrg.com
267.707.3327

KEVIN HEALEY
Kevin@precisionrg.com
856.404.1627

GWEN BAKER
Gwen@precisionrg.com
570.977.3853



**BROAD &
SPRING GARDEN
DEVELOPMENT**

144 Residential Units
68,000 +/- SF Office | 87,000 +/- SF Retail



MURAL LOFTS

523 N. Broad St.
25,000 +/- SF Retail | 56 Residential Units



**THE DIVINE
LORRAINE**

669 N. Broad St.
11,00 +/- SF Retail | 121 Renovated Apartments



**METROPOLITAN
OPERA HOUSE**

858 N. Broad St.
20,000 +/- SF Retail | Restoration of Original Facade



NEIGHBORHOOD AERIAL

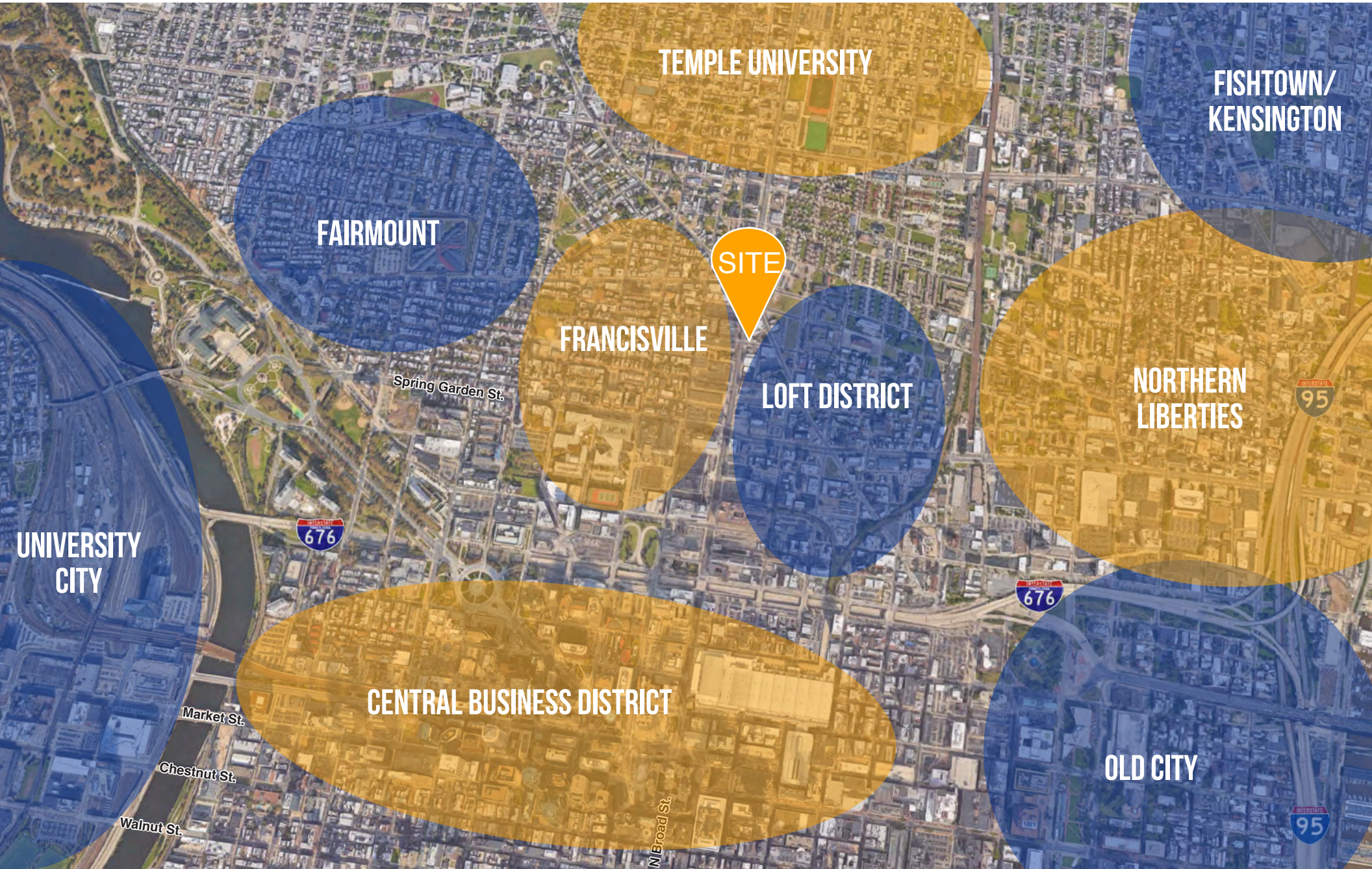

Information contained herein is from sourced deemed reliable, but no warranty or representation is made as to the accuracy thereof and the foregoing is subject to errors, omissions, or change without notice.