

CENTURY 21 PLAZA

1350-1390 S. Colorado Blvd., Denver, CO 80222

FOR LEASE



PROPERTY DESCRIPTION

Most desirable retail location in metropolitan Denver
For more information visit: www.century21denver.com

PROPERTY HIGHLIGHTS

- Only one space available - 1,779 SF
- Estimated 2019 NNN charges: \$15.88/SF
- Call for lease rate
- Winner of the Star Award from RMSCA for New Construction, Design, and Aesthetics
- Strong daily traffic counts - 70,000+ vpd
- Easy access to Cherry Creek, I-25, bus stops at Louisiana, Florida, and Arkansas
- Light rail station 1 mile away
- Access from full movement signalized intersections at Arkansas and Louisiana
- Visibility along S. Colorado Blvd. with excellent monument signage on S. Colorado Blvd.
- Close proximity to some of Denver's finest neighborhoods including Hilltop, Crestmoor, Belcaro, Bonnie Brae, Polo Club, Cherry Creek North and Observatory Park
- Join Sprint, Hot Tips Nail Salon, Thai Pot Cafe, Sleep Nation, Rubio's, Xfinity, Jersey Mike's, Anytime Fitness, Dantanna's Pizzeria, We Salon, and Broken Rice

OFFERING SUMMARY

Lot Size:	1.17 Acres
Improvements:	32,084 SF
Parking Ratio:	4.31 spaces/1,000 SF (138 spaces)
Available SF:	1,779 SF
Lease Rate:	Please call

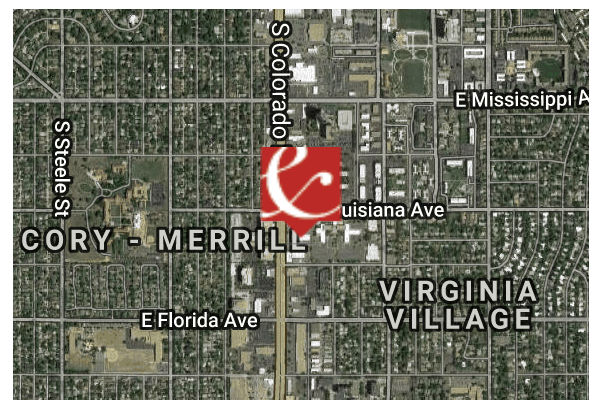

DOUG ANTONOFF

Antonoff & Co.
303.454.5417
doug@antonoff.com

Antonoff & Co. Brokerage, Inc.

Antonoff & Co. Brokerage, Inc.



The information above was obtained from sources we deem reliable; however, no warranty or representation, expressed or implied, is made as to the accuracy of the information contained herein. Any reliance on this information is solely at your own risk.

CENTURY 21 PLAZA

1350-1390 S. Colorado Blvd., Denver, CO 80222

FOR LEASE



DOUG ANTONOFF

Antonoff & Co.
303.454.5417
doug@antonoff.com

Antonoff & Co. Brokerage, Inc.

Antonoff & Co. Brokerage, Inc.



The information above was obtained from sources we deem reliable; however, no warranty or representation, expressed or implied, is made as to the accuracy of the information contained herein. Any reliance on this information is solely at your own risk.

CENTURY 21 PLAZA

1350-1390 S. Colorado Blvd., Denver, CO 80222

FOR LEASE

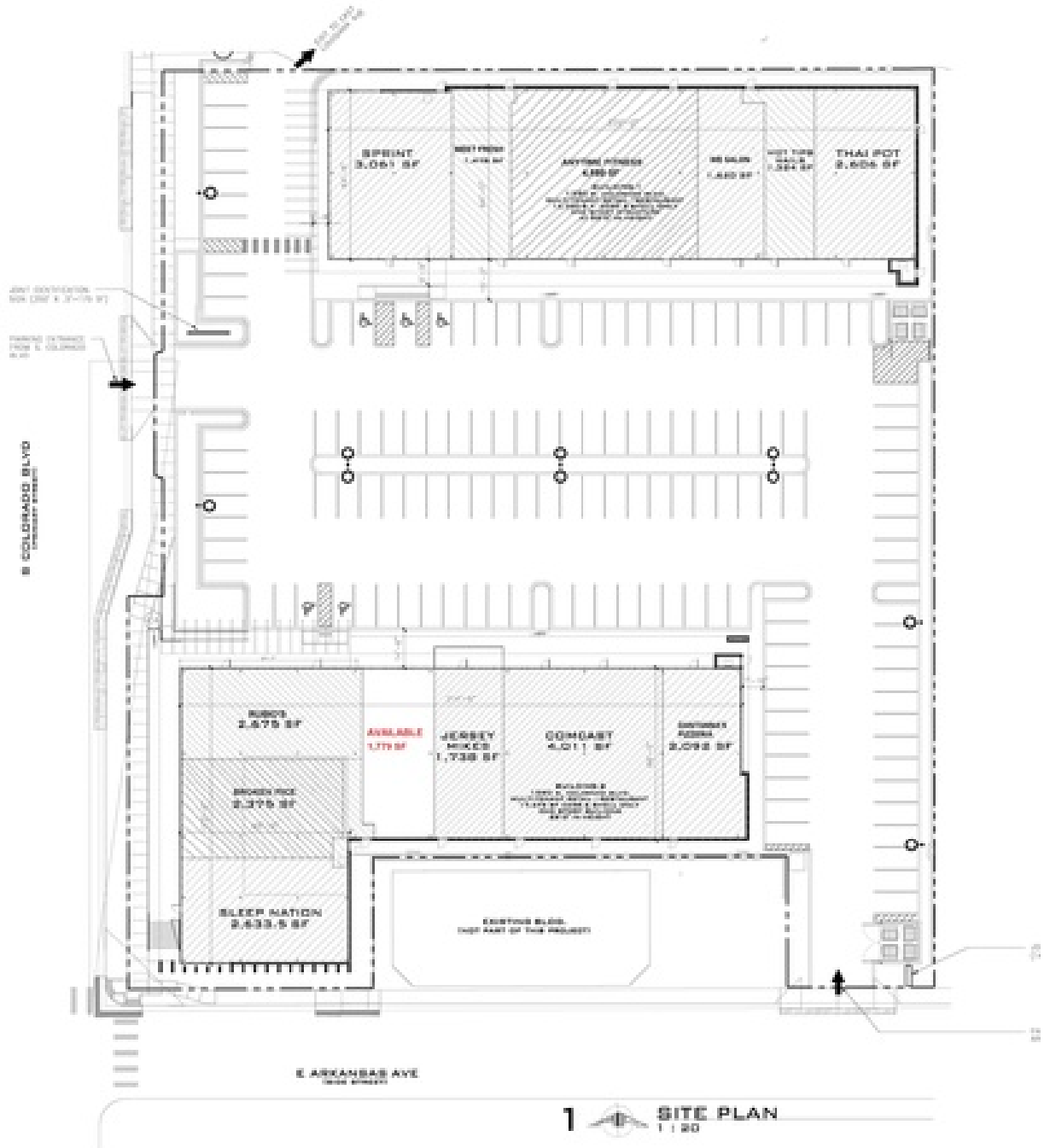

DOUG ANTONOFF

Antonoff & Co.
303.454.5417
doug@antonoff.com

Antonoff & Co. Brokerage, Inc.

Antonoff & Co. Brokerage, Inc.



The information above was obtained from sources we deem reliable; however, no warranty or representation, expressed or implied, is made as to the accuracy of the information contained herein. Any reliance on this information is solely at your own risk.

CENTURY 21 PLAZA

1350-1390 S. Colorado Blvd., Denver, CO 80222

FOR LEASE



DOUG ANTONOFF

Antonoff & Co.

Antonoff & Co. Brokerage, Inc.

Antonoff & Co. Brokerage, Inc.

303.454.5417

doug@antonoff.com

ANTONOFF
& CO.

The information above was obtained from sources we deem reliable; however, no warranty or representation, expressed or implied, is made as to the accuracy of the information contained herein. Any reliance on this information is solely at your own risk.

Additional Photos

Antonoff & Co. | Denver, CO 80202 | 1528 Wazee Street | 303.623.0200 | antonoff.com

CENTURY 21 PLAZA

1350-1390 S. Colorado Blvd., Denver, CO 80222

FOR LEASE



DOUG ANTONOFF

Antonoff & Co.

303.454.5417

doug@antonoff.com

Antonoff & Co. Brokerage, Inc.

Antonoff & Co. Brokerage, Inc.

ANTONOFF
& CO.

The information above was obtained from sources we deem reliable; however, no warranty or representation, expressed or implied, is made as to the accuracy of the information contained herein. Any reliance on this information is solely at your own risk.

Additional Photos

Antonoff & Co. | Denver, CO 80202 | 1528 Wazee Street | 303.623.0200 | antonoff.com