

FOR SALE/BUILD TO SUIT

UP TO 10,000 SF BUILDING PAD SITE

9002 Brook Rd | Glen Allen, VA 23060



S.L. NUSBAUM
REALTY CO.



EMMA WILL

Associate

C. 804.821.9042

O. 804.508.7283

ewill@slnusbaum.com

SARAH SADLER

Senior Associate

C. 804.277.6468

O. 804.533.5390

ssadler@slnusbaum.com

ANDREW THACKER

Vice President

C. 804.357.6075

O. 804.320.7600

athacker@slnusbaum.com

NATHAN SHOR

Senior Vice President | Partner

C. 804.539.7404

O. 804.944.2399

nshor@slnusbaum.com

PROUD PARTNER

XTEAM

RETAIL ADVISORS

PROPERTY SUMMARY

UP TO 10,000 SF BUILDING PAD SITE

9002 Brook Rd | Glen Allen, VA 23060



S.L. NUSBAUM
REALTY CO.

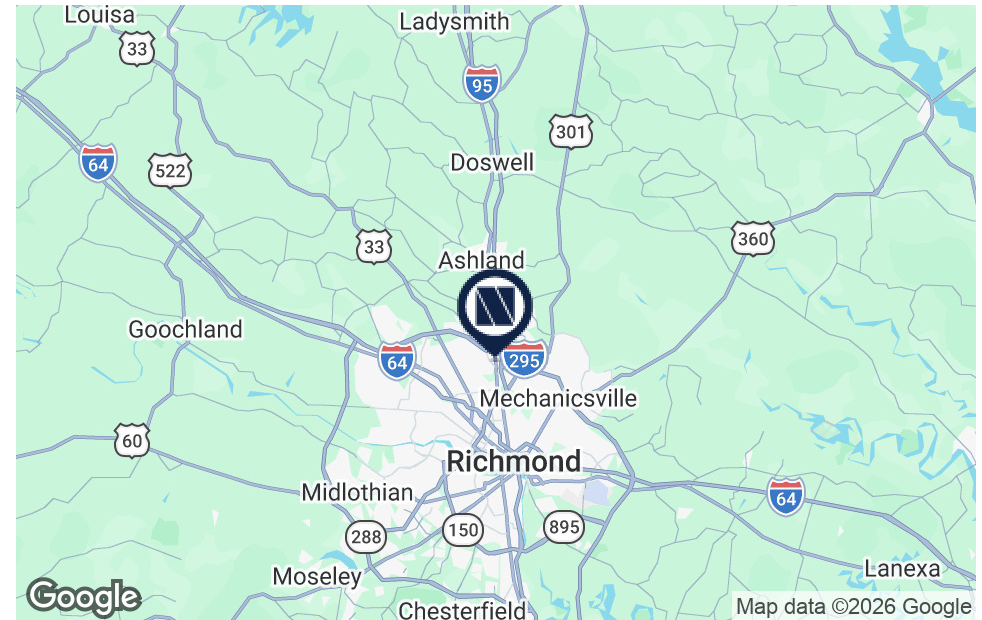
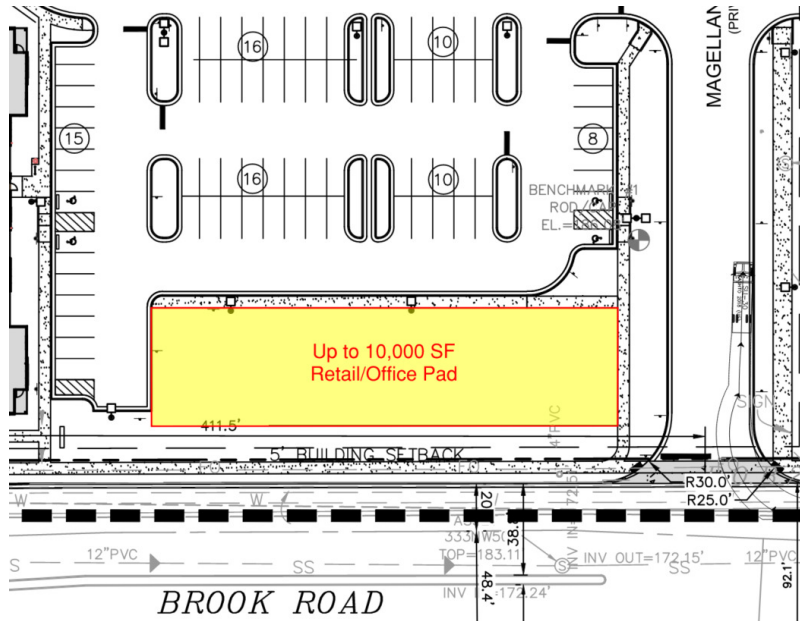

OFFERING SUMMARY

Sale Price:	Contact Agents
Building Size:	Up to 10,000 SF with existing parking field
Zoning:	Mixed Use R-6C

[Level Green - Learn More](#)

[Henrico Sports & Events Center](#)

DEMOGRAPHICS	1 MILE	3 MILES	5 MILES
Total Population	6,419	52,161	153,047
Daytime Population	6,432	52,609	178,865
Total Households	2,629	21,555	63,662
Average HH Income	\$97,407	\$103,109	\$114,731

PROPERTY OVERVIEW

Pad site with existing parking field in new mixed-use development in Glen Allen. Strategically located along US Rt 1/Brook Rd, with excellent visibility and accessibility to the Greater Richmond MSA.

PROPERTY HIGHLIGHTS

- Part of The Brook - 310 residential units (apartments & townhomes)
- Easy access, ±0.7 miles to I-295 & 1.2 miles to I-95 Exit 86 (Atlee/Elmont)
- As part of its comprehensive plans, Henrico County is extending Magellan Parkway across I-95 to Level Green Development.
- The Brook is situated at a major intersection with direct access to the new ecodistrict.
- The site is located in a rapid growth area for high density residential

CONCEPTUAL RENDERING

UP TO 10,000 SF BUILDING PAD SITE

9002 Brook Rd | Glen Allen, VA 23060



S.L. NUSBAUM
REALTY CO.

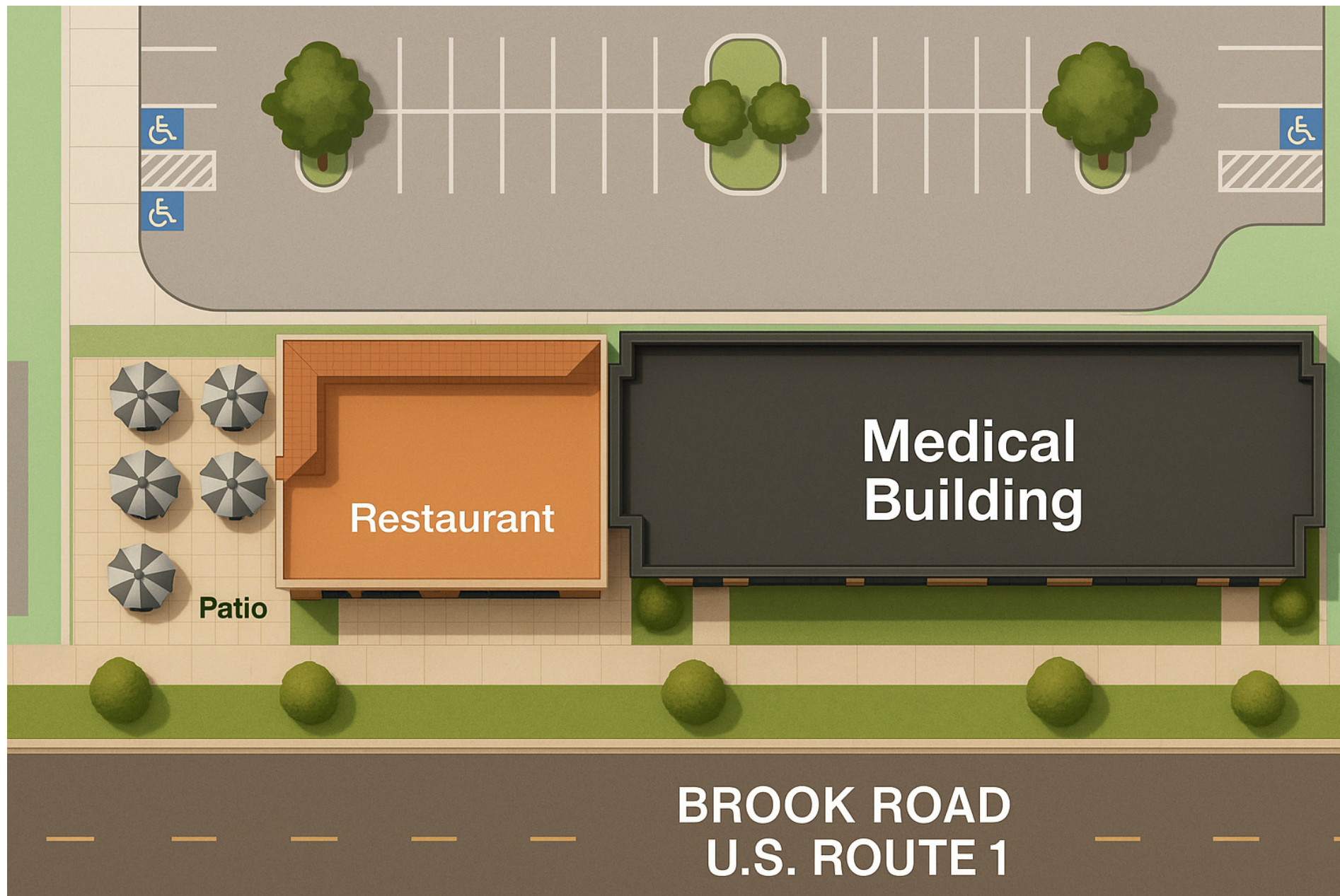

TRANSFORMING RT 1/I-95 CORRIDOR

UP TO 10,000 SF BUILDING PAD SITE

9002 Brook Rd | Glen Allen, VA 23060



S.L. NUSBAUM
REALTY CO.

Level Green - the new residential community taking shape on the former Scott Farm property near the Best Products redevelopment, is moving forward with its first phase of homes. The 111-acre project represents a \$400 million investment by Markel Eagle Partners, bringing 880 for-sale residences to the area. With new road connections, a planned linear park, and close proximity to the future arena-anchored mixed-use district, Level Green is positioned to become one of Henrico's most dynamic new neighborhoods.

Retreat at One - Across the street from the site, Stanley Martin is under construction on a new 606-unit for-sale community. This development has a mix of two-story condos and townhomes as well as a commercial pad.

Virginia Center Commons - A 775,000 SF mall is actively being redeveloped to include a new sports complex, convention center, retail, 525 townhomes and 830 apartments.

River Mill - The original 250-acre project includes 300 townhomes, 285 apartments, 50 single-family homes and 400 zero-lot-line homes. They have recently expanded the development to add an additional 57 townhomes.



TRADE AREA

UP TO 10,000 SF BUILDING PAD SITE
9002 Brook Rd | Glen Allen, VA 23060



S.L. NUSBAUM
REALTY CO.



CONTACT INFORMATION

UP TO 10,000 SF BUILDING PAD SITE
9002 Brook Rd | Glen Allen, VA 23060



S.L. NUSBAUM
REALTY CO.

EMMA WILL

Associate
C. 804.821.9042
O. 804.508.7283
ewill@slnusbaum.com

SARAH SADLER

Senior Associate
C. 804.277.6468
O. 804.533.5390
ssadler@slnusbaum.com

ANDREW THACKER

Vice President
C. 804.357.6075
O. 804.320.7600
athacker@slnusbaum.com

NATHAN SHOR

Senior Vice President | Partner
C. 804.539.7404
O. 804.944.2399
nshor@slnusbaum.com

COMMITMENT. INTEGRITY. EXCELLENCE. SINCE 1906.

Serving the Southeast and Mid-Atlantic region for well over a century, S.L. Nusbaum Realty Co. continues to provide a comprehensive experience for our clients and customers in all aspects of the multifamily and commercial real estate industry.

[CLICK HERE TO LEARN MORE](#)

PROUD PARTNER
XTEAM
RETAIL ADVISORS

[CLICK HERE TO LEARN MORE](#)

DISCLAIMER:

No warranty or representation, expressed or implied, is made to the accuracy or completeness of the information contained herein, and same is submitted subject to errors, omissions, change of price, rental or other conditions, withdrawal without notice, and to any special listing conditions imposed by the property owner(s). As applicable, we make no representation as to the condition of the property (or properties) in question or the property's (or properties') compliance with applicable laws, regulations, and codes.