



195 Breen Street, Golden Square.

6 

Flexible commercial space with strong street presence.

A fantastic opportunity to lease a versatile Commercial 2 Zoned warehouse and office in Golden Square, positioned on the busy Breen Street corridor, just minutes from Bendigo CBD. This property combines excellent street exposure, strong passing trade, and easy access to main roads, in a well-established precinct of commercial, retail, and light industrial businesses.

Featuring

- 573 sqm land, 304 sqm warehouse with mezzanine storage
- Flexible use - currently set up as a supermarket, previously configured for mixed office use
- High clearance roller door
- Solar panels
- Kitchenette and toilet facilities
- On-site parking
- Side and rear yard access
- Prominent industrial area close to Bendigo CBD
- Excellent street exposure and strong passing trade
- Ready for your fit-out

This versatile property offers functional space, high visibility, and convenient access, ideal for a variety of commercial or light industrial uses.

Contact Belle Property Castlemaine for further information.

Please note, this property is being leased as a lease transfer; any

Property information

Property ID	326P9655
Property type	Warehouse
Land size	573.0 sqm
Home size	327.0 sqm

Price

\$675.00 per week, including GST, plus outgoings

Contact

Narelle Waller
Principal

0408 571 131
narelle.waller@belleproperty.com

Ruby Wright
Commercial Assistant

0417 737 660
ruby.wright@belleproperty.com

Disclaimer: Whilst all care has been taken to ensure accuracy in the preparation of the particulars herein, no warranty can be given, and interested parties must rely on their own enquiries. This business is independently owned and operated.

belle
PROPERTY

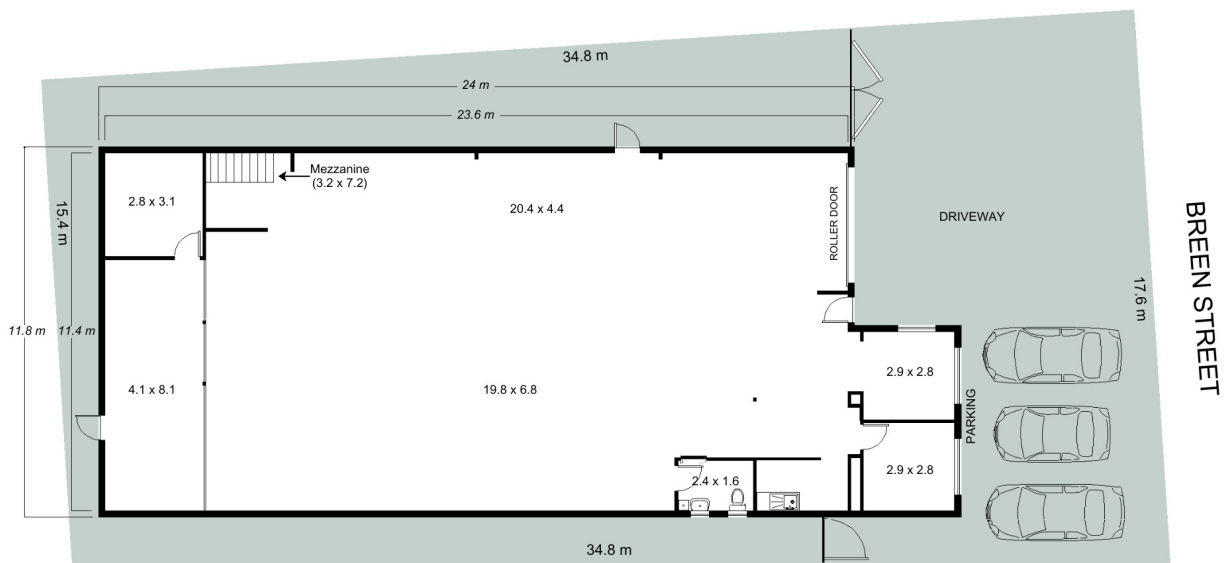

FLOORPLAN & LANDPLAN

195 Breen Street, Golden Square

The site plan and floor plan are not to scale; measurements are indicative and in metres. Plans should not be relied upon. Interested parties should make and rely on their own enquiries.



APPROXIMATE AREAS	
Building Area	304 sqm
Mezzanine Area	23 sqm
Land Area	573 sqm