

1 2 3 4 5 6 7 8 9 10 11 12 13 14 15 16

K  
J  
I  
H  
G  
F  
E  
D  
C  
B  
A

Terms of Use:  
 By using this set of construction drawings the owner agrees to hire a professional to design all elements of the construction details and specifications to satisfy local building codes. Furthermore, these drawings remain the intellectual property of J.B. Kay Construction, LLC, and by using these drawings the owner agrees to these terms of use.

These drawings can only be used for the property listed.

It is the builders responsibility to review all aspects of these drawings prior to construction and report any discrepancies in dimensions and layout to J.B. Kay Construction, LLC prior to proceeding.

The contractor/builder is responsible for all site work drainage and all footing and foundation elevations.

All window and door openings need to be verified in the field.

Stair heights and lengths to be verified in the field by the builder to meet local building codes.

By using these construction drawings the owner agrees to these terms.

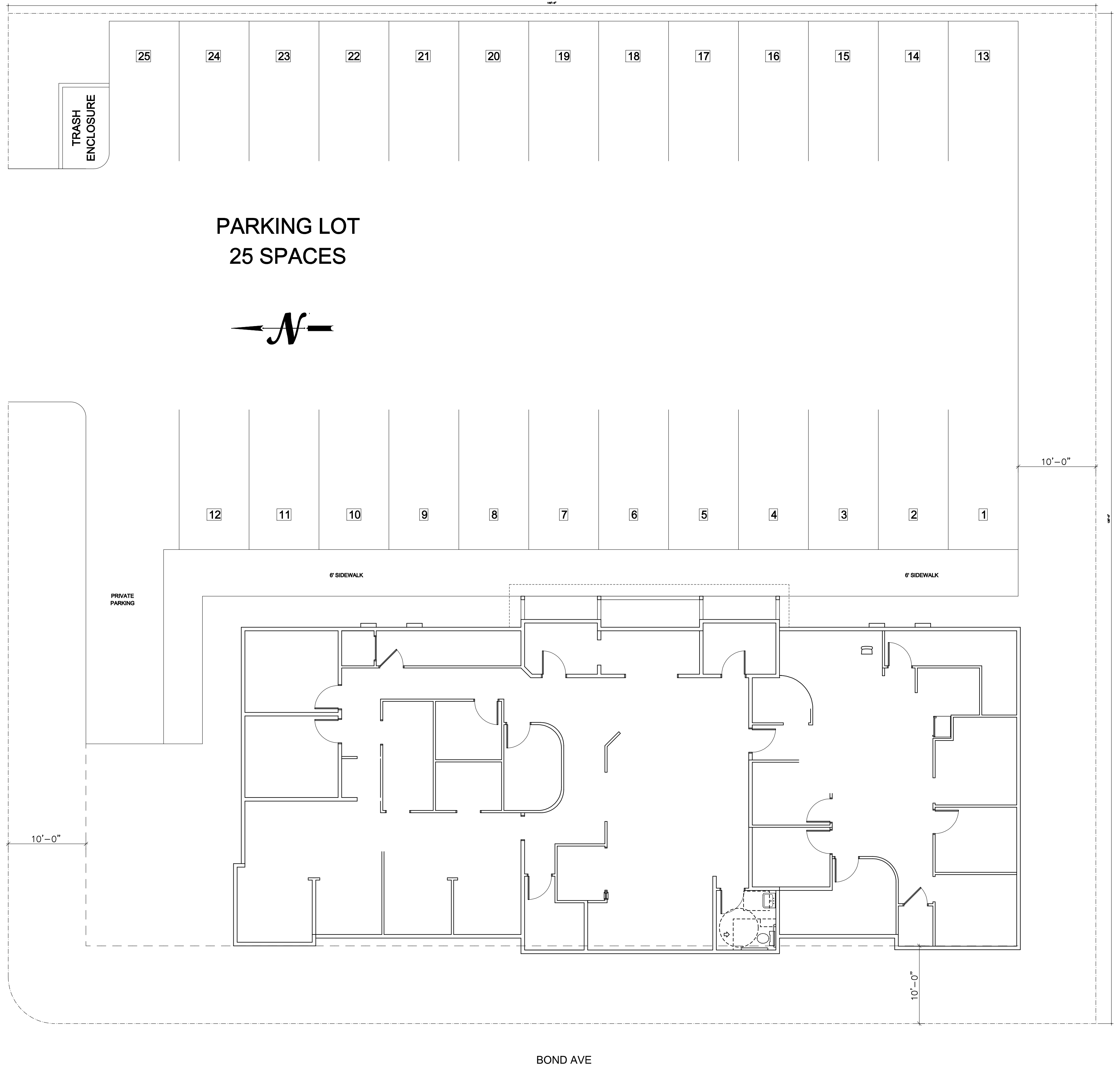

PLOT DATE:  
6/17/2020

SCALES ONLY VALID  
WHEN PRINTED  
ON ARCH D SHEETS

DESIGNER  
JARED

PROJECT LOCATION

**TOOTH TIME 7**

**J. B. KAY CONSTRUCTION**  
 950 Vista Avenue  
 Rexburg, Idaho 83440  
 Phone: (208)716-2374  
 Fax: (208)359-5354  
 www.jbkayconstruction.com

**S1.1**

1 2 3 4 5 6 7 8 9 10 11 12 13 14 15 16