



For Lease

Property Highlights

- Available SF: Warehouse High-Bay: 31,500 SF
Warehouse/Light Assembly/Low-Bay: 6,600 SF
Office 2nd Floor: 6,600 SF
- Ground: 5.324 acres
- Construction: Floor: 6" concrete
Walls: Insulated metal panel
Columns: Circular Steel
- Date of Construction: 1989
- Ceiling Heights: Warehouse High-Bay: 26'9" at the eave, 28'2" at the peak
Warehouse Low-Bay: 9' clear
Office: 7'11" drop ceiling
- Column Spacing: 25' x 50' (on center)
- Power: Supplied by ConEdison; 480/208V, 1200 amp service
- Sprinkler: 100% wet system protected
- Truck Loading Facilities: Four (4) 8' x 8' dock high loading doors with weather seals and manual levelers
- Parking: 34 car parks; additional street parking available
- Zoning: RELIP (Research, Electronic & Light Industrial Park District)

44,700 SF Available

**12 Labriola Court,
Armonk, NY**

James Panczykowski

Managing Director

+1 203 705 2248

james.panczykowski@am.jll.com



Site Plan

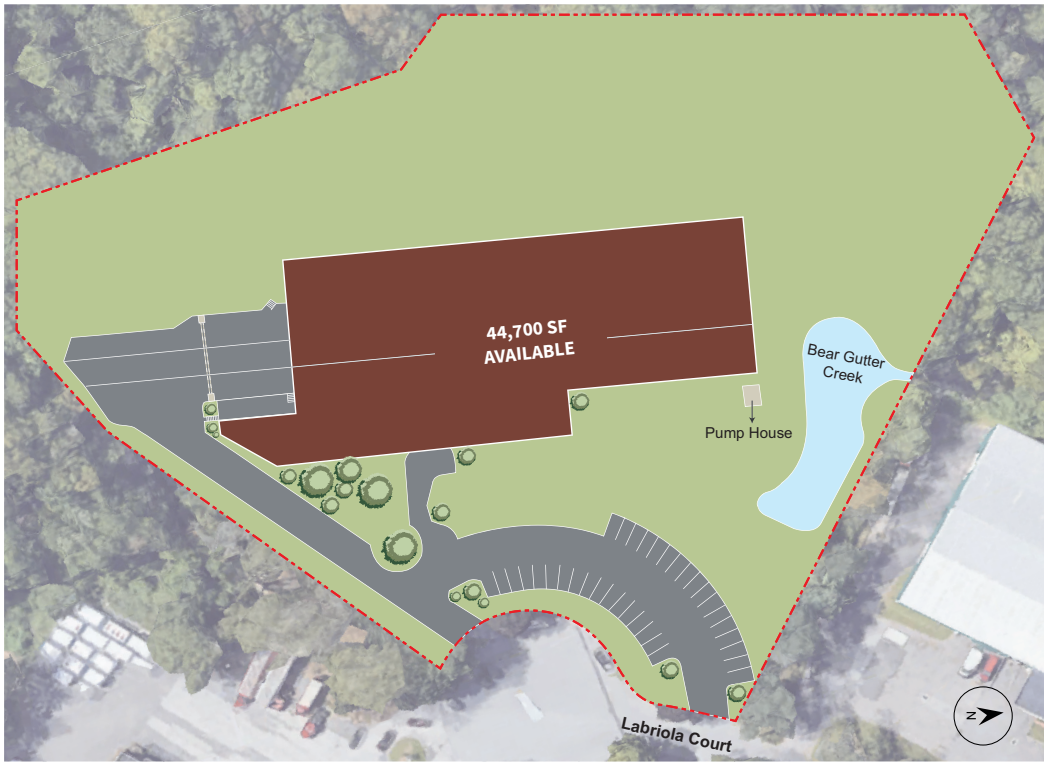

Location Highlights

The property is ideally located in Westchester County, New York and less than 1.5 miles from I-684 and immediately off Route 22.

0.2 Miles
from Route 22

1.5 Miles
from I-684

4.1 Miles
from Westchester
County Airport

7.6 Miles
from I-287

12.2 Miles
from I-95



Although information has been obtained from sources deemed reliable, neither Owner nor JLL makes any guarantees, warranties or representations, express or implied, as to the completeness or accuracy as to the information contained herein. Any projections, opinions, assumptions or estimates used are for example only. There may be differences between projected and actual results, and those differences may be material. The Property may be withdrawn without notice. Neither Owner nor JLL accepts any liability for any loss or damage suffered by any party resulting from reliance on this information. If the recipient of this information has signed a confidentiality agreement regarding this matter, this information is subject to the terms of that agreement. ©2020 Jones Lang LaSalle IP, Inc. All rights reserved.

