

# For Lease in Prince Frederick Town Center • Entry District

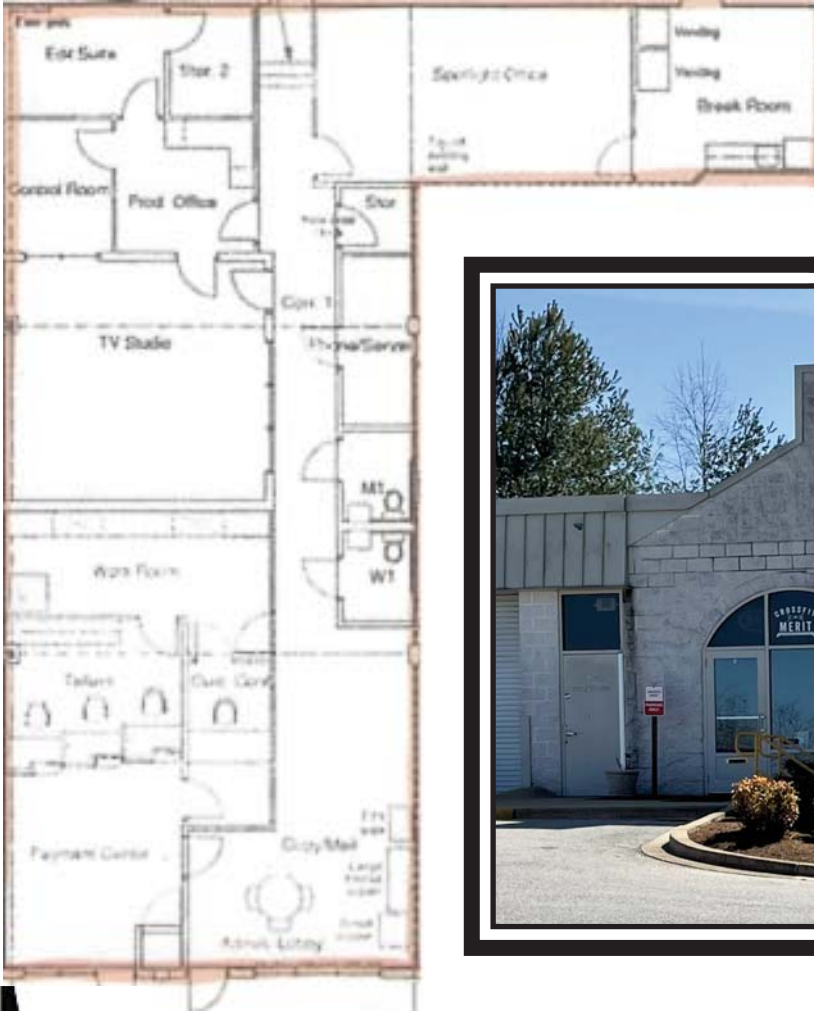

*Office/Studio space for lease on Prince Frederick Boulevard*



## **Suite D**

2,933 sq. ft.

\$3,911/month

Office with recording studio build out



*Could it be the right place for you?*

To schedule a site visit call

Calvert Commercial Real Estate, Inc.

**410 535-0022**

[www.CalvertCommercial.com](http://www.CalvertCommercial.com)



*We will find the perfect place for your business!*



# Demographic Report

5 miles radius around 1030 Prince Frederick Blvd  
 1030 Prince Frederick Blvd, Prince Frederick, Maryland 20678 - Calvert County

Population	2021	2026
	TOTAL	TOTAL
Population	24,107	25,409

Age Distribution	2021		2026	
	TOTAL	%	TOTAL	%
0-4	1,168	4.85	1,252	4.93
5-9	1,495	6.2	1,421	5.59
10-19	3,299	13.68	3,260	12.83
20-29	2,905	12.05	3,195	12.57
30-39	2,828	11.73	2,888	11.37
40-49	2,972	12.33	3,114	12.26
50-59	3,791	15.73	3,426	13.48
60-64	1,760	7.3	1,851	7.28
65+	3,889	16.13	5,002	19.69
Average Median Age	40.342	0.17	41.375	0.16

Sex	2021		2026	
	TOTAL	%	TOTAL	%
Male	12,052	49.99	12,682	49.91
Female	12,055	50.01	12,727	50.09

**Ethnicity Distribution**

	2021		2026	
	TOTAL	%	TOTAL	%
White (non-hispanic)	17,450	72.39	18,300	72.02
Black (non-hispanic)	3,697	15.34	3,793	14.93
American Indian (non-hispanic)	82	0.34	91	0.36
Asian (non-hispanic)	624	2.59	700	2.75
Pacific Islander (non-hispanic)	6	0.02	7	0.03
Other (non-hispanic)	7	0.03	7	0.03
Multirace (non-hispanic)	816	3.38	912	3.59
Hispanic	1,427	5.92	1,600	6.3

**Race Distribution**

	2021		2026	
	TOTAL	%	TOTAL	%
White	18,238	75.65	19,177	75.47
Black	3,916	16.24	4,037	15.89
American Indian	102	0.42	114	0.45
Asian	658	2.73	741	2.92
Pacific Islander	7	0.03	9	0.04
Other	218	0.9	245	0.96
Multirace	968	4.02	1,086	4.27

**Total Households**

	2021		2026	
	TOTAL	%	TOTAL	%
Households	8,175	56.28	8,759	56.67
Families	6,351	77.69	6,697	76.46

**Average Household Income**

	2021		2026	
	TOTAL		TOTAL	
Average Household Income	133,375.012		149,285.716	

**Household Income Distribution**

	2021		2026	
	TOTAL	%	TOTAL	%
<\$10 K	178	2.18	167	1.91
\$10-\$20K	314	3.84	261	2.98
\$20-\$30K	387	4.73	377	4.3
\$30-\$40K	362	4.43	300	3.43
\$40-\$50K	357	4.37	359	4.1
\$50-\$60K	356	4.35	347	3.96
\$60-\$75K	552	6.75	432	4.93
\$75-\$100K	914	11.18	872	9.96
> \$100K	4,755	58.17	5,644	64.44

**Labor Force Status**

	2021		2026	
	TOTAL	%	TOTAL	%
Labor Force	11,991	n/a	14,010	n/a
Employed	11,061	92.24	13,041	93.08
Unemployed	531	4.43	604	4.31
In Armed Forces	399	n/a	365	n/a
Not In Labor Force	7,453	n/a	6,801	n/a

**Total Number of Housing**

	2021		2026	
	TOTAL	%	TOTAL	%
Total Dwellings	8,537	n/a	9,150	n/a
Owner-Occupied Dwellings	6,675	81.65	7,055	80.55
Renter-Occupied Dwellings	1,500	18.35	1,704	19.45
Housing Units Occupied	8,175	n/a	8,759	n/a

**Education Attainment**

	2021		2026	
	TOTAL	%	TOTAL	%
< Grade 9	252	1.52	270	1.52
Grade 9-12	604	3.64	643	3.61
High School	5,257	31.64	5,633	31.65
Some College	3,746	22.55	4,003	22.5
Assoc Degree	1,408	8.47	1,509	8.48
Bach Degree	2,872	17.29	3,089	17.36
Grad Degree	2,475	14.9	2,648	14.88

**Size of Household**

	2021		2026	
	TOTAL	%	TOTAL	%
1 Person	1,471	17.99	1,700	19.41
2 Person	2,493	30.5	2,693	30.75
3 Person	1,529	18.7	1,608	18.36
4 Person	1,523	18.63	1,567	17.89
5 Person	728	8.91	739	8.44
6+ Person	264	3.23	278	3.17

Data Source: Applied Geographic Solutions 2021