

1 REFLECTED CEILING PLAN
ORIGINAL SCALE: 1/4" = 1'-0"

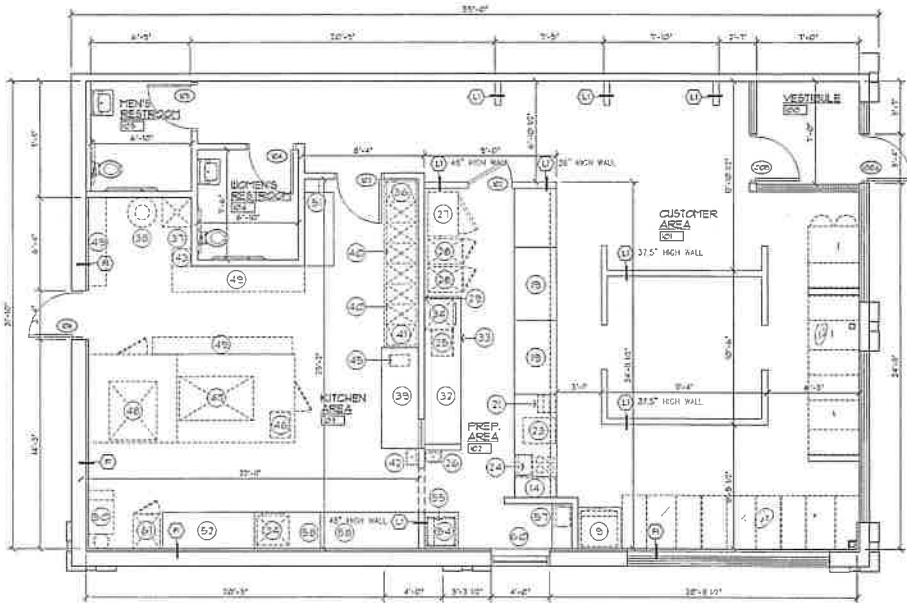

2 FLOOR PLAN
ORIGINAL SCALE: 1/4" = 1'-0"

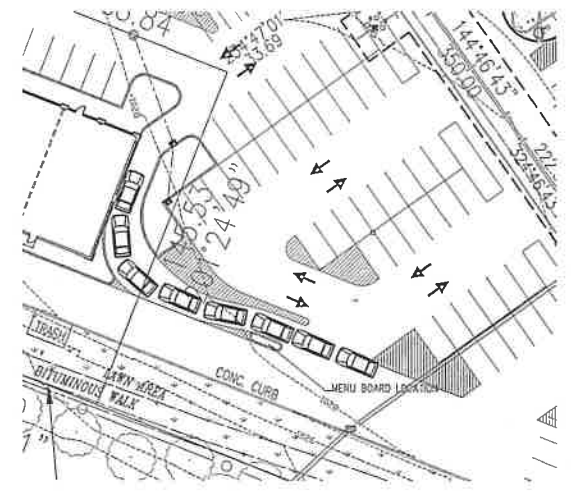

3 PARTIAL SITE PLAN
ORIGINAL SCALE: 1/4" = 1'-0"

RCP NOTES:

1. THIS REFLECTED CEILING PLAN INDICATES LAYOUTS OF FIXTURES ONLY. THIS PLAN TO BE USED FOR BIDDING PURPOSES ONLY. THE GENERAL AND ELECTRICAL CONTRACTORS SHALL VERIFY FINAL QUANTITIES, LOCATIONS AND SCHEDULING REQUIREMENTS OF ALL LIGHT FIXTURES WITH THE OWNER PRIOR TO CONSTRUCTION. THIS CEILING PLAN SHALL NOT RELIEVE THE ELECTRICAL CONTRACTOR FROM COMPLYING WITH ALL LOCAL, BUILDING CODES AND REGULATIONS.
2. CONTRACTORS SHALL VERIFY ALL SITE CONDITIONS PRIOR TO ANY WORK PROCEEDING.
3. HVAC DIFFUSER LOCATIONS TO BE ESTABLISHED BY THE HVAC CONTRACTOR.
4. CEILING AREA NOTED AS 'FUTURE' TO BE PRICED UNDER BASE BID, ACTUAL HEIGHTS AND/OR LIGHTING LAYOUT MAY VARY.

REFLECTED CEILING PLAN KEY:

- EUROSTONE DECORATIVE MOUNTAIN-LE DROPP-IN PANEL
- VINYL DROPP-IN
- ACCOUSTICAL DROPP-IN
- 2'x2' RECESSED FLUORESCENT FIXTURE
- 2'x2' RECESSED FLUORESCENT FIXTURE W/ PARABOLIC LENS
- 4' FLUORESCENT STRIP LIGHT
- 3"X4" SURFACE MOUNTED LIGHT FIXTURE W/ SEPARATE EXHAUST FAN
- DOORLIGHT (OUTDOOR AREA)
- PENDANT LIGHT
- CEILING FAN

GENERAL NOTES:

1. ALL WORK SHALL BE PERFORMED IN COMPLIANCE WITH ALL REQUIREMENTS OF THE OWNER. EACH TRADE CONTRACTOR SHALL BE RESPONSIBLE FOR OBTAINING, MAINTAINING AND SUPERVISING ALL SAFETY PROCEDURES, PRECAUTIONS AND PROGRAMS IN CONNECTION WITH THEIR WORK.
2. THE GENERAL CONTRACTOR SHALL FILE FOR AND OBTAIN ALL NECD PERMITS, LETTERS OF SATISFACTORY COMPLETION AND CERTIFICATES OF OCCUPANCY FROM THE LOCAL BUSINESS OFFICIAL.
3. ALL EQUIPMENT SHOWN AS DAMAGED IS BY THE OWNER. ELECTRICAL CONTRACTOR TO VERIFY POWER REQUIREMENTS FOR OWNER'S EQUIPMENT. MECHANICAL CONTRACTOR TO VERIFY FLOWING AND HVAC REQUIREMENTS OF OWNER'S EQUIP.
4. REFER TO THE MECHANICAL ELECTRICAL DRAWINGS FOR ADDITIONAL WORK NOTED UNDER THIS CONTRACT.
5. THE GENERAL CONTRACTOR AND/OR MECHANICAL CONTRACTOR SHALL COORDINATE ALL MECHANICAL WORK WITH THE OWNER'S REPRESENTATIVE AND ALL OTHER TRADES.
6. THE GENERAL CONTRACTOR AND/OR ELECTRICAL CONTRACTOR SHALL COORDINATE ALL ELECTRICAL WORK WITH THE OWNER'S REPRESENTATIVE AND ALL OTHER TRADES.
7. REFER TO THE STRUCTURAL DESIGN SHEETS FOR DETAILED INFORMATION ON THE STRUCTURAL DESIGN OF BUILDING. THE STRUCTURAL DRAWINGS SHALL TAKE PRECEDENCE OVER ANY STRUCTURAL INFORMATION NOTED ON THE ARCHITECTURAL DRAWINGS. CONTRACTOR SHALL NOTIFY ARCHITECT OF DISCREPANCIES BETWEEN ARCHITECTURAL / STRUCTURAL.

PLAN NOTES:

1. REFER TO ORIGINAL MECHANICAL DRAWINGS FOR PLAN NOTES - NOTE DIMENSIONS SHALL CORRESPOND WITH ORIGINAL FURNITURE AND EQUIPMENT LEGEND.
2. ALL FURNITURES AND EQUIPMENT SHOWN DAMAGED TO BE PROVIDED BY OTHERS.
3. ALL INTERIOR PARTITION WALLS TO BE WALL TYPE 'D' UNLESS NOTED OTHERWISE. SEE WALL TYPE SCHEDULE ON SHEET 010.
4. ALL INTERIOR FINISHES ARE SPECIFIED AND LISTED ON ORIGINAL RIBBAY DRAWINGS. SEE RIBBAY DRAWINGS FOR ALL MATERIAL AND FINISH SPECIFICATIONS.



ENGINEERS • ARCHITECTS
SURVEYORS • PLANNERS
LANDSCAPE ARCHITECTS
717 THIRD ANTIHUE SCULPIN
ROCHESTER, MINNESOTA
567-286-1000
FAX 567-286-1001
DIAL INFO@YCA.CY

I HEREBY CERTIFY THAT THIS SPECIFICATION SET WAS PREPARED BY ME OR BY AN EMPLOYEE OF MY FIRM THAT I AM A CIVILLY LICENSED ARCHITECT UNDER THE LAWS OF THE STATE OF MINNESOTA.
CHARLOTTE M. COLBY
NUMBER 15-15
NUMBER

SUBWAY
NORTH BROADWAY MALL
ROCHESTER, MINNESOTA

PROJECT NUMBER	
COMPUTER FILE	15-15 CD 01-01
DATE	11-15
DRAWN BY	
CHECKED BY	
SYNCHRON HISTORY	
SHEET NUMBER	

A