

MARCHBURN DRIVE, PA32SJ

FROM
£450/month

ONLINE LIGHTYEAR

GLASGOW AIRPORT BUSINESS PARK

inospace
www.inospace.com



inospace
LIGHTYEAR





UPGRADE TO



Business Class

You know you've arrived when you step into the uplifting triple volume entrance of inospace Lightyear at Glasgow Airport Business Park with its floor to ceiling windows, sleek decor and elegant finishes. You're personally greeted by the friendly, helpful Community Manager as you pass Reception and head for the lifts.

With a prime location six minutes walk from Glasgow Airport, this exclusive, light-filled complex now offers airy, modern and spacious office suites. The stylish suites are curtained in glass, air-conditioned throughout, and designed for optimal comfort and impeccable class.

The office suites at Lightyear are powered by a shared, state of the art Business Hub with three bookable high-spec meeting rooms that come fully kitted with all the communications technology a high flying business may need for global communications and local presentations.

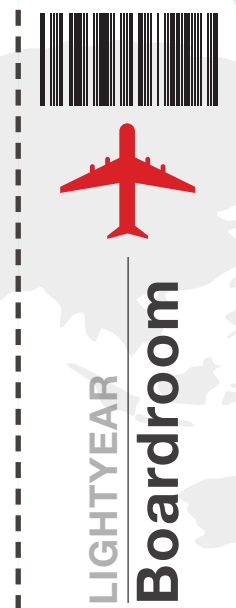
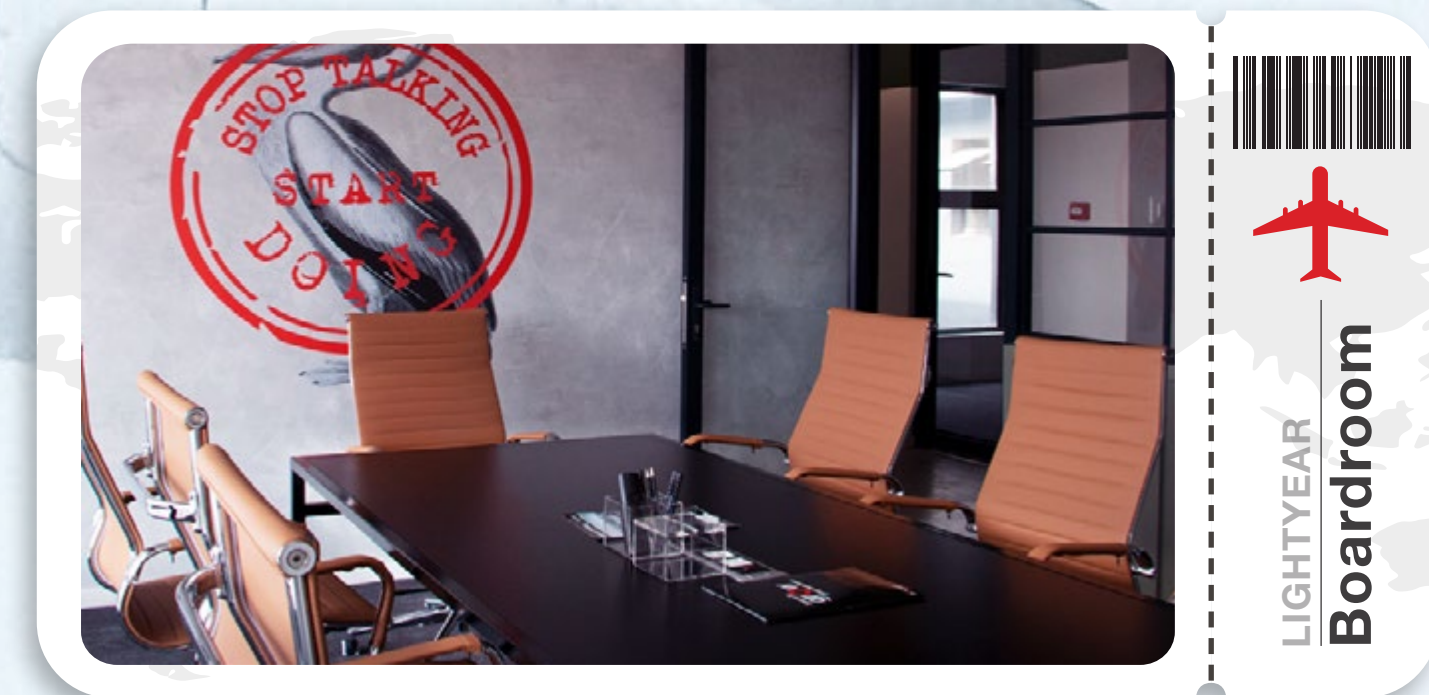
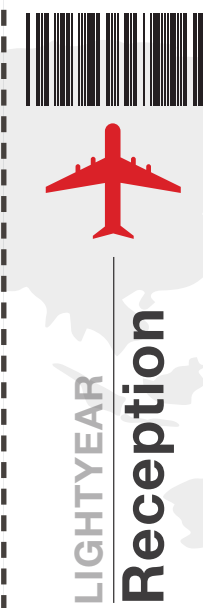
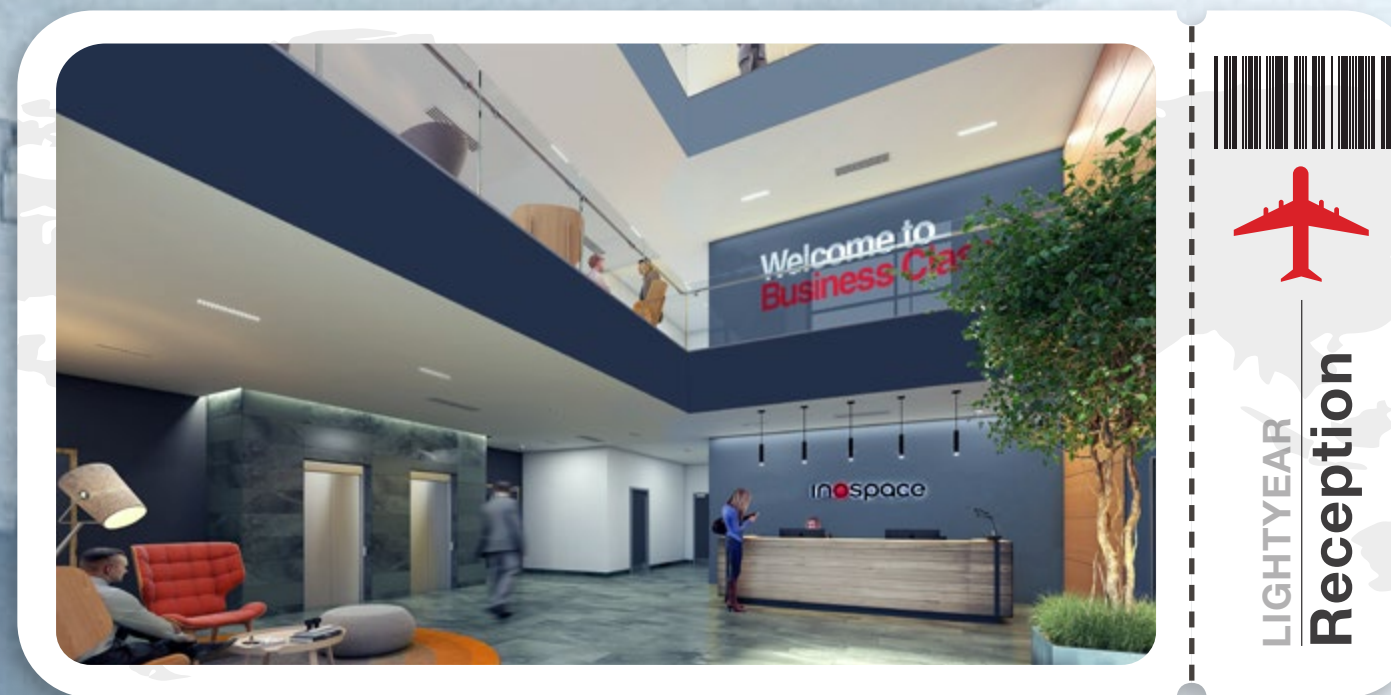



The Area

ALL PATHS LEAD TO LIGHTYEAR

Located at an international airport means that you aren't only on all global and continental flight paths, you're also at the hub of a modern, integrated transport network covering train, bus and car systems.

Since it's a quick, easy commute to Glasgow City Centre, you can have all the benefits of a central urban capital, but at a fraction of the monthly cost, and with fewer traffic and parking issues.

Another advantage of being so close to an airport is that you, your colleagues and your clients can choose from three neighbouring international hotel brands with their restaurant and entertainment options. There's also an upmarket David Lloyd Health Club nearby, as well as a convenient shopping centre and a host of food, drink and leisure venues.

Glasgow Airport was opened in 1966 and operates 24 hours a day, 365 days a year. It services 30 airlines, and they fly to over 100 destinations. There are 102,000 air transport movements per year, and the airport processes 9.9 million passengers annually.



DRIVE



BUS

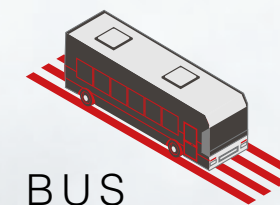

TRAIN



AIR





✈ On the radar

GLASGOW AIRPORT



BRAEHEAD SHOPPING CENTRE



GLASGOW CITY CENTRE



DAVID LLOYD HEALTH CLUB





EXTERIOR
Lightyear



INTERIOR
Office



INTERIOR
Industrial

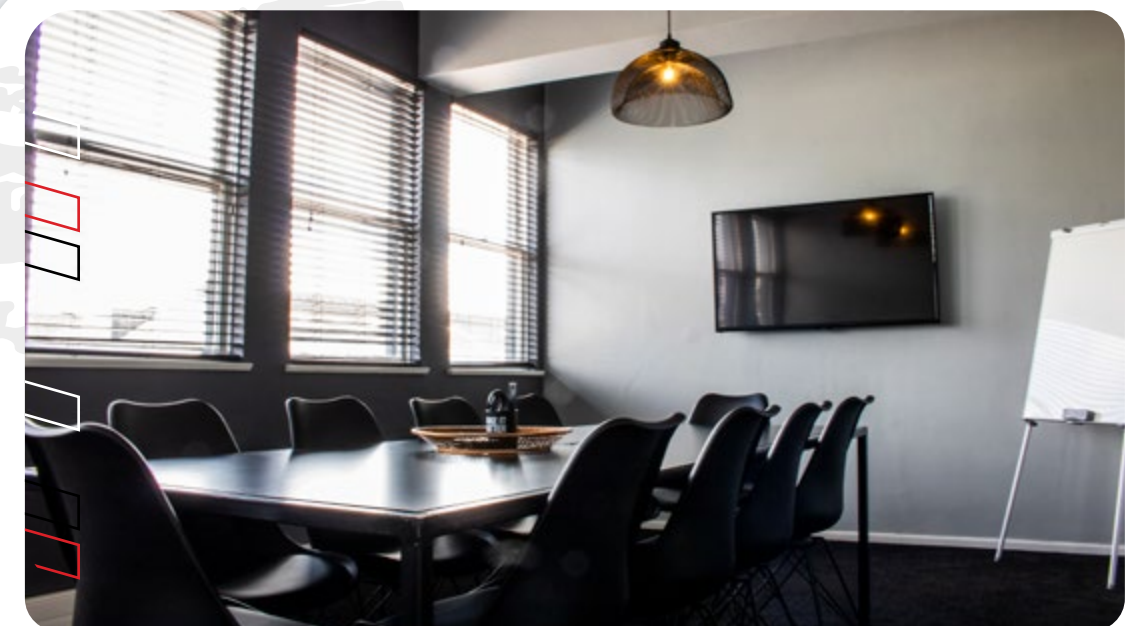

INTERIOR
Office

Spaces

WHERE BUSINESSES TAKE OFF

Lightyear is the perfect space for your business to soar - whether you're a young, streamlined operation reaching for the sky, or a stable company already in cruise mode.

This contemporary complex offers a full deck of plug 'n play technology and service solutions that give you all the benefits, resources and convenience of a heavily invested organisation - without the capital outlay, running costs or operational turbulence.

The flexible range of office suites are designed to comfortably accommodate either 2-40 people each. And they're totally scalable in that you can take up more space as your needs grow, without having to relocate, or wait for your lease period to end.

In addition, there is also 22 000ft² of conventional office space in the building for businesses looking for more independence and larger floor areas. There is also a spacious freestanding industrial unit in the business park that will perfectly suit logistics companies, or those looking for a large warehousing solutions.



FREE



Onboard Services



Meeting Rooms



Bicycle Racks



Park Manager



Mail Collection



Cleaning Service



Dedicated Parking Bays



Equipped Kitchen



Pause Areas



Wifi



Showers



Manned Reception



Service Charge



Utilities



Fibre Connectivity





The Business Hub

The Lightyear Business Hub that services the office suites boasts a fleet of three shared, fully kitted meeting rooms with a relaxing business lounge, private telephone booths, and an equipped kitchen for your snacks and catering needs.

It's your space to engage with colleagues, clients and customers - whether they're next door or across the globe. It's your space to brainstorm, do presentations, communicate, collaborate, host events, relax and have breakaway chats. It's where business happens.

-  **Private meeting rooms**
-  **Lounge and coffee areas**
-  **Modern bathrooms**
-  **Fully equipped kitchen**
-  **Private telephone booths**
-  **Hot desks**

The Business Hub is open 24/7 and is available to all in-circle members. In addition to use of these facilities and services, your membership entitles you to free participation in all community events.





Serviced Business Park

- ✓ Light & airy triple height entrance foyer
- ✓ Fully manned commissionaire reception
- ✓ High-spec wooden and metallic finishes
- ✓ Striking floor to ceiling glazed curtain wall façade
- ✓ Generous floor to ceiling height
- ✓ Recessed high-efficiency LED lighting
- ✓ BMS controlled VRF air conditioning system
- ✓ One monthly invoice
- ✓ Fibre optic and telecom ducts
- ✓ Full metal raised access floors (165mm voids)
- ✓ High quality carpet tiles
- ✓ 3 modern 13 person passenger lifts
- ✓ Male, female & disabled toilet facilities
- ✓ Shower facilities
- ✓ No.40 cycle rack facility
- ✓ Disabled person access
- ✓ 24/7 access
- ✓ CCTV security
- ✓ Visitor car parking
- ✓ Electric Car charging
- ✓ Free business hub access
- ✓ Free in-circle membership
- ✓ Air conditioning system
- ✓ Raised access floors
- ✓ Wifi
- ✓ Natural light





Park Manager

Lightyear has a dedicated Park Manager to table requests, streamline operations, oversee maintenance and ensure all runs smoothly.

Our friendly, well-trained Park Management team are all highly capable, efficient, and happy to help.

At inospace we don't have tenants, we have clients. And our job is to keep them focused on doing what they do best.



Cat Costello

Park Manager





CLUBBING TOGETHER FOR MUTUAL BENEFIT.

As an inospace client you immediately join the inocircle and get all the benefits of a wide and dynamic network of businesses across a range of industries and locations. We're a community.

inocircle is your key to a host of networking events and collaboration opportunities. inocircle also provides a growing range of business benefits and cost-saving opportunities. It's a platform for clients to engage, explore opportunities, share resources, access bulk discounts, collaborate with others, and promote their goods and services.

Office Floor Plans

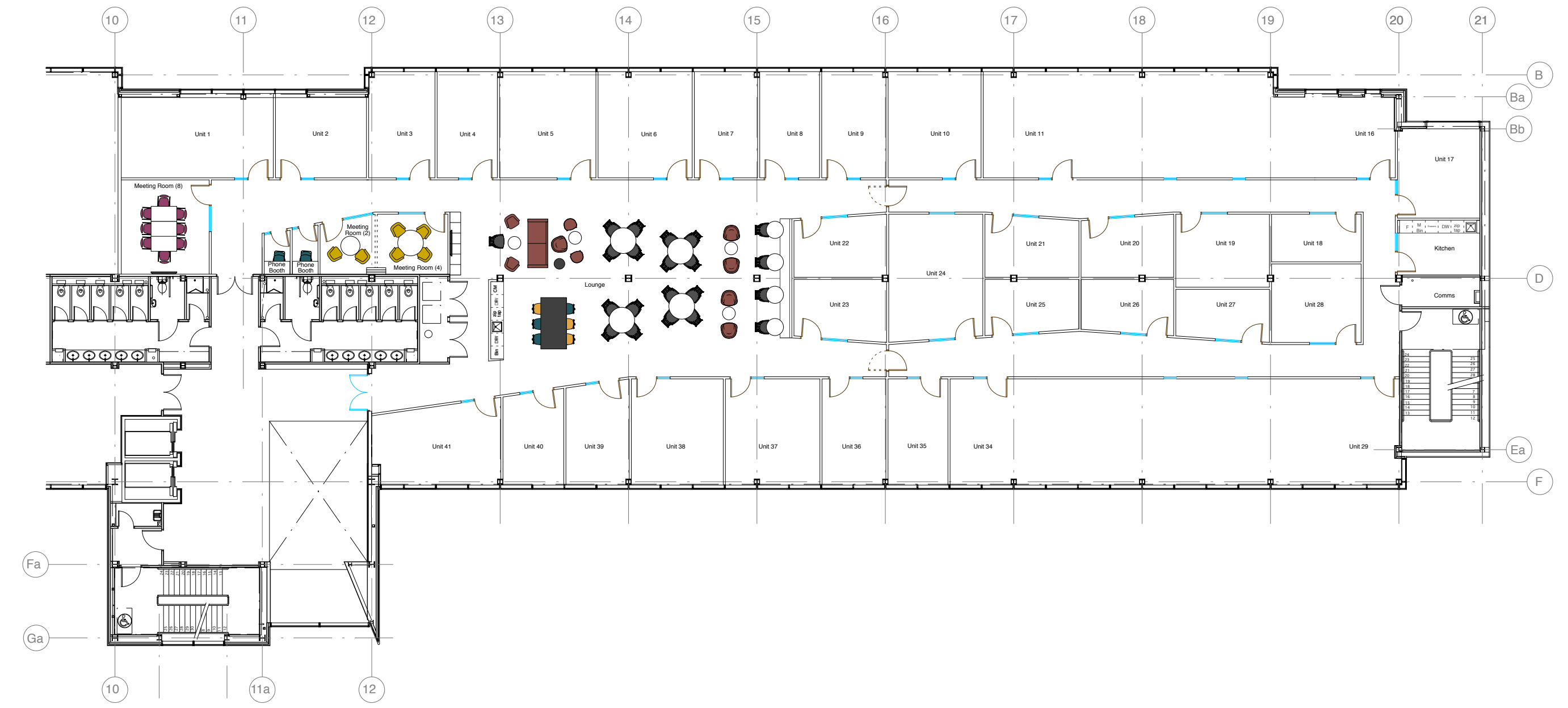

*Live. Work.
Create.
Innovate.*

Now Leasing 📞 0141 212 4905

Industrial | Storage | Office

inospace

www.inospace.com