

KARBANK

REAL ESTATE COMPANY

INDUSTRIAL | OFFICE | COMMERCIAL
BROKERAGE & DEVELOPMENT
ESTABLISHED 1950

8,000 SF
FOR LEASE



2727 CHERRY STREET KANSAS CITY, MO OFFICE AND WAREHOUSE BUILDING

FEATURES

- 1,700 SF office area
- 2 dock-high doors
- 1 drive-in door
- Wet fire sprinkler system
- Ample off street parking
- Available 4/1/2023

BASE RATE:
\$9.00/SF NNN

NET CHARGES (est.):
Taxes: \$0.76/SF
Insurance: \$0.33/SF

For more information
please contact

JOHN DELZER
jd@karbank.com

PAUL FOGEL, SIOR
pf@karbank.com

THE BARNEY BUILDING
2000 SHAWNEE MISSION PARKWAY
SUITE 400
MISSION WOODS, KS 66205

816.221.4488
816.221.4494

KARBANK.COM

Information furnished regarding property is from sources deemed reliable but no warranty or representation is made as to the accuracy thereof and same is submitted subject to errors, omissions, prior sale or lease or withdrawal without notice.



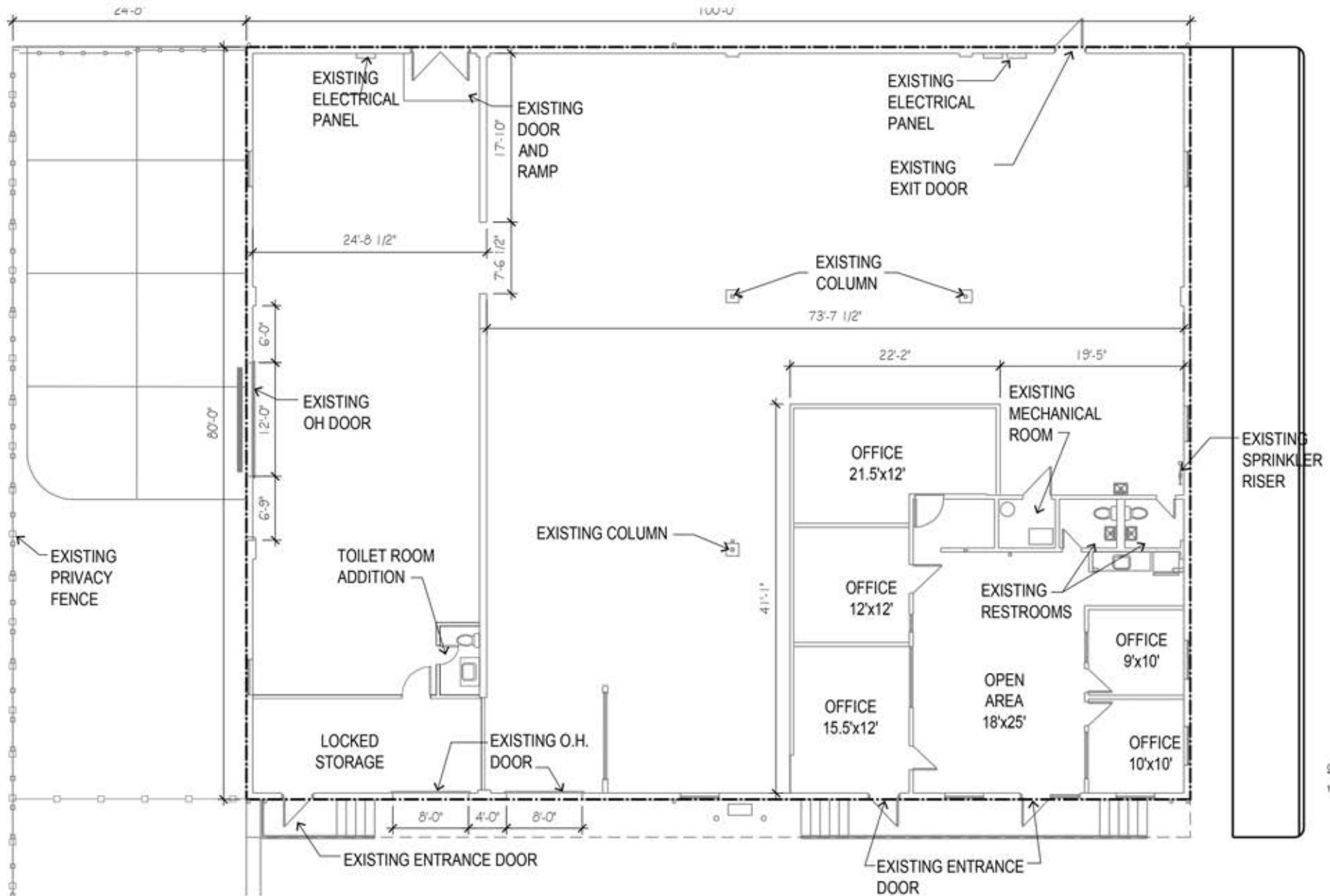

GENE
1.

loverarchitects
KARBANK
REAL ESTATE COMPANY

THE BARNEY BUILDING
2000 SHAWNEE MISSION PARKWAY | SUITE 400
MISSION WOODS, KANSAS 66205
KARBANK.COM

ADDRESS	2727 Cherry Street Kansas City, Missouri
PLAN TYPE	

TOTAL SF	8,000 SF
TOTAL OFFICE SF	1,700 SF

DATE	11-1-2022
SCALE	N/A

SCALE: 3/32" = 1'

N