



1001

For Lease | Class A Warehouse
30,105 SF

1001 Hampton Park Blvd
Capitol Heights, MD 20743

HEITMAN

Features & Floor Plan

1001 Hampton Park Blvd
Capitol Heights, MD 20743

The property features Class A warehouse and distribution space with high-quality construction, modern infrastructure, and enhanced amenities. Outstanding signage potential is available along a well-trafficked route.

Warehouse Space

Available SF	30,105 SF
Office	1,600 SF Brand New Office
Clear Height	24'
Loading Docks	11
Column Spacing	40'x40'
Sprinkler	ESFR

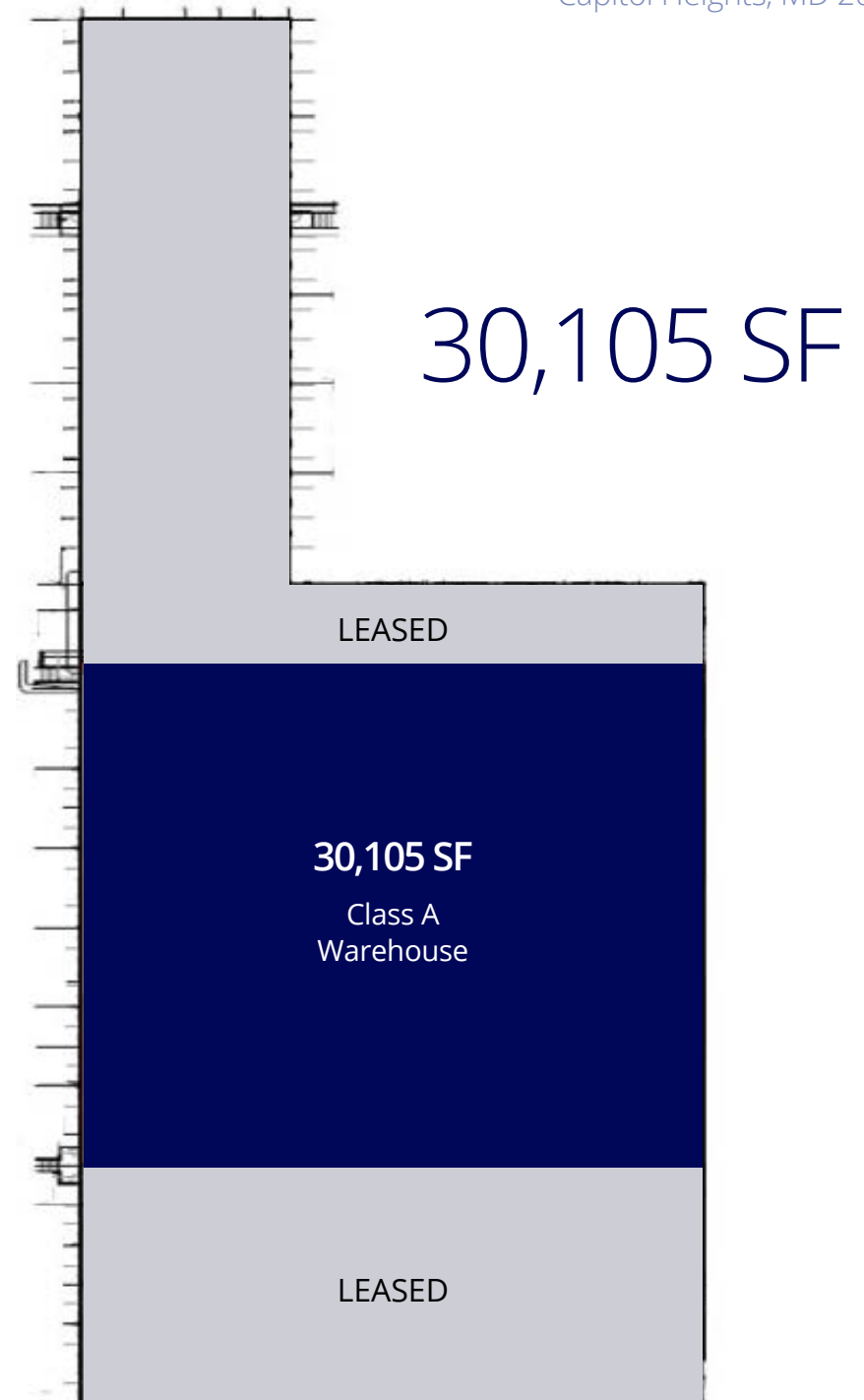

Office Floor Plan

1001 Hampton Park Blvd
Capitol Heights, MD 20743

1,600 SF
Brand New Office

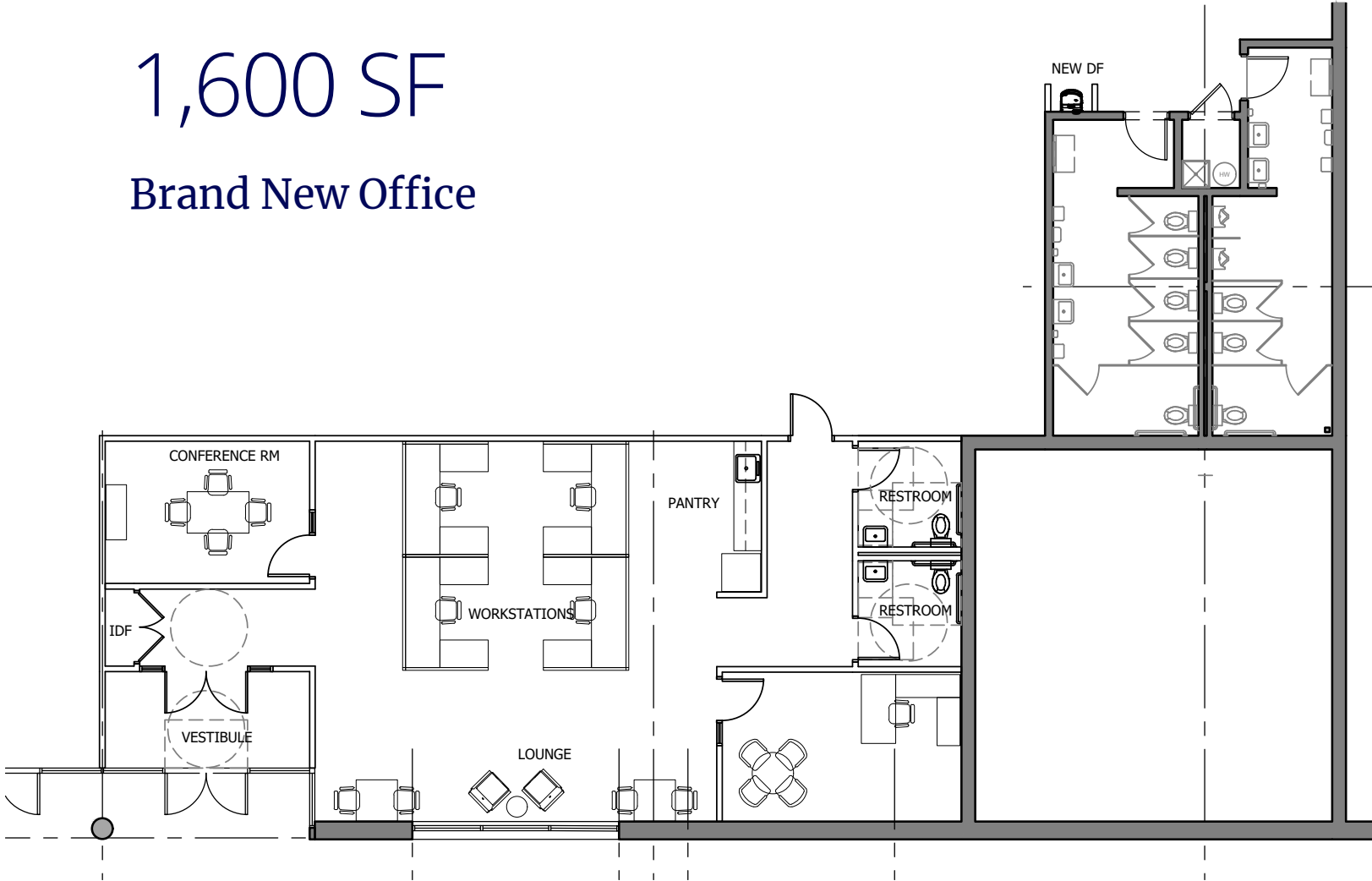

Truck Courts

1001 Hampton Park Blvd
Capitol Heights, MD 20743



Trade Area

There is immediate access to I-495 Capital Beltway via Ritchie Marlboro Road (Exit 13) approximately 2.5 miles. Located in a growing industrial corridor, 1001 Hampton Park Blvd provides a close proximity to major urban centers, abundant amenities and skilled labor.

This location is ideal for logistics, distribution, and regional operations and is able to accommodate cold storage needs.

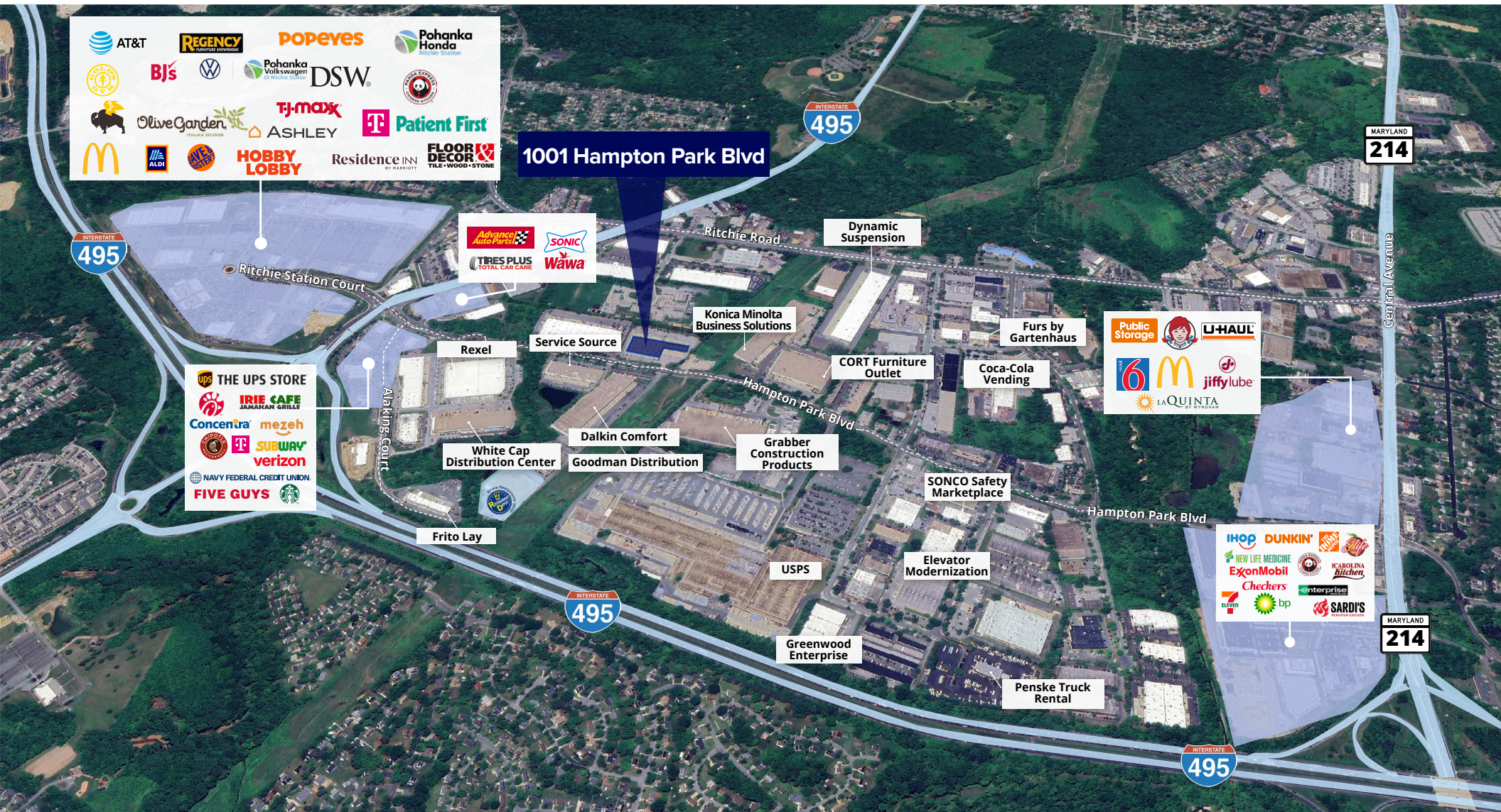

1001 Hampton Park Blvd
Capitol Heights, MD 20743

Contact Us

Jason Sullivan, SIOR

Executive Vice President

+1 410 319 2409

jason.sullivan@colliers.com

Brian Watts

Executive Vice President

+1 410 319 2408

brian.watts@colliers.com

Melissa Parrish

Associate Vice President

+1 410 319 2412

melissa.parrish@colliers.com

Brian Siegel, SIOR

Executive Vice President

+1 410 319 2410

brian.siegel@colliers.com

Thomas Gentner

Executive Vice President

+1 410 319 2407

tom.gentner@colliers.com



7001 Columbia Gateway Dr

Suite 220

Columbia, MD 21046

+1 410 319 2411

colliers.com

This document has been prepared by Colliers for advertising and general information only. Colliers makes no guarantees, representations or warranties of any kind, expressed or implied, regarding the information including, but not limited to, warranties of content, accuracy and reliability. Any interested party should undertake their own inquiries as to the accuracy of the information. Colliers excludes unequivocally all inferred or implied terms, conditions and warranties arising out of this document and excludes all liability for loss and damages arising there from. This publication is the copyrighted property of Colliers and/or its licensor(s). ©2026. All rights reserved.