



## 2915 Whitehall Park Drive Charlotte, NC

Located within Charlotte's master-planned Whitehall Technology Center, a unique, mixed use development in Southwest Charlotte featuring Class A office and functional warehouse distribution space with unique curb appeal, unmatched access from across the city, and surrounded by amenities.

- 95,200 SF, single-story Class A "flex" building
- 18' clear height
- ESFR Sprinkler System
- 192 parking spaces (2:1,000)
- Available suites feature above-standard office finishes, warehouse HVAC, and heavy power
- 24 hour security
- Multiple data and fiber providers

### MASTER-PLANNED COMMUNITY

Located in Charlotte's master-planned Whitehall community, a fully-integrated, mixed-use regional center and one of Charlotte's fastest growing areas

### UNMATCHED ACCESS

Located at Arrowood Road and I-485, with immediate access to I-485, I-77, I-85  
Minutes from Charlotte Douglas International Airport and the Intermodal Yard

### SURROUNDED BY AMENITIES

Immediately accessible to Ayrnsley and Whitehall Commons, large retail and mixed-use developments with numerous restaurants, hotels, and services

### RESPECTED CORPORATE NEIGHBORS

Home to Cadmus Communications, Cimtec Automotion, Octapharma Plasma, Ryland Homes, Xerox, Toshiba, Time Warner Cable, Westinghouse, Weyerhaeuser



### FOR MORE INFORMATION

Bill Wood | 704.295.0445 | [wpw@trinity-partners.com](mailto:wpw@trinity-partners.com)



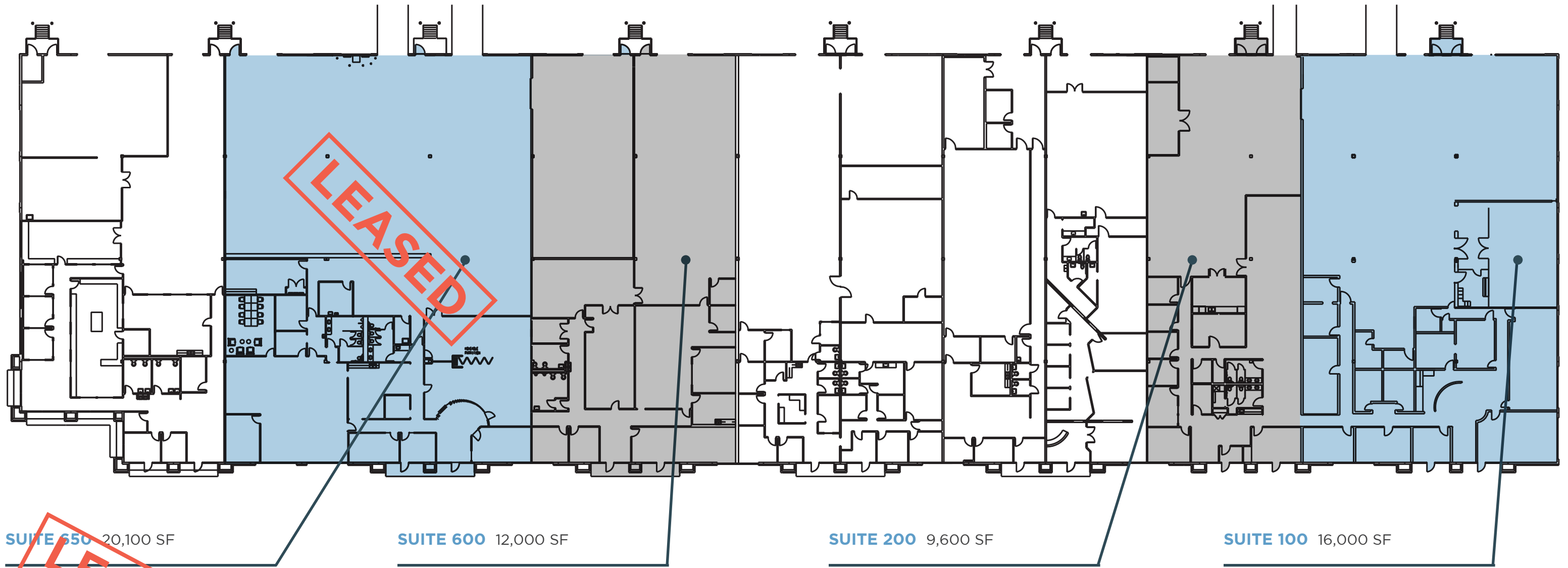

**SUITE 650** 20,100 SF

**SUITE 600** 12,000 SF

**SUITE 200** 9,600 SF

**SUITE 100** 16,000 SF

- 7,878 SF of existing office
- Above standard office finishes
- Substantial store-front glass
- Air-conditioned, "finished" warehouse with epoxy floors and painted interior
- T-5 warehouse lighting
- Heavy power: 800 amps at 480/277
- 1 dock-high door, 2 drive-in doors
- Contiguous to Suite 600; can be combined for 32,100 SF

- 5,026 SF of existing office
- Air-conditioned, "finished" warehouse with painted interior
- T-5 warehouse lighting
- Heavy power: 1000 amps at 480/277
- 3 dock-high doors

- 5,150 SF of existing office
- Atrium-style entrance with high ceilings
- Above standard office finishes
- Air-conditioned, "finished" warehouse with painted interior
- T-5 warehouse lighting
- Heavy power: 800 amps at 480/277
- 1 dock-high door, 1 drive-in door
- Contiguous to Suite 100; can be combined for 25,600 SF

- 7,740 SF of existing office
- "End cap" unit with substantial glass
- Above standard office finishes
- Air-conditioned, "finished" warehouse with epoxy floors and painted interior
- T-5 warehouse lighting
- Heavy power: 400 amps at 480/277
- 1 dock-high door, 1 drive-in door
- Contiguous to Suite 200; can be combined for 25,600 SF