

[CLICK FOR
3D TOUR](#)

**LEE &
ASSOCIATES**



**FOR SALE
OR LEASE**

1202 Royal Dr | Conyers, GA
51,093 SF Distribution Building

PROPERTY INFORMATION:

- 51,093-sf Distribution Building
- 42,529-sf Warehouse (19' Clear)
- 8,564-sf Office (2025 Makeready)
- Eleven (11) Dock High Doors
- One (1) Drive-In Ramp
- 100' Truck Court
- New Interior Makeready and Whitebox
- New Striping in Parking Lot
- New LED Lighting in Warehouse + Office
- TPO Roof
- Fully Sprinklered
- Immediate Access to I-20
- Power: 600 amps, 3 Phase



MARKETED BY:



Connor Winkler
318.393.8248
cwinkler@lee-associates.com

Charlie Mitchell
404.987.1077
cmitchell@lee-associates.com



FOR SALE OR LEASE

1202 Royal Dr | Conyers, GA
51,093 SF Distribution Building



NEW EXTERIOR PAINT

NEW LED WALLPACKS

**NEW DOCK DOORS &
DOCK BUMPERS**

NEW LANDSCAPING

**NEW ASPHALT
AND STRIPING**



FOR SALE OR LEASE

**1202 Royal Dr | Conyers, GA
51,093 SF Distribution Building**

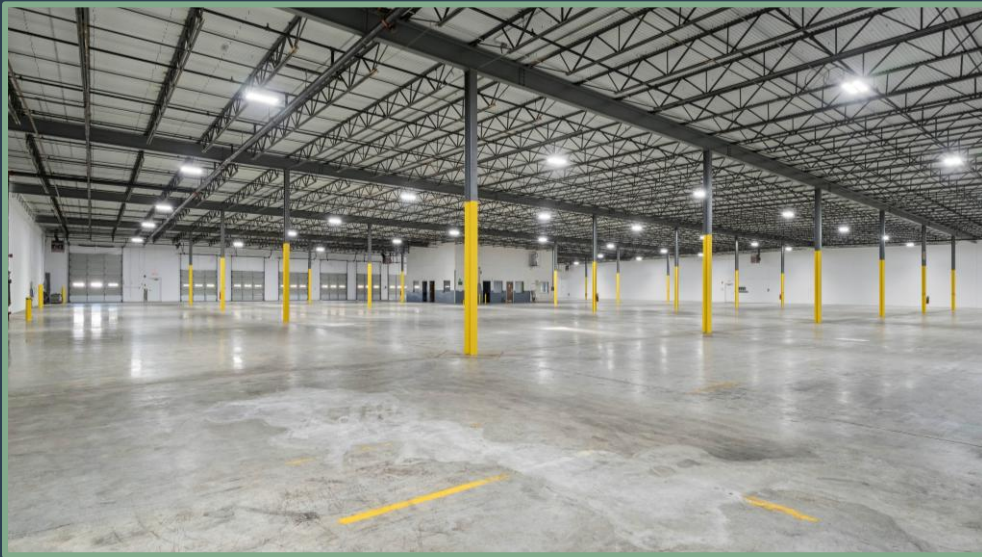

FOR SALE OR LEASE

1202 Royal Dr | Conyers, GA
51,093 SF Distribution Building

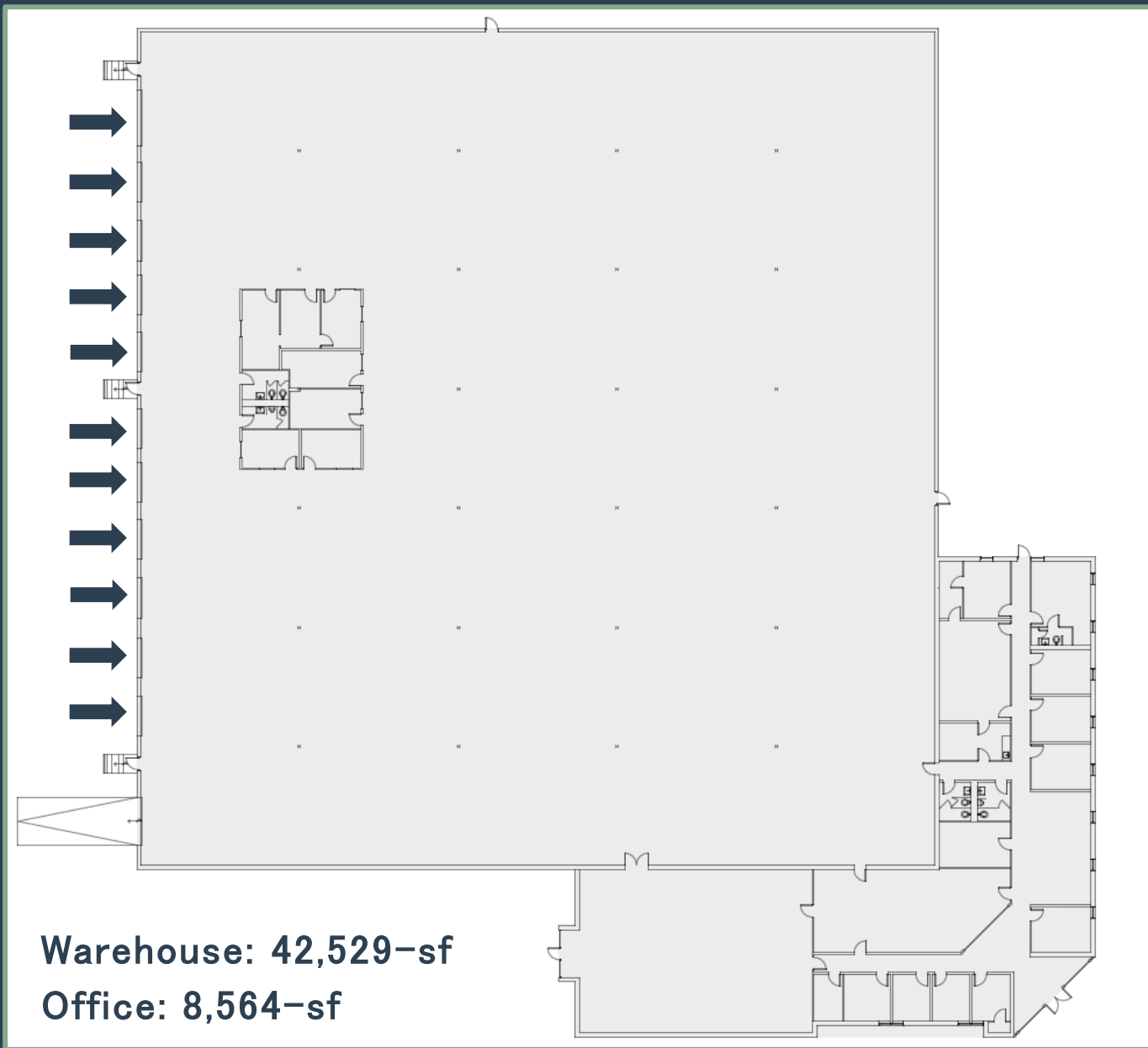

FOR SALE OR LEASE

1202 Royal Dr | Conyers, GA
51,093 SF Distribution Building



**POLISHED
CONCRETE FLOOR**

NEW COLUMN PAINTING

NEW WAREHOUSE PAINT

NEW LED LIGHTING



FOR SALE OR LEASE

**1202 Royal Dr | Conyers, GA
51,093 SF Distribution Building**

*Click [HERE](#) for Virtual Tour of Office and Warehouse Space



FOR SALE OR LEASE

1202 Royal Dr | Conyers, GA
51,093 SF Distribution Building



FOR SALE OR LEASE

1202 Royal Dr | Conyers, GA
51,093 SF Distribution Building

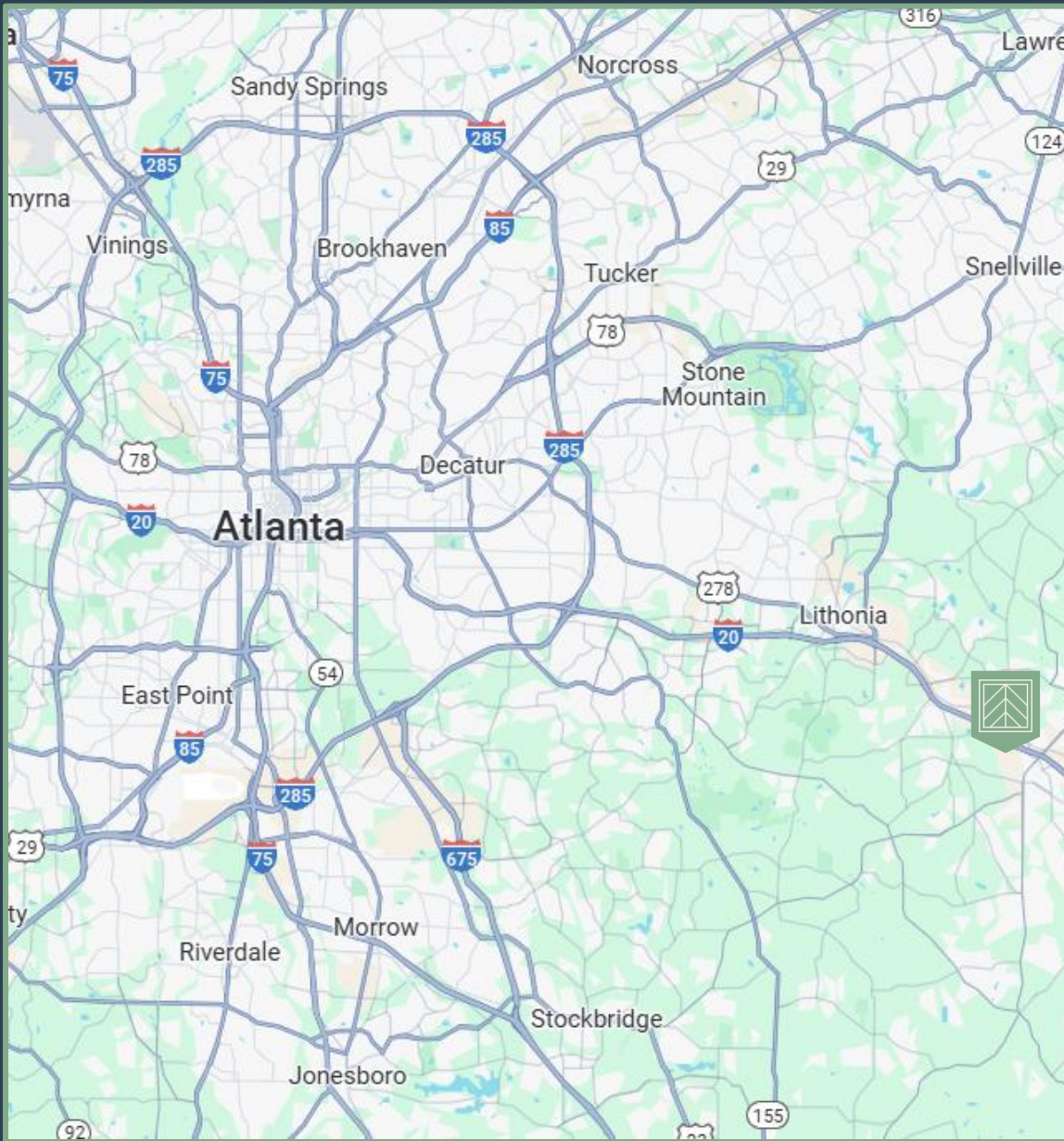

AVAILABLE IMMEDIATELY!

- 51,093-sf Distribution Building
- 42,529-sf Warehouse (19' Clear)
- 8,564-sf Office (2025 Makeready)
- New Interior Makeready
- Eleven (11) Dock High Doors
- One (1) Drive-In Ramp

MARKETED BY:



Connor Winkler

318.393.8248

cwinkler@lee-associates.com

Charlie Mitchell

404.987.1077

cmitchell@lee-associates.com



FOR SALE OR LEASE

1202 Royal Dr | Conyers, GA
51,093 SF Distribution Building



ROYAL DR



FOR SALE
OR LEASE

1202 Royal Dr | Conyers, GA
51,093 SF Distribution Building