

ONE SANDY CENTER



10011 SOUTH CENTENNIAL PARKWAY
SANDY, UTAH





Fiber Connectivity

- CenturyLink
- Comcast
- FIRSTDIGITAL
- verizon

Access to Transportation

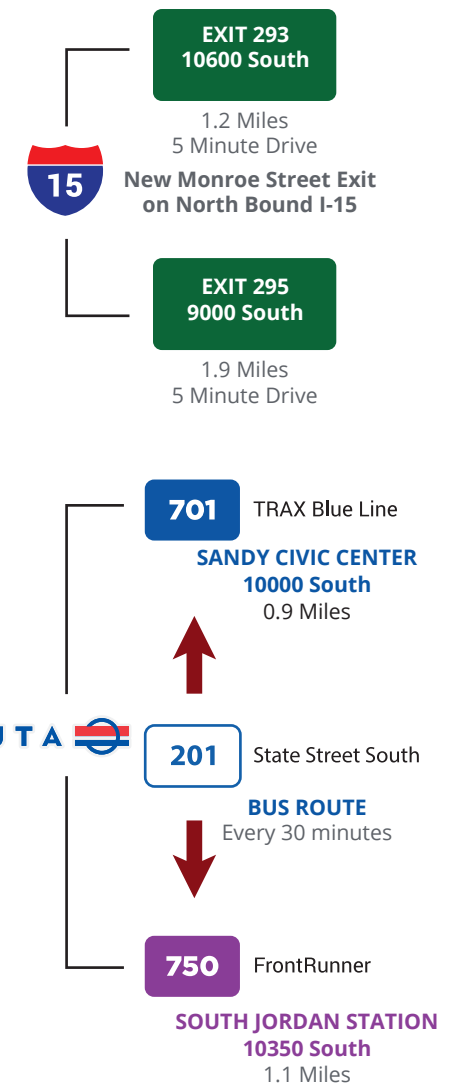

Lease Rate:
\$27.00/SF
Full Service



Easy I-15 accessibility
through 9000 S., 10600 S.
and new Monroe St. exit



Wide range of high quality spec
suites available including full 4th
floor of 21,097 RSF

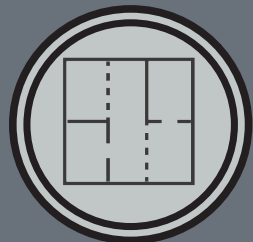

Recently completed
lobby, bathroom
and common area
renovations



Located in the absolute
heart of Sandy City with
a plethora of nearby
amenities



Beautiful panoramic mountain
and valley views



350KW Backup
generator on-site

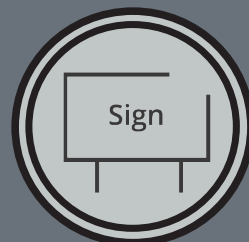

Exterior Building Signage
Available



Parking: 4/1,000 SF

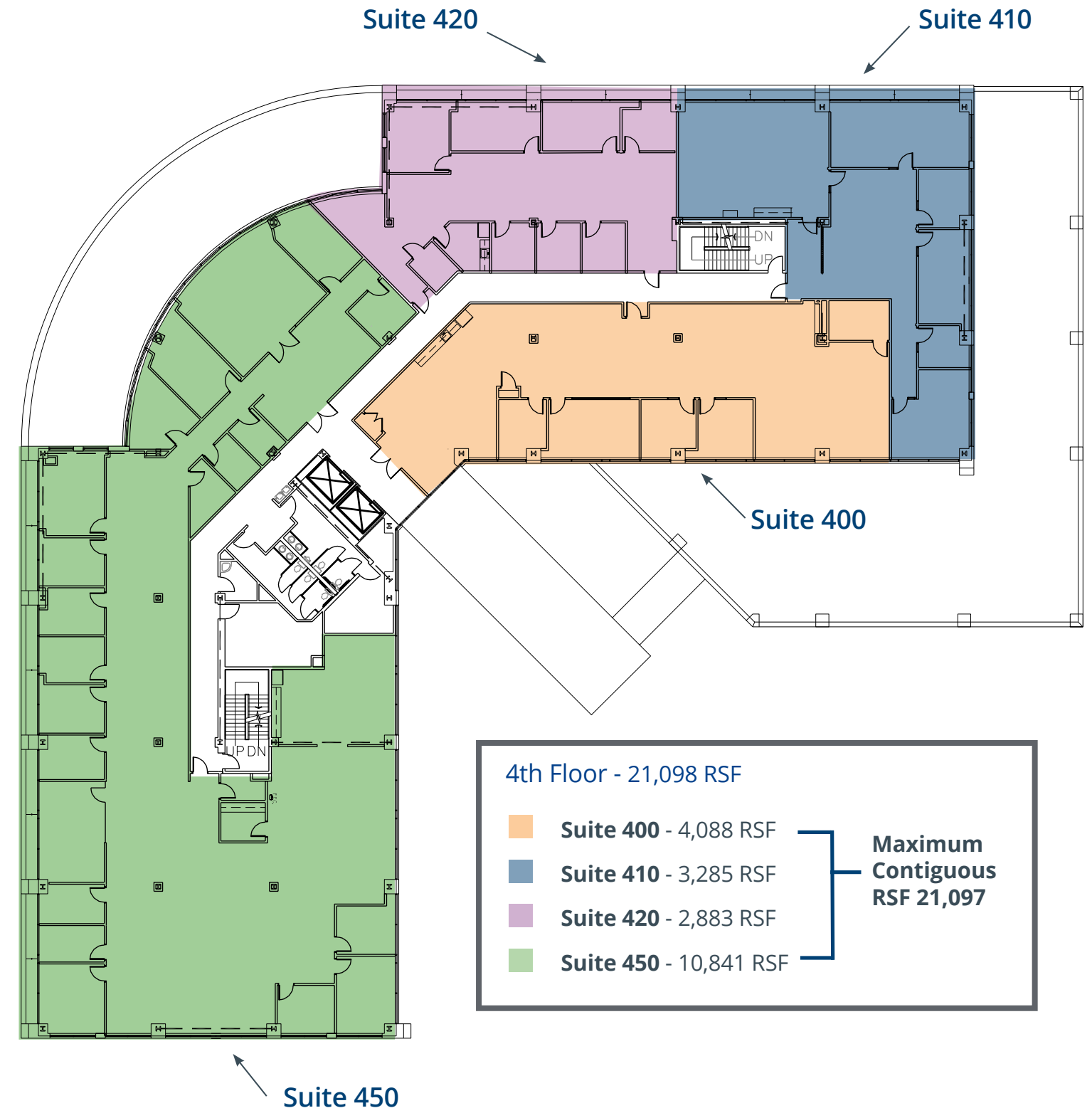
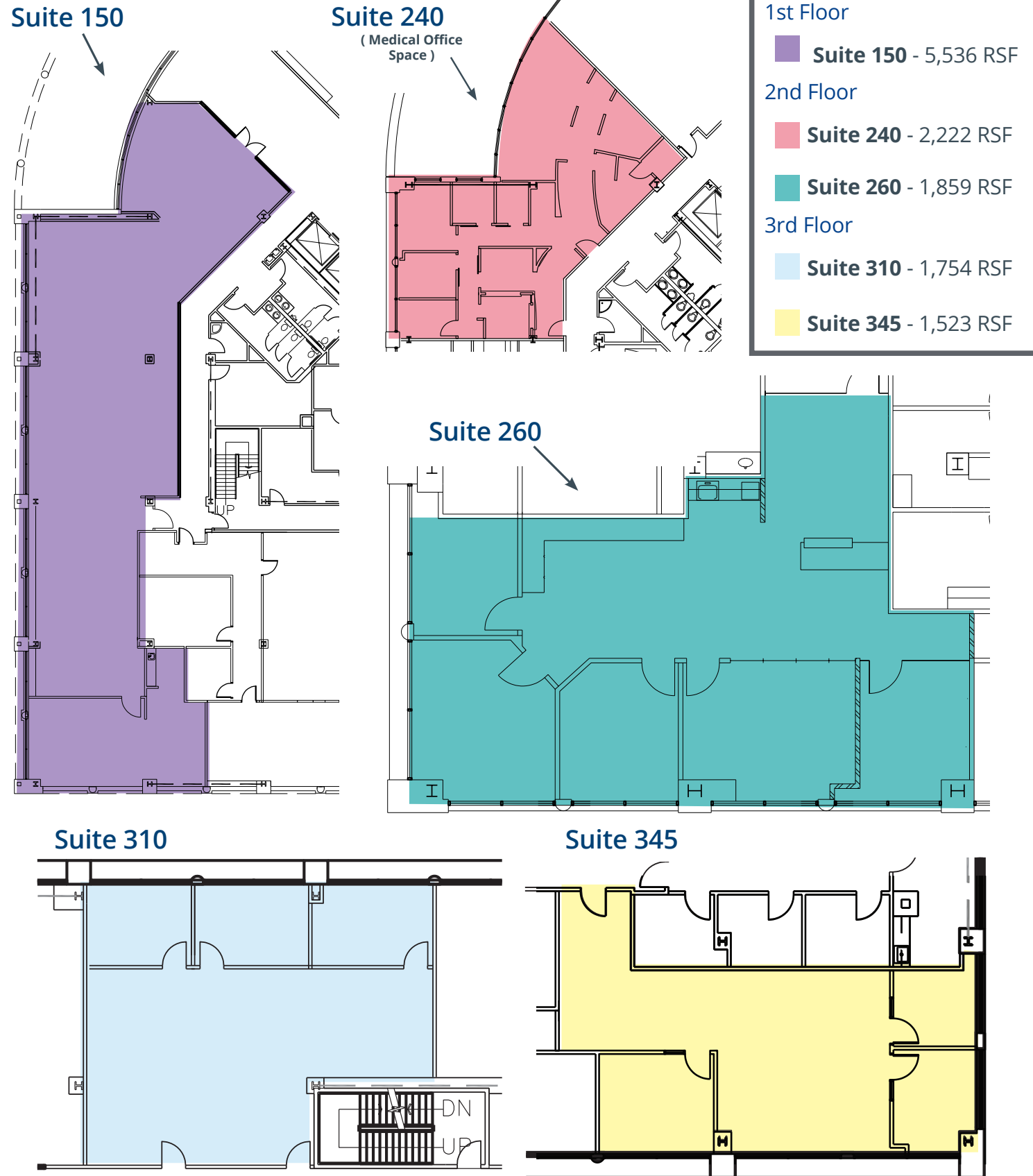

Highly Amenityzed Area



ONE SANDY CENTER : 10011 SOUTH CENTENNIAL PARKWAY | SANDY, UTAH



Chris Kirk, SIOR
 Managing Director
 +1 801 947 8385
 chris.kirk@colliers.com

Travis Yates
 Vice President
 +1 801 947 8336
 travis.yates@colliers.com



Accelerating success.

This document has been prepared by Colliers International for advertising and general information only. Colliers International makes no guarantees, representations or warranties of any kind, expressed or implied, regarding the information including, but not limited to, warranties of content, accuracy and reliability. Any interested party should undertake their own inquiries as to the accuracy of the information. Colliers International excludes unequivocally all inferred or implied terms, conditions and warranties arising out of this document and excludes all liability for loss and damages arising therefrom. This publication is the copyrighted property of Colliers International and/or its licensor(s). ©2024. All rights reserved.