

# BROYHILL

*Executive Office Suites*

*Now Leasing!*

BROYHILL.NET

HISTORIC BROYHILL  
3540 CLEMMONS RD, CLEMMONS NC 27012

10,970 SQ. FT. WING IN THE HEART OF CLEMMONS NC



High Visibility Signage & Prestigious Address  
Utilities & Office Maintenance  
Fiber Optic Internet & Digital Phone Connection  
Security Access and Camera Monitors 24/7/365  
Break Out Meeting Rooms Onsite  
Executive Conference & Reception Center  
Ample Windows & Natural Light

160 Onsite Parking Spaces & Well Lit Parking Lot  
Handicap Accessable/ADA Compliant  
Garden Courtyard & Manicured Grounds  
Turn Key Leasing Process  
Strong Community Support  
Professional On Site Staff  
Copier, Scanner, Fax Machine & Printer

.25 Miles to I-40 • .0 Miles to 158 • 5 Miles to Winston Salem • 8 Miles to Advance  
3 Miles to Bermuda Run • 1 Mile to Medical Centers • 5 mile population 50,000



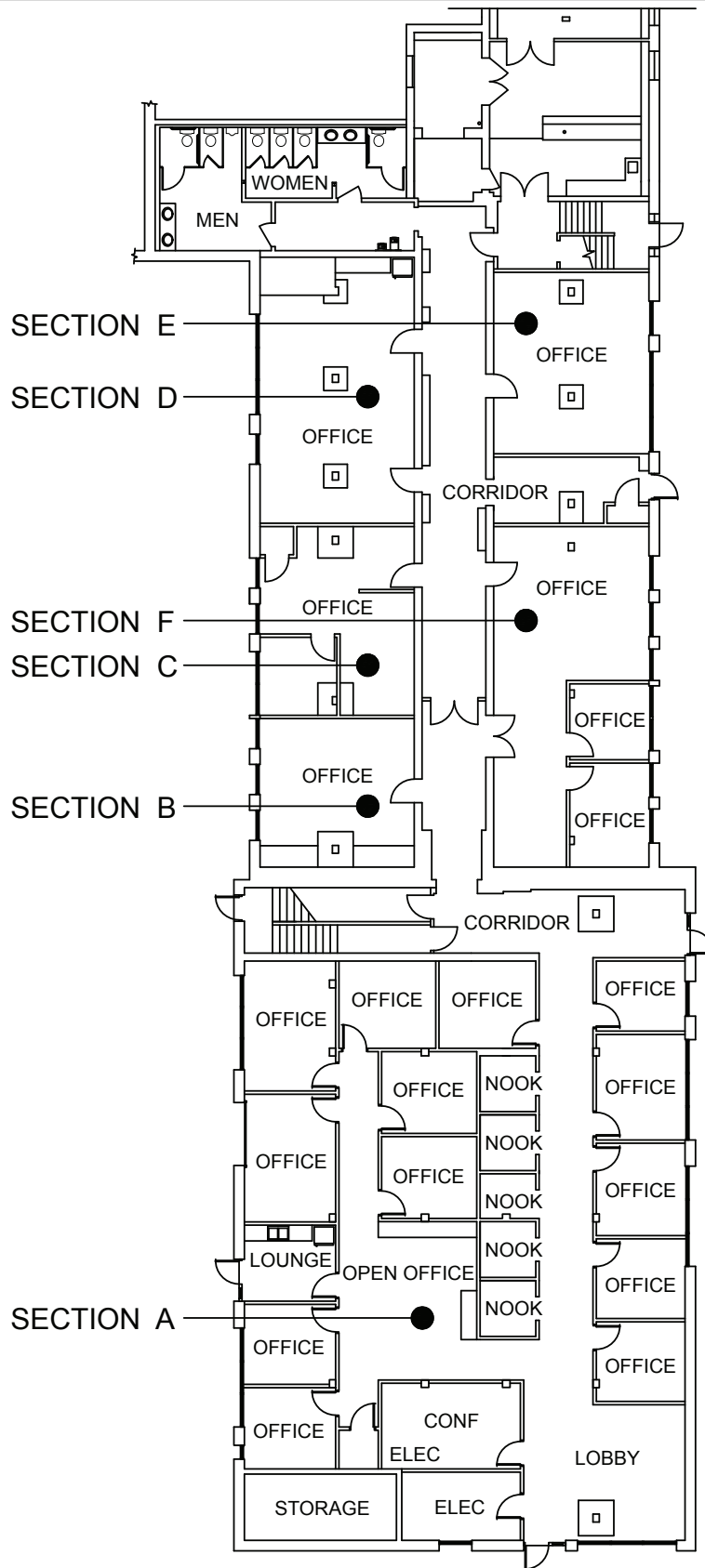

**BROYHILL**  
Office Suites & Conference Center

CONTACT:  
**KRISTIN R. JOHNSON, Director**  
Office Suites. Conference Center. Historic Events Center.  
3540 Clemmons Road, Clemmons, NC 27012  
336.793.1191 (O) 336.408.5426 (C)  
www.broyhill.net www.broyhillcc.com

**ada**  
ARCHITECTURAL  
DESIGN ASSOCIATES  
P.L.L.C.  
Imagine. Involve. Design.  
P. O. Box 888  
Clemmons, NC 27012  
336-712-1629

SUITE NO:  
**WEST WING**  
**LOWER LEVEL**