



TO LET

Unit 5 Causeway Business Park, Warrington, WA4 6RF

- Substantial Industrial Premises With Parking Provision
- Well-Established Business Park
- Forms Part of Warrington Regeneration Area
- Total Site Area Approx: 1.6 acres (6,490 sq.m.)

Property Consultants
Chartered Surveyors & Valuers
(Formerly Sutton Kersh)

TO LET

Unit 5 Causeway Business Park, Warrington, WA4 6RF

Location

The subject premises forms part of the Causeway Business Park which comprises a number of large industrial warehousing and office accommodation situated off Wilderspool Causeway (A49) approximately 1.5 miles South of Warrington Town centre.

Wilderspool Causeway (A49) is the main arterial route linking Warrington Town centre to smaller local centres such as Stockton Heath and Lower Walton, and providing reasonable transport links to Junction 20 of the M6 motorway network approximately 4 miles to the east. In addition, there are regular bus services along Wilderspool Causeway within 100 metres to the west.

The unit benefits from flooring of solid concrete construction, suspended fluorescent strip lighting fitted throughout, a high voltage (11kV) 1500 KVA electrical supply, 5 and 3 ton overhead cranes and a compressed air plant. In addition, there is a small self-contained block to the southeasterly corner of the site comprising WC facilities and canteen/kitchenette.

Maximum Eaves Height: 7.7m

Minimum Eaves Height: 4.1m

The Property

The property is a substantial single storey industrial warehouse unit comprising car parking provision for approximately 35 vehicles and loading access to the easterly side of the site.

The front elevation incorporates a roller shuttered vehicle/loading access doorway and a separate personnel entrance/exit with the main vehicle/loading access via the electric security gates fronting on to Causeway Avenue.

The unit is of conventional steel portal frame construction with elevations of facing brick. It has a dual pitched roof with steel profile sheeting, and incorporates translucent panels.

The unit benefits from flooring of solid concrete construction, suspended fluorescent strip lighting fitted throughout, a high voltage (11kV) 1500 KVA electrical supply, 5 and 3 ton overhead cranes and a compressed air plant. In addition, there is a small

self-contained block to the southeasterly corner of the site comprising WC facilities and canteen/kitchenette.

Accommodation

We have measured the premises in accordance with the RICS Code of Measuring Practice (6th Edition) to provide the following approximate areas and dimensions:

Industrial Building

Approx Gross Internal Area: 3,800 sq.m (40,903 sq.ft)

Tenure

The premises are available to let by way of a Full Repairing and Insuring Lease for a term to be agreed.

EPC

The property has an EPC rating of D95. Full report available upon request.

Rates

Interested parties should make their own enquiry of Warrington Borough Council's Rating Department on www.voa.gov.uk/businessrates.

Rent

£175,000 per annum

Viewings

Strictly by appointment via the sole agents SK Real Estate (Liverpool) Ltd Tel: 0151 207 9339 / Contact: Tom Pearson (tom.pearson@skrealestate.co.uk)

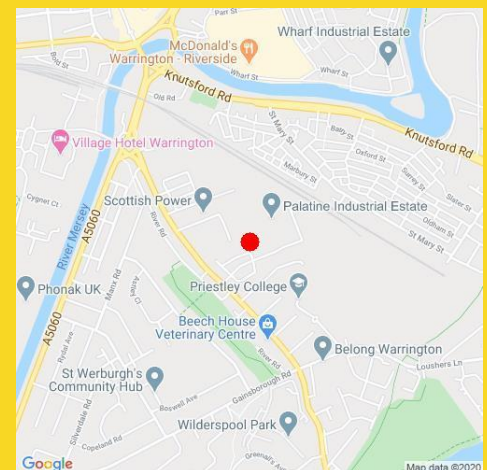
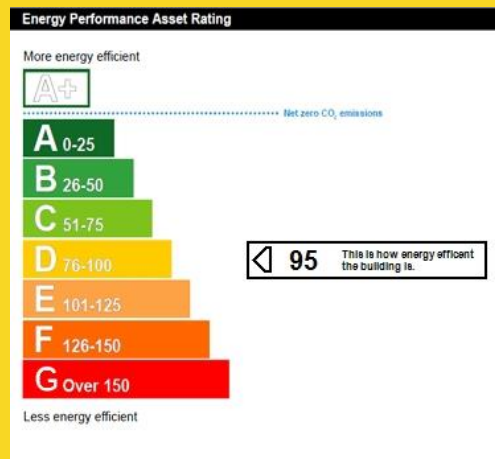
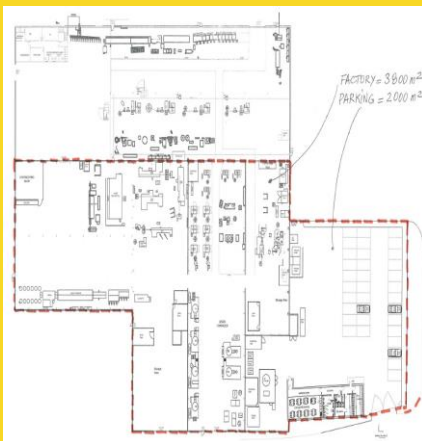

Disclaimer: Consumer Protection From Unfair Trading Regulations 2008: SK Real Estate for themselves and for the Vendors and Lessors of his property whose agents they are give notice that: (a) these particulars are set out as a general outline for the guidance of intending Purchasers or Lessors and do not form part of an offer contract, (b) all dimensions, reference to conditions and other details are given in good faith and are themselves by inspection or otherwise as to the correctness of each of them, (c) SK Real Estate nor any person in their employment has any authority to make or give any representation or Warranty whatsoever in relation to this property

