



Property Highlights

- Perfect restaurant location next to the new Dat Dog coming in downtown Lafayette, Louisiana
- Square footage: 5500 square feet
- For Lease: \$15 per square foot (NNN)
- Outdoor patio seating
- Fire Sprinkler system
- Former Restaurant w hood and grease trap



Former Restaurant For Lease

209 Jefferson St., Lafayette, LA 70501

Overview

Aerial

Floor Plan

Photos

Demographics



Beau Box
225.931.3200 | box@beaubox.com

200 West Congress St, Suite 1020, Lafayette, LA. 70501 | 337.233.1488 | www.beaubox.com

Broker of Record, Beau J. Box; Licensed by the Louisiana Real Estate Commission, Mississippi Real Estate Commission, and Alabama Real Estate Commission, USA. This information has been secured from sources we believe to be reliable, but we make no representations or warranties, expressed or implied, as to the accuracy of the information. References to square footage or age are approximate. Buyer must verify the information and bears all risk for any inaccuracies.

© Beau Box Commercial Real Estate. November 12, 2018 8:37 AM



Former Restaurant For Lease

209 Jefferson St., Lafayette, LA 70501

Overview

Aerial

Floor Plan

Photos

Demographics

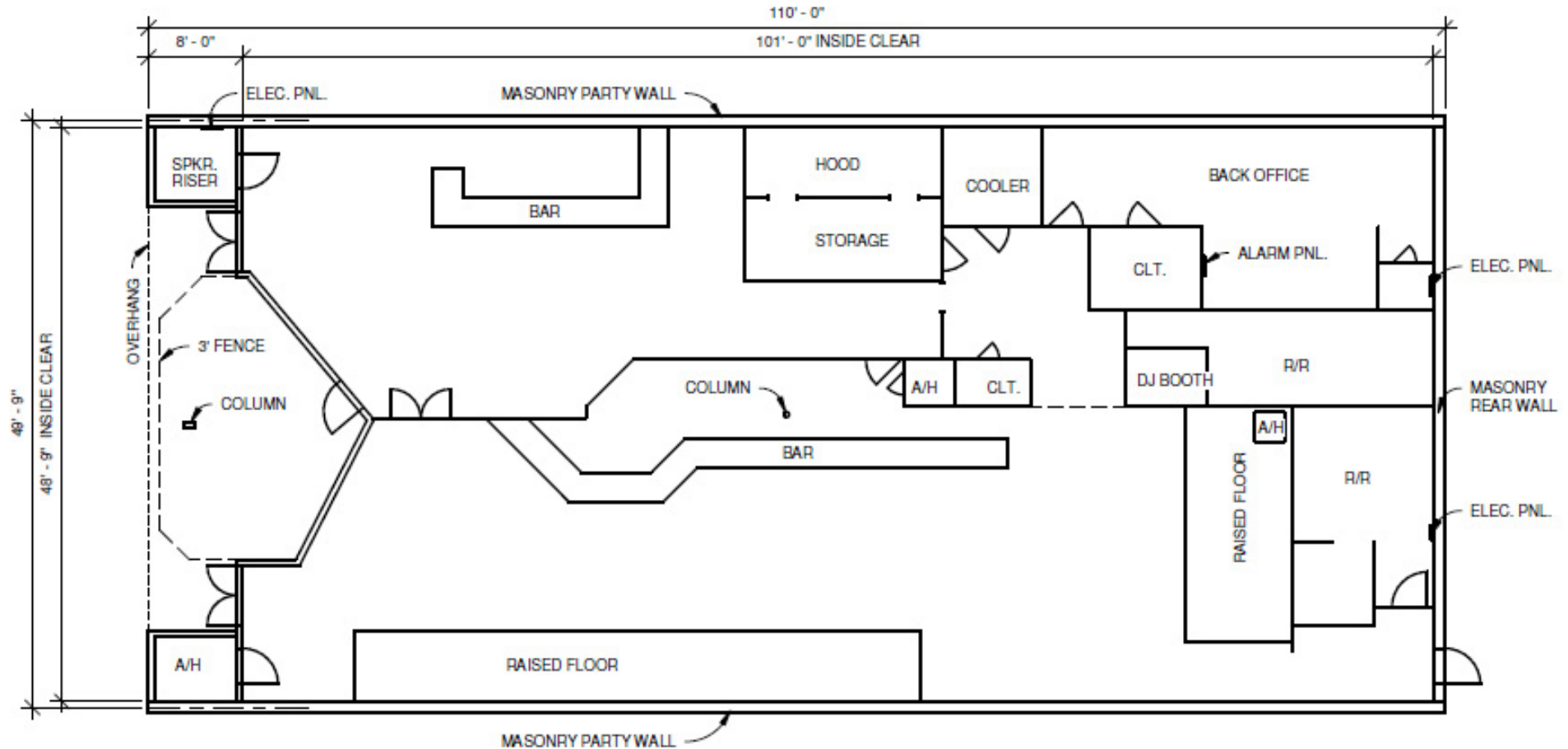

Beau Box

225.931.3200 | box@beaubox.com

200 West Congress St, Suite 1020, Lafayette, LA. 70501 | 337.233.1488 | www.beaubox.com

Broker of Record, Beau J. Box; Licensed by the Louisiana Real Estate Commission, Mississippi Real Estate Commission, and Alabama Real Estate Commission, USA. This information has been secured from sources we believe to be reliable, but we make no representations or warranties, expressed or implied, as to the accuracy of the information. References to square footage or age are approximate. Buyer must verify the information and bears all risk for any inaccuracies.

© Beau Box Commercial Real Estate. November 12, 2018 8:37 AM



Former Restaurant For Lease

209 Jefferson St., Lafayette, LA 70501

Overview

Aerial

Floor Plan

Photos

Demographics



Beau Box

225.931.3200 | box@beaubox.com

200 West Congress St, Suite 1020, Lafayette, LA. 70501 | 337.233.1488 | www.beaubox.com

Broker of Record, Beau J. Box; Licensed by the Louisiana Real Estate Commission, Mississippi Real Estate Commission, and Alabama Real Estate Commission, USA. This information has been secured from sources we believe to be reliable, but we make no representations or warranties, expressed or implied, as to the accuracy of the information. References to square footage or age are approximate. Buyer must verify the information and bears all risk for any inaccuracies.

© Beau Box Commercial Real Estate. November 12, 2018 8:37 AM



Former Restaurant For Lease

209 Jefferson St., Lafayette, LA 70501

Overview

Aerial

Floor Plan

Photos

Demographics

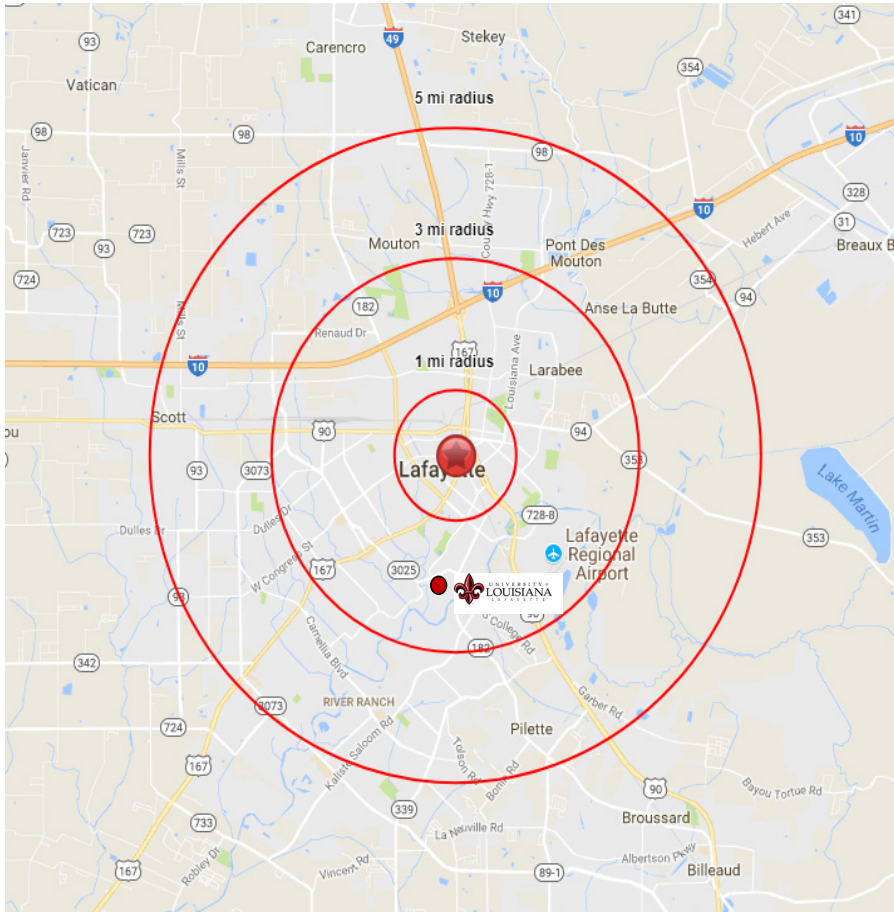

Demographics:

	<u>1 MILE RADIUS</u>	<u>3 MILE RADIUS</u>	<u>5 MILE RADIUS</u>
ESTIMATED POPULATION	13,802	60,716	125,568
ESTIMATED NUMBER OF HOUSEHOLDS	5,147	24,768	53,047
AVERAGE HOUSEHOLD INCOME	\$45,947	\$57,882	\$68,674
TOTAL UNIVERSITY POPULATION			17,195

Beau Box

225.931.3200 | box@beaibox.com

200 West Congress St, Suite 1020, Lafayette, LA. 70501 | 337.233.1488 | www.beaibox.com

Broker of Record, Beau J. Box; Licensed by the Louisiana Real Estate Commission, Mississippi Real Estate Commission, and Alabama Real Estate Commission, USA. This information has been secured from sources we believe to be reliable, but we make no representations or warranties, expressed or implied, as to the accuracy of the information. References to square footage or age are approximate. Buyer must verify the information and bears all risk for any inaccuracies.

© Beau Box Commercial Real Estate. November 12, 2018 8:37 AM