

THESE DIAGRAMS ARE NOT AN ARCHITECTURAL PLAN, THESE DIAGRAMS ARE NOT DRAWN TO ARCHITECTURAL SCALE, NOR DO THEY INCLUDE ALL OF THE REQUIREMENTS THAT MAY BE REQUIRED FOR AN ARCHITECT TO PROVIDE YOU WITH COMPLETE ARCHITECTURAL PLANS. PATTERSON'S DIAGRAMS MAY NOT BE SUBMITTED AS FINISHED ARCHITECTURAL DRAWINGS FOR THE PURPOSE OF OBTAINING A BUILDING PERMIT. IF YOU SHOULD CHOOSE TO USE PATTERSON'S DIAGRAM IN THE PLACEMENT OF YOUR EQUIPMENT, YOU SHOULD RETAIN A REGISTERED ARCHITECT TO CONVERT THE DIAGRAM INTO PROPER AND COMPLETE ARCHITECTURAL PLANS. PATTERSON WILL WORK WITH THE ARCHITECT YOU SELECT TO DEVELOP COMPLETE ARCHITECTURAL PLANS.

All work performed shall be in accordance with all applicable local codes, regulations, ordinances and authorities having jurisdiction.

LEGEND

SCOPE:
Furnish all labor and material, piping, valves, fittings, etc. for the installation of all Plumbing fixtures and Dental equipment called for on the drawings, inclusive of final connections. Plumbing fixtures to be furnished by plumber, unless otherwise noted. Installation shall include all fittings which are components of Dental equipment as provided by the Equipment Manufacturer prior to or at time of installation.

Dental equipment to be furnished by Owner unless otherwise noted.

Dental utility service center: Provide the following utilities to designated locations on drawings. Before installation a template will be furnished and positioned with the assistance of the Patterson Dental Representative. The template will show details (size & height) of terminal fittings and locations of bolt holes required for securing the dental utility center. Where pipes come through concrete sleeves are to be used providing a 1/2" clearance around pipes. Openings are to be sealed before final connections are made. Cold water line shall loop from Dental sink in each treatment room to Dental utility service centers within room, and have separate shut-off valve under Dental sink.

P3 Floor utility service center (riser sizes) AIR- 1/2" air line NPT; to extend 1" out of finished floor.

C. WATER- 1/2" water line NPT; to extend 1" out of finished floor.
VACUUM- 5/8" O.D. vacuum line perpendicular to floor similar to waste connection.
Note: Water and air to have shutoff valves.
(SEE SHEET 5 DETAIL #1)

P4 Floor utility service center (riser sizes) AIR- 1/2" air line NPT; to extend 1" out of finished floor.
VACUUM- 5/8" O.D. vacuum line perpendicular to floor similar to waste connection.
Note: Water and air to have shutoff valves.
(SEE SHEET 5 DETAIL #4)

P5 Central Dental Vacuum Pump- Supplied by Doctor installed by Plumber to waste and water. Provide a 1-1/4" (verify) IPS schedule 40 PVC line at vacuum pump location and run to points P3 & P4 in treatment rooms and reduce riser to 5/8" O.D. Provide a 1 1/2" waste line, and cold water line with shut off valve. Provide 2" separate atmospheric vent. Tie in system on finish. See MFGRS. specs. Central dental vacuum located in Mech. Rm. (Note: Plumber to use radius sweeps on all Vacuum line bends or angles and not 90° angles. All vacuum line to run in floor.)
(SEE SHEET 6 DETAIL #6)
(SEE SHEET 8)

P6 Air Compressor- Supplied by doctor and installed by Plumber. Run 1/2" ID copper tubing from air compressor located in Mech. Rm. to all points calling for air. Test air lines at 150 PSI for 24 hours there shall be no leaks. Plumber to tie in system on finish. See MFGRS. specification for details.
(See dental manuf. specs for fresh air intake requirements.)
(SEE SHEET 6 DETAIL #9)
(SEE SHEET 8)

P7 Air Valve- Below sink. Connect to main air line. 3/8" x 3/8" IPS chrome angle valve required. See doctor for details and confirm if applicable. See Patterson rep. for details.

P9 Plaster trap- Supplied by Doctor, installed by Plumber to laboratory sink, 22" aff.
(SEE SHEET 6 DETAIL #7)

P10 Model trimmer- Install cold water line with a 1/4" chrome angle stop above the counter-top. Model trimmer has a 1" male nipple for flexible waste pipe connection. Plumber to run waste line from trimmer to sink tailpiece/plaster trap with tee into sink strainer tail-piece connection. Provided by Doctor and installed by Plumber.
(SEE SHEET 6 DETAIL #7)

P11 Water solenoid valve- Supplied by Patterson and installed by plumber. Plumber to connect main water valve to cold water line feeding dental suite. Valve's purpose is to control dental equipment only. Valve to be installed in a readily accessible place (field located) Valve has manual Bi-Pass built in.
(SEE SHEET 6 DETAIL #5)

P14 Rest room fixtures- Supplied and installed by Plumber. Provide hot/cold water lines with shut off valves, waste, vents and traps. See Doctor for details.

P15 N2O/O2 (nitrous oxide and oxygen) central system- This system requires 1/2" O.D. copper tubing oxygen and 3/8" O.D. copper tubing nitrous oxide from manifold at point "P15" in room tanks, at 66" up from floor to recessed wall boxes at point P15A in treatment room see rep. up from floor. Manifold and N2O/O2 recessed boxes supplied by Doctor installed by Plumber. Test system for 48 hours at 150 PSI with nitrogen. There shall be no leaks. Use no air or water for test. Plumber to supply regulator and nitrogen for test refer to NFPA, 99C.
MATERIALS- piping, type K or L precleaned, degreased and capped copper tubing.
JOINTS- silver solder with melting point at 1,000 deg. F. min. Flare compression or threaded pipe fittings unacceptable.
(SEE SHEET 9)

P15A Oxygen, nitrous, and vacuum see rep off. O2/ N2O - Porter TRIPLE outlet station. 1/2" od for O2 3/8" OD. on N2O. Outlet station by owner.
(SEE SHEET 9)

P17 Treatment room sink- To be approx. 15" x 15" stainless steel with single lever foot control Patterson Dental faucet. Provide hot and cold water with valves, 1/2" air w/ valves, 1 1/2" waste, vent, and trap. Hook up sink after cabinet installation. Supplied by _____

P19 Plumber to route N2O/O2 lines from tank loc. through master zone valve that will be field located. Zone valve supplied by Doctor installed by plumber (zone valve installation only if code(s) requires) Consult with Doctor.
(SEE SHEET 9)

P20A Steri Centre 9000- Provide hot and cold water, waste, vent, trap, air and vacuum lines according to template. See Patterson rep. for more details.

P21 Laboratory sink- To be stainless steel with goose-neck faucet and single lever control. Provide hot/cold water with valves, 1 1/2" waste and vent. Sink to be supplied by _____ Sink to have cold water spray hose if no sink in dark room. (P18) (Plumber to make final connection.)

P23 Washer- Provide hot/cold water, 1 1/2" waste and vent- hook up for washer.

P25 Staff Lounge Sink- Provide hot/cold water with valves, 1 1/2" waste, vent and trap. See doctor for style and size. Sink to be supplied by Patterson Dental (Plumber to make final connection.)

P26 Mechanical Room- Provide remote air: 2" air intake from compressor to plenum. See Patterson Rep for details. (Verify need with Patterson Dental)
(SEE SHEET 6 DETAIL #9)
(SEE SHEET 8)

P28 Floor Drain- Plumber to install floor drain in Mechanical Room. See Patterson Rep for details.
(SEE SHEET 6 DETAIL #6)
(SEE SHEET 8)

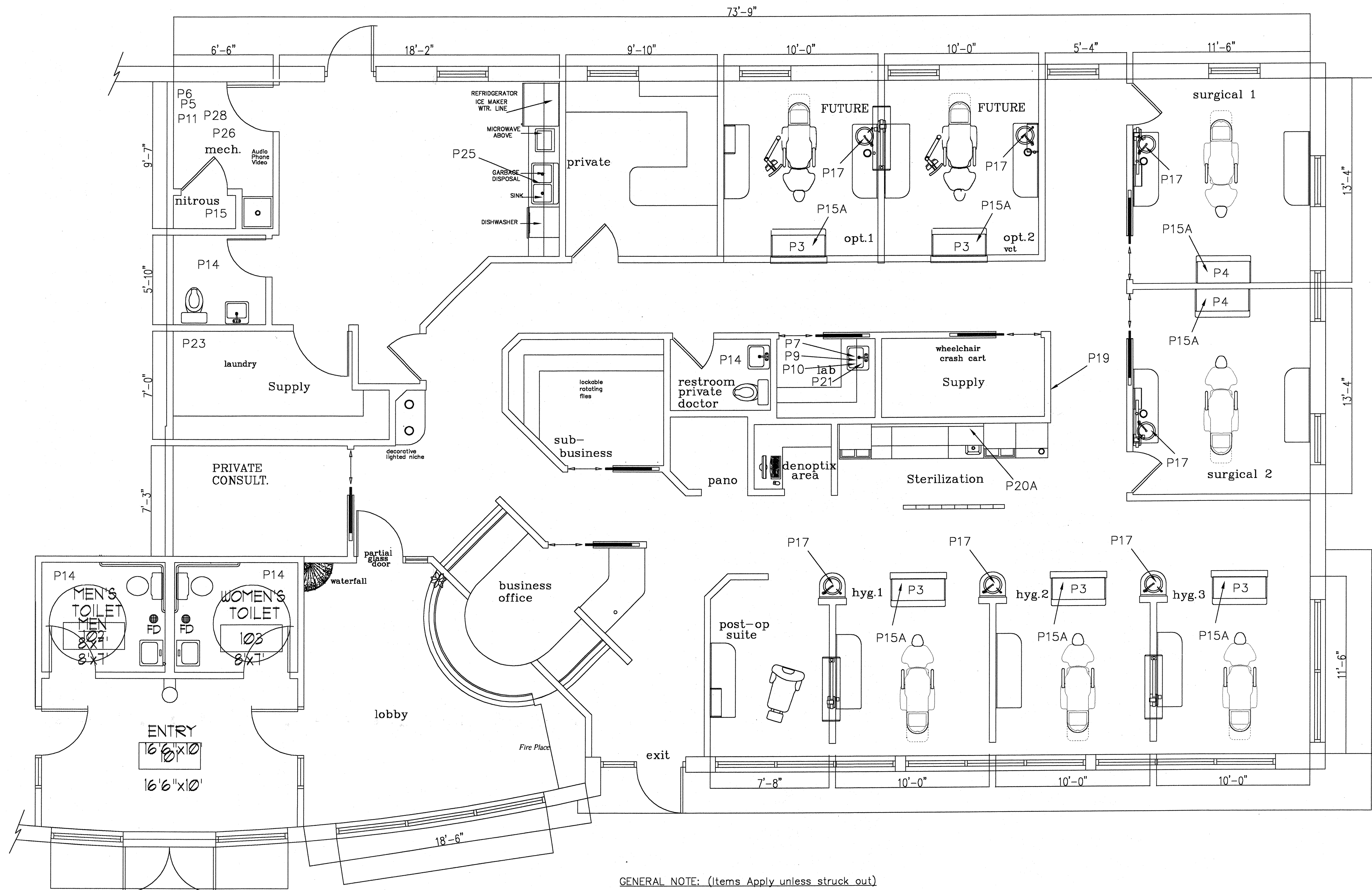

GENERAL NOTE: (Items Apply unless struck out)

- If temperature control equipment is not used in dark room, Plumber will provide and install gate valves for hot, cold and mixed water for Developing tank. Vacuum breaker will also be provided and installed by Plumber for mixed water. We recommend SMR model H400 or H403 Vacuum breaker.
- Nitrous Oxide and Oxygen lines will be installed to meet applicable plumbing and Fire Dept. rules, codes and regulations. It is advisable that the local Fire Dept. approve the design and layout before construction begins.
- If solenoid operated water shut-off is not used for this office, the Plumber will provide and install a gate valve in the office to shut off cold water to Dental office.
- If water pressure to office exceeds PSI, Plumber will furnish and install water regulator to reduce pressure to a maximum of 60 PSI.
- If local water conditions are troublesome because of debris such as sand in the lines, the Plumber will provide and install a water filter for this office.
- All Plumbing to be concealed unless otherwise specified.
- Vacuum lines to be installed by plumber.
- If the air compressor is located in the office or near the office and the office is under 2,000 sq. ft., we will provide specific information for air lines. All air lines should be pressure tested for 150 PSI.
- Air, gas, vacuum, waste, and water lines will have to be adapted to specific connectors at all termination points by Plumber.
- If water pressure is below 25 lbs., a booster pump shall be installed.
- Refer to general conditions (Dimensional Sheet) as applicable to all trades.
- All work is to be done by a licensed plumber.
- Plumber to be on job site day(s) of dental equipment installation and work with representatives of Patterson Dental Co. on equipment hook up and installation.
- Plumber to supply and install hot water tank sufficient in size for the needs of the Dental office if applicable.

NOTE: FOR ALL PLUMBING TO CABINETS PROVIDED BY PATTERSON DENTAL- PLUMBER TO PROVIDE NECESSARY PLUMBING TO LOCATION (SEE PATTERSON REP FOR FULL SIZE TEMPLATE AND EXACT LOCATION). MAKE FINAL CONNECTIONS AFTER INSTALLATION OF CABINETS.

Your Local **PATTERSON** Branch
DENTAL DESIGN DIVISION
4810 Park 370 Blvd
Hazelwood, MO. 63042 1-800-325-3184
Direct Line (314) 595-1300
EMAIL: WWW.PATTERSONDENTAL.COM

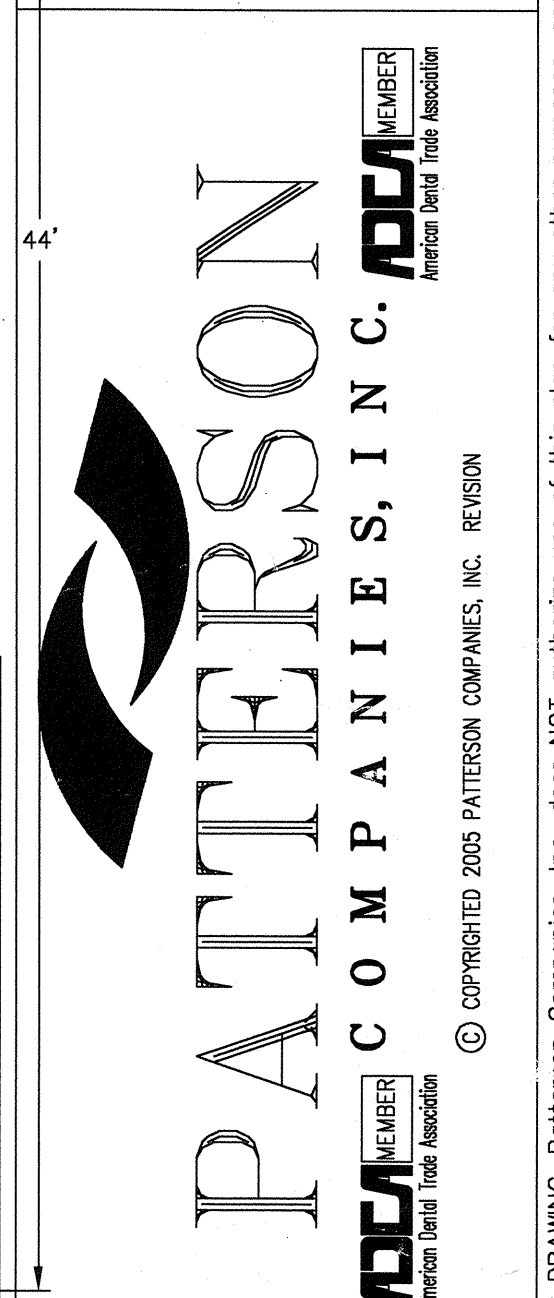

DENTAL OFFICE BUILDING
FOR
DR. ANDY WEBER
St. Louis, MO.
Shane Bennett
Equipment Specialist:

| | |
|---------------------|------------|
| 06S1210SP | |
| DATE: | 06/30/2006 |
| JOB: | 06S1210 |
| DATE: | REVISD |
| 07/21/06 | RFH |
| SHEET NO. 4 OF 9 | |
| Region Designer: | Scale: |
| RHAGEMANN | 1/4" |
| APPROX. SQ. FT. | 3,191 ± |

PLUMBING SHEET

NOTICE: This proposed plan is offered to assist our customer's architect or designer, AND IT IS NOT TO BE USED AS A WORKING DRAWING. Patterson Companies, Inc. does NOT authorize use of this plan for any other purposes, and we disclaim all liability if used for any other purposes.

© COPYRIGHTED 2005 PATTERSON COMPANIES, INC. DENSON