



*\*Representative Image*

## High Plains Industrial Park

I-27 & 114th Street | Lubbock, TX

### Property Features

High Plains Industrial Park is a new business park development located at 114th Street and Interstate 27, directly behind the well-known Cook's Garage. The project offers excellent access and visibility with convenient connectivity to the surrounding region. The development features build-to-suit opportunities, large acreage lots, and flexible development options designed to accommodate a wide range of industrial and commercial users. With its strategic location and adaptable layout, High Plains Industrial Park provides an ideal setting for businesses looking to establish or expand in South Lubbock.

### Offering Summary

LOT SIZES	1.5 - 9.5+ Acres
BUILDING SIZES	5,000 - 25,000+ SF
LEASE RATE	Contact Broker
AVAILABLE	Q4 2026

NO WARRANTY OR REPRESENTATION, EXPRESS OR IMPLIED, IS MADE AS TO THE ACCURACY OF THE INFORMATION CONTAINED HEREIN, AND THE SAME IS SUBMITTED SUBJECT TO ERRORS, OMISSIONS, CHANGE OF PRICE, RENTAL OR OTHER CONDITIONS, PRIOR SALE, LEASE OR FINANCING, OR WITHDRAWAL WITHOUT NOTICE, AND OF ANY SPECIAL LISTING CONDITIONS IMPOSED BY OUR PRINCIPALS NO WARRANTIES OR REPRESENTATIONS ARE MADE AS TO THE CONDITION OF THE PROPERTY OR ANY HAZARDS CONTAINED THEREIN ARE ANY TO BE IMPLIED.

Jax Collier  
 jax@naiwheelhouse.com  
 +1 325 207 6118  
 naiwheelhouse.com

Joe Magby  
 joe@naiwheelhouse.com  
 +1 806 200 3244  
 naiwheelhouse.com

# FOR LEASE

## Potential Renderings



# FOR LEASE

## Park Plan

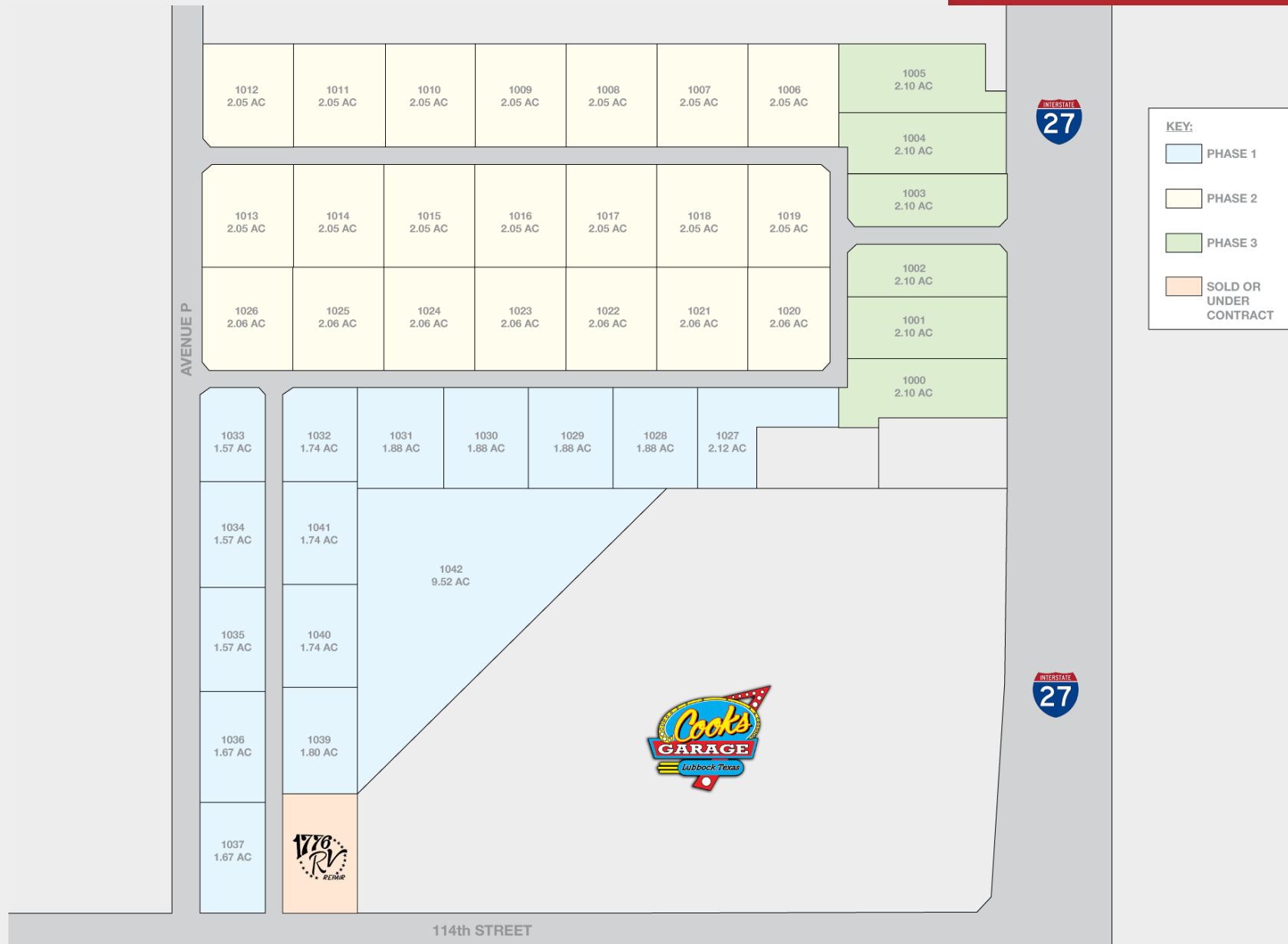

Jax Collier  
 jax@naiwheelhouse.com  
 +1 325 207 6118  
 naiwheelhouse.com

Joe Magby  
 joe@naiwheelhouse.com  
 +1 806 200 3244  
 naiwheelhouse.com

# FOR LEASE

## Location

