

4907 SCHAEFER ROAD
DEARBORN, MICHIGAN

OFFICE FOR SALE OR LEASE
2,000 Square Feet Available



**SIGNATURE
ASSOCIATES**
KNOW SIGNATURE | KNOW RESULTS



PROPERTY FEATURES

- 2,000 square feet available
- Zoned commercial
- 10' ceiling height
- Recently renovated building
- Excellent location with visibility
- Municipal lot in rear, 2 private spaces
- Seller will lease back building through 8/31/23, may be possible to vacate earlier
- Built in 1952, retrofitted in 2020
- Asking Price: \$300,000 (\$150.00/sq. ft.)
- Contact broker for leasing information



For more information, please contact:

DAVE MILLER
(248) 948 4183
dmiller@signatureassociates.com

DAN MORROW
(248) 799 3144
dmorrow@signatureassociates.com

SIGNATURE ASSOCIATES
One Towne Square, Suite 1200
Southfield, MI 48076
www.signatureassociates.com

4907 Schaefer Road – Dearborn, Michigan

Office For Sale or Lease

2,000
Square Feet
AVAILABLE

Floor Plan

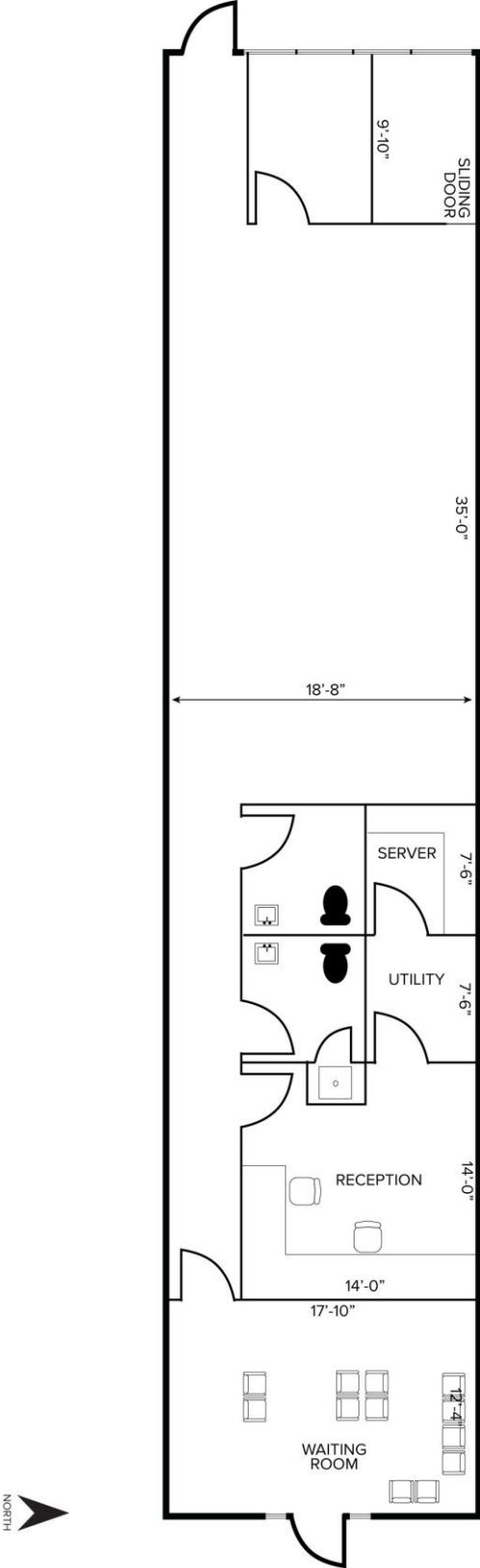

For more information, please contact:

DAVE MILLER
(248) 948 4183
dmiller@signatureassociates.com

DAN MORROW
(248) 799 3144
dmorrow@signatureassociates.com

SIGNATURE ASSOCIATES
One Towne Square, Suite 1200
Southfield, MI 48076
www.signatureassociates.com

Information is subject to verification and no liability for errors or omissions is assumed. Price is subject to change and listing withdrawal.

4907 Schaefer Road – Dearborn, Michigan

Office For Sale or Lease

2,000
Square Feet
AVAILABLE

Aerial



For more information, please contact:

DAVE MILLER
(248) 948 4183
dmiller@signatureassociates.com

DAN MORROW
(248) 799 3144
dmorrow@signatureassociates.com

SIGNATURE ASSOCIATES
One Towne Square, Suite 1200
Southfield, MI 48076
www.signatureassociates.com