

NORTHEAST CORNER SECTION 9, T3P, VAN BUREN TWP, WAYNE CO, MI

NORTH LINE OF SECTION 9

ECORSE ROAD (VARIABLE WIDTH)
N 89° 37'10" E 2254.35'

N 89° 37'10" E 193.82'

LEGEND - EXISTING

	E/P AVEMENT		OH - OVERHEAD WIRES		W - WATER LINE		SAN. MH		SC - STORM CLEAN OUT		PL - PUBLIC LIGHTING MH		M - MANHOLE		WF - WETLAND FLAG		HP - HANDICAP PARKING		LH - LAWN IRRIG. HEAD		B - BENCHMARK
	C - CURB		R - RAILING		G - GAS LINE		SAN. CLEAN OUT		L - LIGHT POLE		GM - GAS METER		S - SIGN		BS - BUSH/SHRUB		WF - WETLAND FLAG		M - MANHOLE		FP - FOUND PIPE
	CL - ROAD		OL - OVERHANG LINE		UG - UG ELEC. LINE		SAN. RISER		UP - UTILITY POLE		GR - GAS RISER		PP - PROT. POST/GUARD POST		CR - CENTERLINE R.R. TRACK		FP - FOUND PIPE		TCB - TRAFFIC CONTROL BOX		FM - FOUND MON.
	E - WALK		T - BANK		UT - UG TELE. LINE		SAN. PUMP STATION		ET - ELEC. TRANS.		GV - GAS VALVE		MS - MISC. TOPO. SHOT		SCP - SURVEY CONTROL POINT		FI - FOUND IRON		ASPH - ASPHALT		FM - FOUND MON.
	RR - RAILROAD		PS - PAINT STRIPE		UCTV - UG CABLE TV LINE		GV - GATE VALVE		AC - AIR CONDITIONER		UM - U.S. MAILBOX		FIP - FOUND IRON PIPE		CLF - CHAIN-LINK FENCE		FN - FOUND NAIL		CONC. - CONCRETE		SI - SET IRON
	E - BRICK		SL - SHRUB LINE		CS - COMBINED SEWER		CB - CATCH BASIN		EM - ELEC. MH		M - MEASURED		R - RECORD		F.L. - FOUND IRON		FM - FOUND MONUMENT		FI - FOUND IRON		FI - FOUND IRON
	ML - MISC. LINE		TL - TREE LINE		SL - STEAM LINE		BC - BEEHIVE CB		EM - ELEC. METER		SC - SECTION COR.		FP - FENCE POST		FI - FOUND IRON		FI - FOUND IRON		FI - FOUND IRON		FI - FOUND IRON
	F - FENCE		WE - WATER EDGE		EO - ELECTRIC OVERHEAD		CE - CULVERT E.S.		ER - ELEC. RISER		UF - UTILITY FLAG		BC - BLDG. CORNER (FIELD LOCATED)		EE - EXISTING ELEVATION		SB - SOILBORING		MW - MONITORING WELL		FI - FOUND IRON
	GR - GUARD RAIL		WL - WETLAND LINE		TO - TELEPHONE OVERHEAD		RS - ROOF/DOWN SPOUT		OS - OVERFLOW/OUTLET STRUCTURE		CR - CABLE RISER		PP - PAY PHONE		M - MANHOLE		S - SIGN		PP - PROT. POST/GUARD POST		DT - DECIDUOUS TREE
	W - WALL		SL - STORM LINE		WM - WATER METER		PIV - POST INDICATOR VALVE		WH - WELL HEAD		FC - FDC CONNECTION		ICB - IRRIGATION CONTROL BOX		SM - STORM MH		CB - CATCH BASIN		EM - ELEC. MH		DT - DECIDUOUS TREE
	BL - BLDG. LINE		SAN. LINE		W - WATER LINE		G - GAS LINE		UG - UG ELEC. LINE		UT - UG TELE. LINE		UCTV - UG CABLE TV LINE		CS - COMBINED SEWER		PLD - PLD LINE		SL - STEAM LINE		EO - ELECTRIC OVERHEAD

83-033-99-0001-000
*46363 ECORSE ROAD
KENNETH MILLER

83-033-99-0003-001
*46247 ECORSE RD
PHILIP KORTES & CRYSTAL BARNES

83-033-99-0005-001
*46197 ECORSE ROAD
AMY PRICE

83-033-99-0006-001
*46121 ECORSE ROAD
RICHARD PRICE

83-033-99-0008-000 (PART OF PARCEL 4)

83-033-99-0009-001
*45977 ECORSE ROAD
KAY WOODBURY

83-033-99-0036-000
*7994 BELLEVILLE ROAD
DANNIE BROWN

83-033-99-0041-000
*8178 BELLEVILLE ROAD
DANNIE BROWN FAMILY TRUST

83-033-99-0042-000
*8210 BELLEVILLE ROAD
MARY & ROBERT FINLEY

83-033-99-0034-701
*7886 BELLEVILLE ROAD
FULL HOUSE SELF STORAGE

83-033-99-0033-000
*7810 BELLEVILLE ROAD
DANNIE BROWN

83-033-99-0002-002
MILDRED PETERSON

83-033-99-0002-002
MILDRED PETERSON

83-033-99-0007-000 (PART OF PARCEL 4)

83-033-99-0009-002

83-033-99-0004-002

83-033-99-0005-002

83-033-99-0006-002

83-033-99-0008-000 (PART OF PARCEL 4)

83-033-99-0009-001

83-033-99-0036-000

83-033-99-0041-000

83-033-99-0042-000

83-033-99-0034-701

83-033-99-0033-000

83-033-99-0002-002

83-033-99-0007-000

83-033-99-0009-002

83-033-99-0004-002

83-033-99-0005-002

83-033-99-0006-002

83-033-99-0008-000

83-033-99-0009-001



LOCATION MAP
(NOT TO SCALE)

EAST 1/4 CORNER SECTION 9, T3P, VAN BUREN TWP, WAYNE CO, MI

PARCEL 1
83-033-99-0002-000
(SEE SHEET 2)

N 89° 05'02" E 1216.28'
538.77'

SHEET 2
SHEET 1

N 89° 05'02" E 489.51'
S 89° 05'40" W (R.) 188.00'

S 00° 48'20" E 492.72' (M.)
S 00° 28'21" E 758.87'

S 00° 28'20" W 756.19'

N 89° 37'10" E 300.00'

N 00° 48'20" W 1697.92' (M.)
1698.66' (R.)
N 00° 48'20" W 2699.71'

N 88° 45'59" E 180.01'

N 89° 37'10" E 193.82'

Terms and Conditions for Electronic Data:
This document is provided in electronic form for the reference of the client. It is the client's responsibility to ensure that the data is accurate and complete. The client agrees that the electronic data provided by Giffels-Webster Engineers, Inc. is for informational purposes only and does not constitute a warranty. The client agrees to hold Giffels-Webster Engineers, Inc. harmless from any and all claims, damages, losses, and expenses, including reasonable attorneys' fees, arising from the use of the electronic data. The client agrees to indemnify and hold Giffels-Webster Engineers, Inc. harmless from any and all claims, damages, losses, and expenses, including reasonable attorneys' fees, arising from the use of the electronic data. The client agrees to hold Giffels-Webster Engineers, Inc. harmless from any and all claims, damages, losses, and expenses, including reasonable attorneys' fees, arising from the use of the electronic data. The client agrees to hold Giffels-Webster Engineers, Inc. harmless from any and all claims, damages, losses, and expenses, including reasonable attorneys' fees, arising from the use of the electronic data.



PRINCIPAL: R.D.K.
PROJ. MNGR: C.A.A.
DESIGN: H.S.R.
DRAWN: H.S.R.
IND. REVIEW: C.A.A.
SECTION: 09 T- 3-N,R-08-E

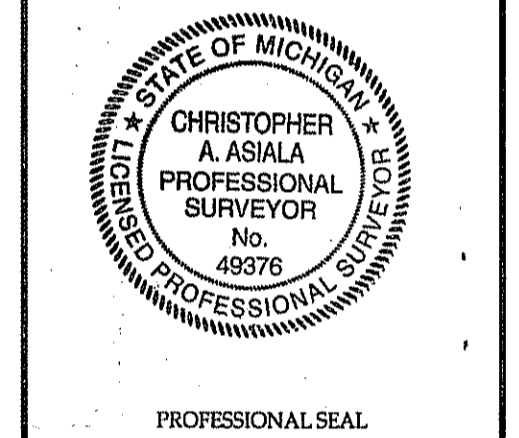

DEVELOPED FOR:
THE ESTATE OF F. WILLIAM CARR
C/O COLLIER'S INTERNATIONAL
2 CORPORATE DRIVE
SUITE 300
SOUTHFIELD
MI 48016
(248) 226-1820

GWE
Giffels-Webster
Engineers, Inc.
ENGINEERS-LAND SURVEYORS
PLANNERS-LANDSCAPE ARCHITECTS
2871 BOND STREET
ROCHESTER HILLS, MI 48309
PHONE (248) 852-3100
FAX (248) 852-3772
107 E. FORT STREET, SUITE 600
DETROIT, MI 48226
PHONE (313) 962-4442
FAX (313) 962-5068
6309 28 MILE ROAD, SUITE 100
WASHINGTON, MI 48094
PHONE (586) 781-8850
FAX (586) 781-8851
EMAIL: info@giffelswebster.com
www.giffelswebster.com

SHEET TITLE:
ALTA/ACSM
SURVEY
SECTION 9

VAN BUREN TOWNSHIP,
WAYNE COUNTY, MI.

UTILITY STATEMENT
THE UNDERGROUND UTILITIES SHOWN HAVE BEEN LOCATED FROM FIELD SURVEY INFORMATION AND EXISTING DRAWINGS. THE SURVEYOR MAKES NO GUARANTEES THAT THE UNDERGROUND UTILITIES SHOWN COMPRISE ALL SUCH UTILITIES IN THE AREA, EITHER IN SERVICE OR ABANDONED. THE SURVEYOR FURTHER DOES NOT WARRANT THAT THE UNDERGROUND UTILITIES SHOWN ARE IN THE EXACT LOCATION INDICATED ALTHOUGH HE DOES CERTIFY THAT THEY ARE LOCATED AS ACCURATELY AS POSSIBLE FROM INFORMATION AVAILABLE.
(R) - UTILITY SHOWN FROM RECORDS OR PLANS, & FIELD LOCATED WHERE POSSIBLE.
PRIOR TO THE PLANNED BUILDING IMPROVEMENTS, AND/OR CONSTRUCTION, THE RESPECTIVE UTILITY COMPANIES MUST BE NOTIFIED TO STAKE THE PRECISE LOCATION OF THEIR UTILITIES.
DATE: 05/18/07
SCALE: 1"=100'
SHEET: 1 OF 2
JOB: 17473.00
Copyright © 2007 Giffels-Webster Engineers, Inc. No reproduction shall be made without the prior written consent of Giffels-Webster Engineers, Inc.