



For sublease

530 S Main Street, Orange, CA

2,225 - 12,553 RSF Available

 **JLL** SEE A BRIGHTER WAY

Property Highlights

Location	530 S Main Street
Size	Suite 105: 2,225 RSF Suite 110: 4,568 RSF 2nd Floor: 2,797 - 12,553 RSF
Rate	Negotiable
Term	Thru December 31, 2028
Amenities	<ul style="list-style-type: none">• Close to Main Place Mall, CHOC and Providence St. Joseph Hospital and many dining options



Suite 105: 2,225 RSF

Suite 110: 4,568 RSF

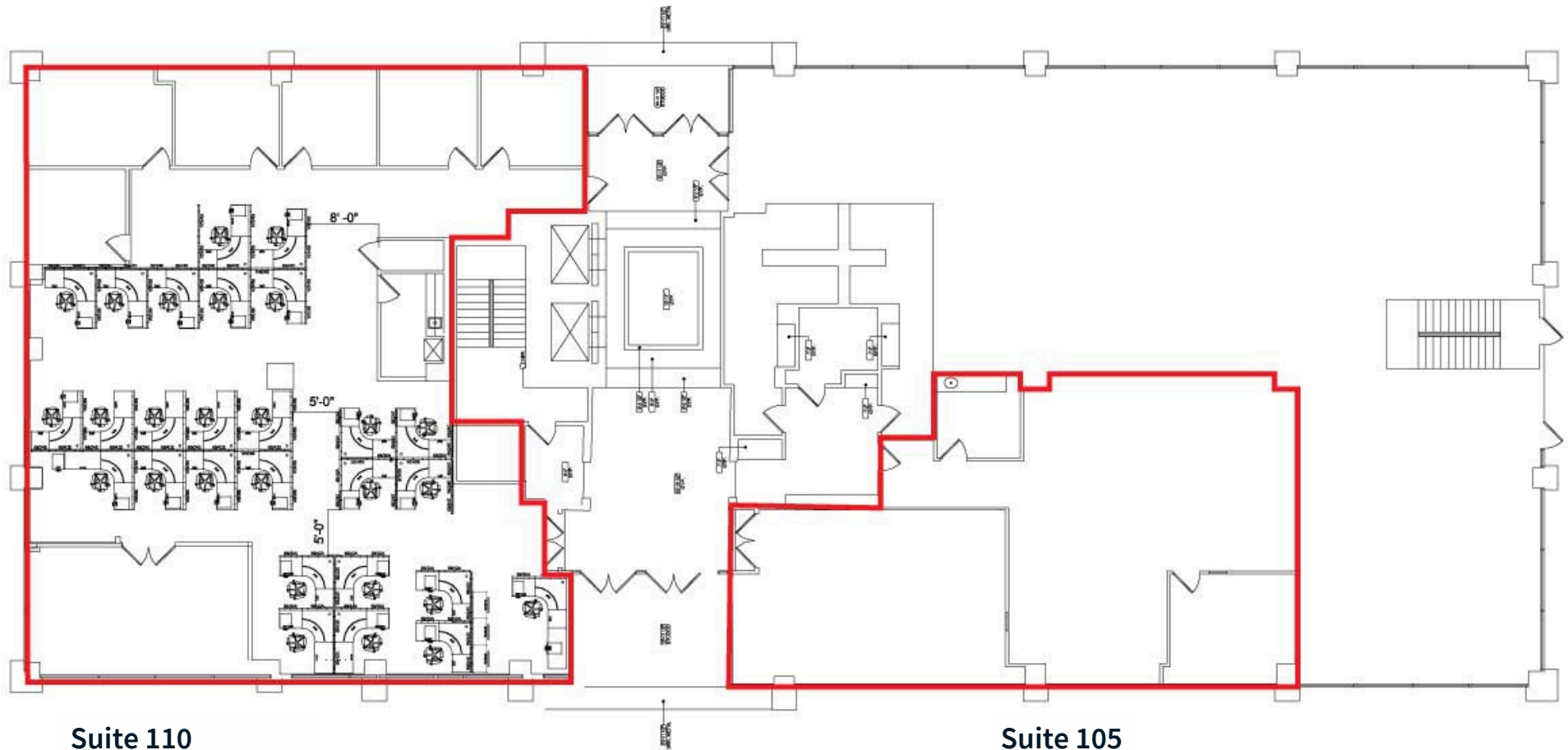

Suite 110

Suite 105

- 27 workstations
- 6 offices
- 1 conference room
- 1 break area

2nd Floor: 2,797 - 12,553 RSF

Suite 2B: 1,238 RSF

Suite 2C: 3,332 RSF

- 59 workstations
- 1 office

Suite 2E: Server (115 RSF)

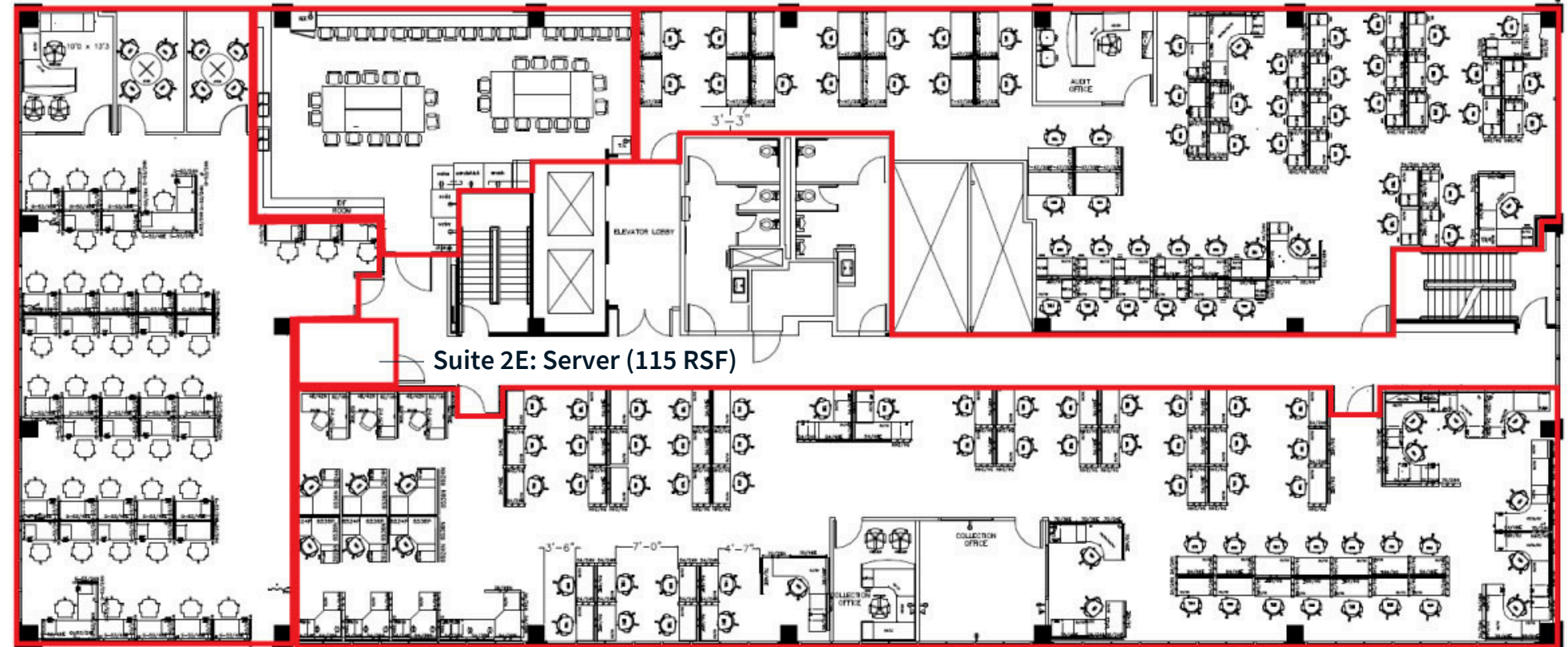

Suite 2A: 2,797 RSF

- 43 workstations

Suite 2D: 5,071 RSF

- 81 workstations
- 2 offices

Amenities



Main Place Mall

- california PIZZA KITCHEN
- Applebee's GRILL + BAR
- THE CITY SQUARE PHARMACY
- PANDA EXPRESS CHINESE KITCHEN
- WELLS FARGO
- Wetzel's Pretzels
- BOUDIN SEA FRESH OYSTERS & SEAFOOD
- Mia Field's
- CINNABON
- Johnny Rockets
- ROUND1
- BANK OF AMERICA
- 24 FITNESS



Main Plaza

- CVS pharmacy
- LOGO'S
- TACO BELL
- Carto's Jr.
- Anepalco
- POKE TIKO
- BASKIN BR ROBBINS
- Simply phở
- NGUYEN'S KITCHEN

Town & Country

- Joey Mib's
- Benji's
- Starbucks
- SUBWAY
- rubios
- Jamba
- FLAME & BROILER
- ROSS
- Party City

City Place

- Olive Garden
- MOTHER'S
- corner bakery CAFE
- Habit BURGER GRILL

JLL**Jason Lantgen**

Managing Director

License #: CA - 0189454

jason.lantgen@jll.com

+1 949 885 2946

Jeff Ingham

Senior Managing Director

License #: CA - 01201557

jeffrey.ingham@jll.com

+1 949 885 2990

Jones Lang LaSalle Brokerage, Inc. | CA License #01856260