



# For Sublease

## Prominence

3475 Piedmont Road NE  
Atlanta, GA 30305

## Class A Office Space Now Available

- Suite 1000
- 23,748 RSF
- Rate: Negotiable
- Term: thru September 30, 2021
- High-end furniture available
- Above standard building cafe
- Fitness center
- Shared conference center
- Short walk to Buckhead MARTA station

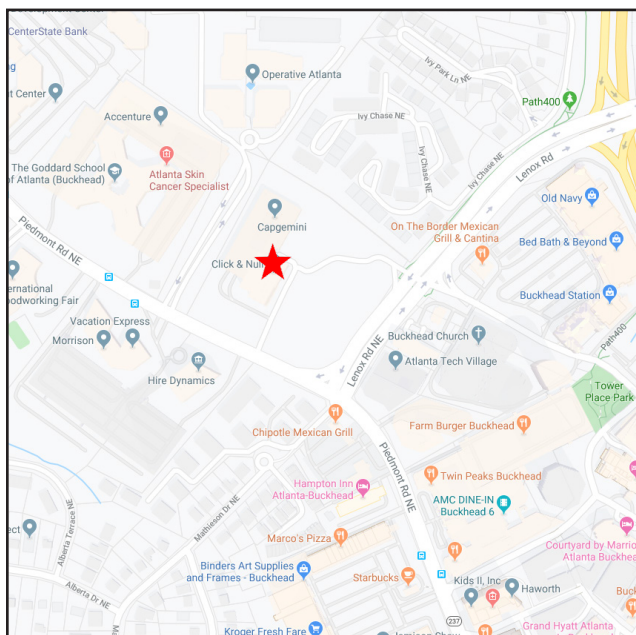

**Brooke Gothard**  
+1 404 995 6330  
brooke.gothard@am.jll.com



### DISCLAIMER

Jones Lang LaSalle © 2019 Jones Lang LaSalle IP, Inc. All rights reserved. All information contained herein is from sources deemed reliable; however, no representation or warranty is made to the accuracy thereof.



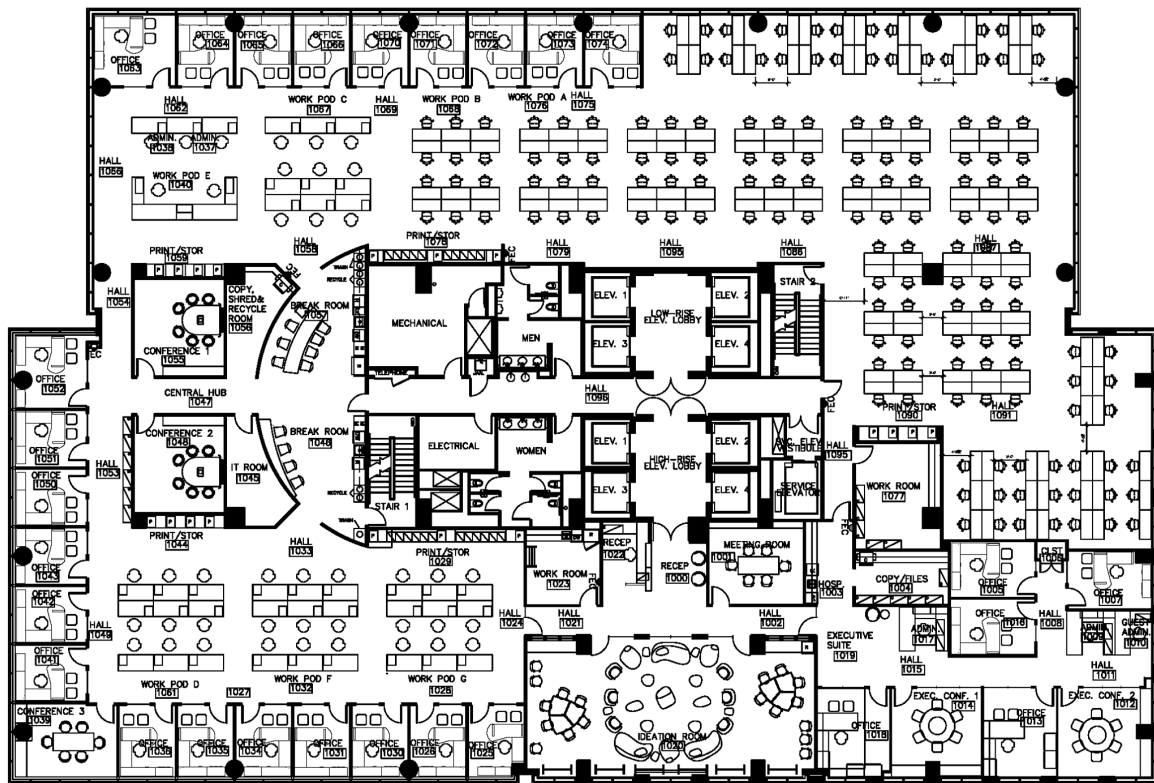

**Brooke Gothard**  
+1 404 995 6330  
[brooke.gothard@am.jll.com](mailto:brooke.gothard@am.jll.com)



**DISCLAIMER**

Jones Lang LaSalle © 2019 Jones Lang LaSalle IP, Inc. All rights reserved. All information contained herein is from sources deemed reliable; however, no representation or warranty is made to the accuracy thereof.