

250 SOUTH OAK WAY

4,594-7,655 SQ FT



GreenPark 
a mapletree property



250 SOUTH OAK WAY

250 South Oak Way is a stylish headquarters building with feature glass elevations.

This modern, sensitively designed building has plenty of outside space, including a completely remodelled entrance and atrium, to give a sense of community. Transport facilities are particularly good, with ample parking and bicycle racks.



SPECIFICATION INCLUDES

- VRF air conditioning
- Full access raised floors
- Suspended ceiling
- Showers and bike racks
- Two x 1,000kg capacity passenger lifts
- Manned reception
- 24 hour security on the Park
- EPC – D (94)

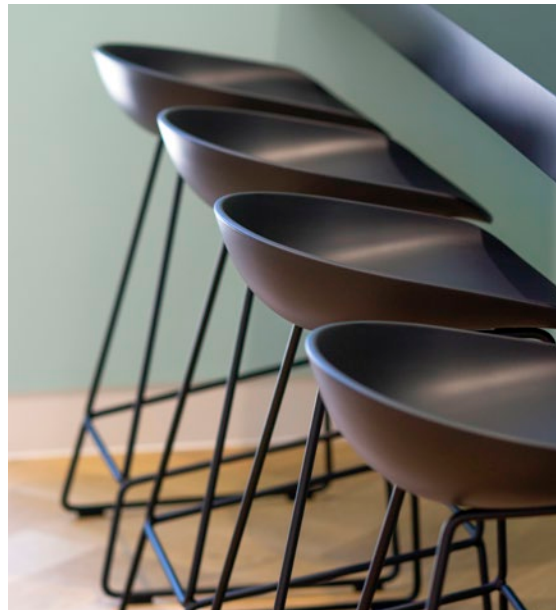

AVAILABLE SPACE



| Schedule of availability | | sq ft | sq m | Parking |
|--------------------------|----------|---------------|--------------|-----------|
| Second floor | Suite 25 | 4,594 | 427 | 16 |
| Ground floor | Suite 7 | 7,655 | 711 | 24 |
| Ground floor | Suite 1 | 4,811 | 447 | 15 |
| Total | | 17,060 | 1,585 | 55 |

Current occupiers of 250 South Oak Way



Second floor

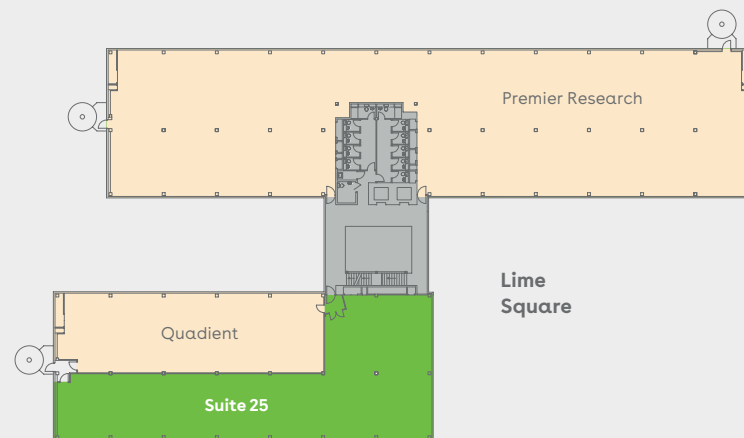

First floor

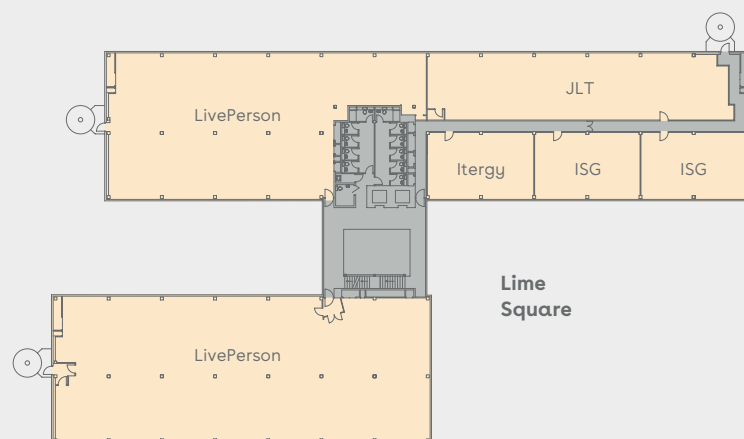

Office space to let
 Let

Ground floor

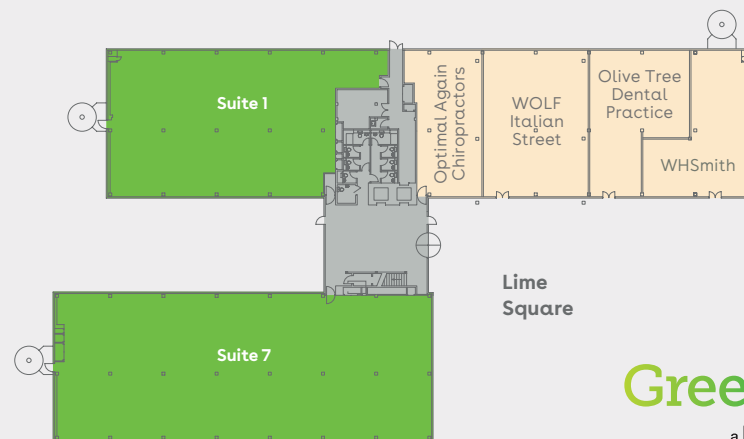

For indicative purposes only. Not to scale.

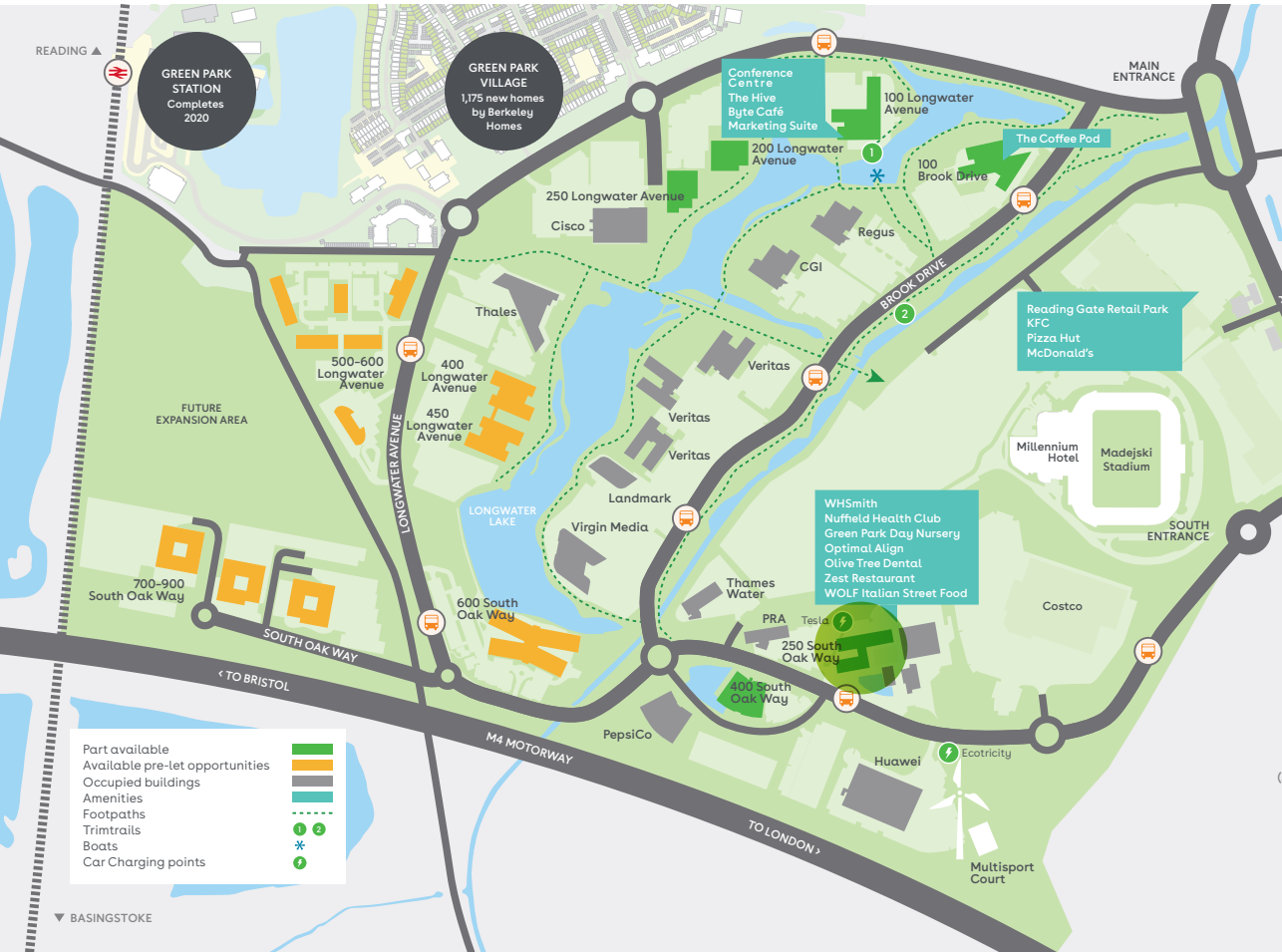

Charles Dady
+44 (0)20 7152 5273
+44 (0)7793 808 273

Henry Harrison
+44 (0)20 7152 5403
+44 (0)7785 222 430

Cameron Frazer
+44 (0)20 7152 5425
+44 (0)7710 965 302



Keith Wise
+44 (0)118 959 7555
+44 (0)7802 946 166

Duncan Campbell
+44 (0)118 959 7555
+44 (0)782 734 1503

Find out more about bringing your business to Green Park. Contact our appointed leasing agents or visit: greenpark.co.uk

These particulars are not an offer or contract, nor part of one. Any information given is entirely without responsibility or warranty whatsoever. March 2020.