



# RIDGEVIEW OFFICE CENTER

4207 BOULDER RIDGE RD  
BISMARCK, ND 58503

---

**CHUCK HUBER, COMMERCIAL REALTOR®**  
Broker Associate | Advisor  
701.391.9575  
[chuck@thecragroup.com](mailto:chuck@thecragroup.com)

FOR LEASE



# RIDGEVIEW OFFICE CENTER

4207 BOULDER RIDGE RD BISMARCK, ND 58503



## OFFERING SUMMARY

Lease Rate:	\$1,495.00 per month (Full Service)
Building Size:	27,667 SF
Available SF:	876 SF
Lot Size:	90,094 SF
Year Built:	2013
Zoning:	RT
Tenant Responsibility:	janitorial services for interior of leased premises
Landlord Responsibility:	Landlord pays for all operating expenses including utilities.

## PROPERTY OVERVIEW

First floor office spaces with high quality finishing and efficient layout. Easy access to major streets and highways. Exterior is well-lit and very visible to passing vehicles.

## PROPERTY HIGHLIGHTS

- Front door key card security system
- Video security system (indoor & outdoor monitoring)
- Large windows throughout building
- Located near major roads
- Office furniture is available



**CHUCK HUBER, COMMERCIAL REALTOR®**

Broker Associate | Advisor  
701.391.9575  
chuck@thecragroup.com

FOR LEASE



# SUITE 125

4207 BOULDER RIDGE RD BISMARCK, ND 58503

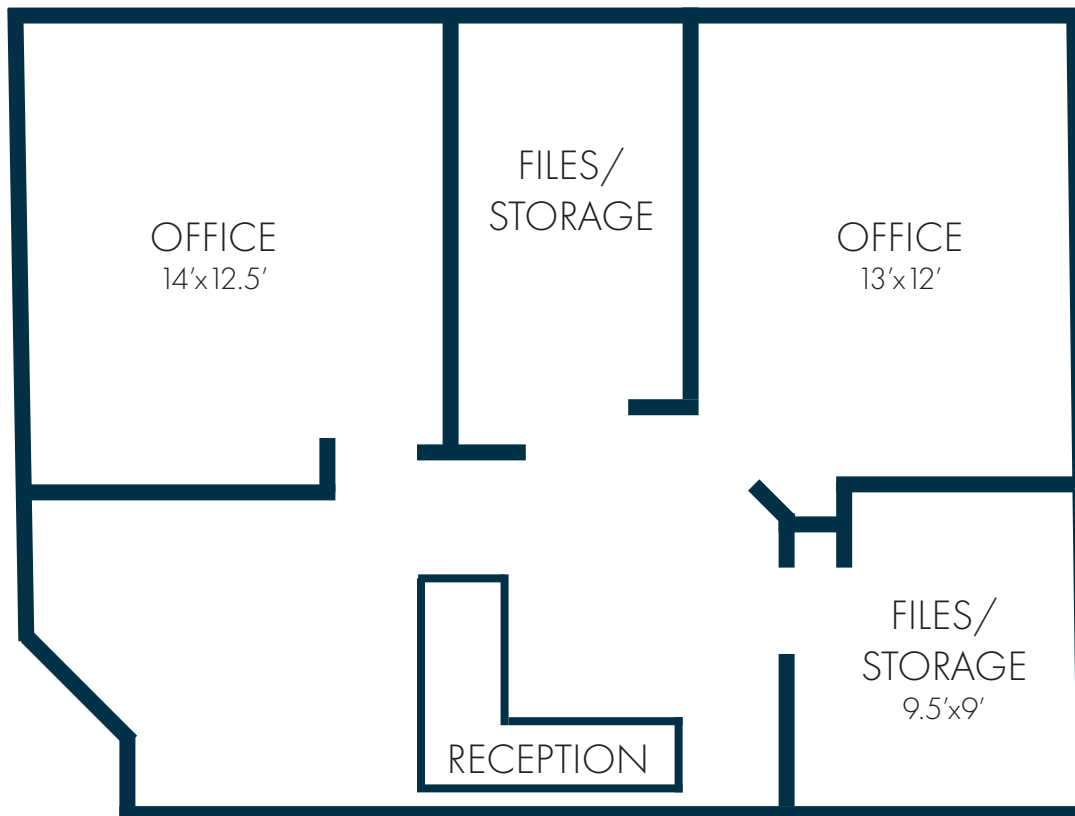

*\*INTENDED FOR VISUAL PURPOSE ONLY  
\*SOME DETAILS MAY NOT BE TO SCALE*

## FEATURES:

- (2) private offices
- Breakroom
- Cubicle or file area
- Office furniture negotiable



**CHUCK HUBER, COMMERCIAL REALTOR®**

Broker Associate | Advisor  
701.391.9575  
chuck@thecragroup.com

FOR LEASE



# SUITE 125

4207 BOULDER RIDGE RD BISMARCK, ND 58503



**CHUCK HUBER, COMMERCIAL REALTOR®**

Broker Associate | Advisor

701.391.9575

[chuck@thecragroup.com](mailto:chuck@thecragroup.com)

FOR LEASE



# SUITE 125

4207 BOULDER RIDGE RD BISMARCK, ND 58503



**CHUCK HUBER, COMMERCIAL REALTOR®**

Broker Associate | Advisor

701.391.9575

[chuck@thecragroup.com](mailto:chuck@thecragroup.com)

FOR LEASE



# RIDGEVIEW OFFICE CENTRE SUITES

4207 BOULDER RIDGE RD BISMARCK, ND 58503



CHUCK HUBER, COMMERCIAL REALTOR®

Broker Associate | Advisor

701.391.9575

chuck@thecragroup.com

# BUILDING RELATIONSHIPS. BUILDING THE COMMUNITY.™



**CHUCK HUBER, COMMERCIAL  
REALTOR®**

Broker Associate | Advisor

701.391.9575

chuck@thecragroup.com

## STAY IN TOUCH



@THECRAGROUP



@THECRAGROUP



THE CRA GROUP

# THE CRAGROUP.com

THE CRA GROUP | 216 N 2ND ST | BISMARCK, ND 58501

Although information has been obtained from sources deemed reliable, neither Owner nor CRA makes any guarantees, warranties, or representations, express or implied, as to the completeness or accuracy as to the information contained herein. You should conduct a careful, independent investigation of the property and verify all information. Any reliance on this information is solely at your own risk. The Property may be withdrawn without notice. Neither Owner nor CRA accepts any liability for any loss or damage suffered by any party resulting from reliance on this information. Photos, logos, and other images herein are the property of their respective owners. Use of these images without the express written consent of the owner is prohibited.