

TRACT 7: BUILDING AREA = 60,360 SF  
 PARKING SPACES PROVIDED FOR A 5.5 RATIO = 332

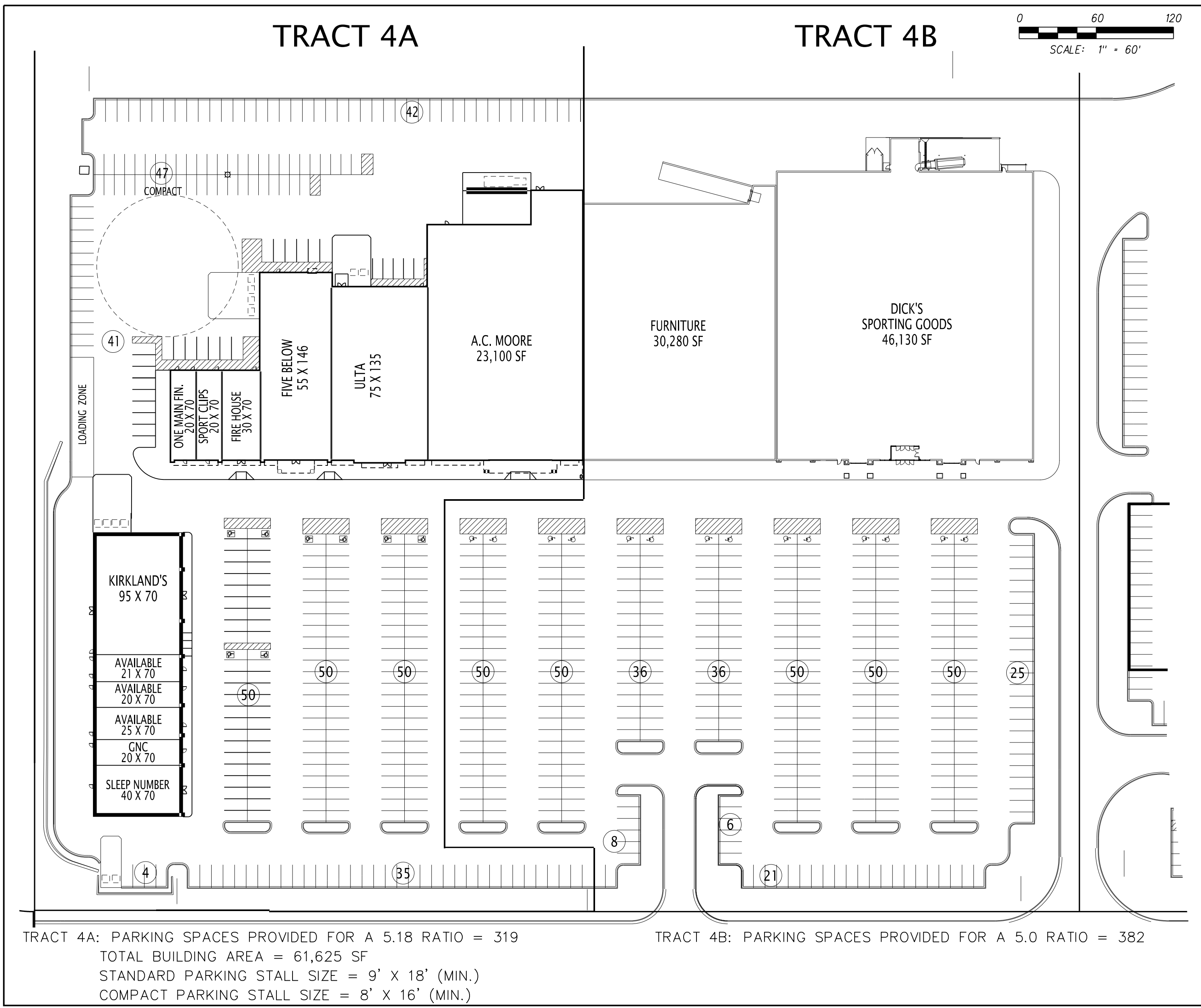

TRACT 4A: PARKING SPACES PROVIDED FOR A 5.18 RATIO = 319  
 TOTAL BUILDING AREA = 61,625 SF  
 STANDARD PARKING STALL SIZE = 9' X 18' (MIN.)  
 COMPACT PARKING STALL SIZE = 8' X 16' (MIN.)

TRACT 4B: PARKING SPACES PROVIDED FOR A 5.0 RATIO = 382

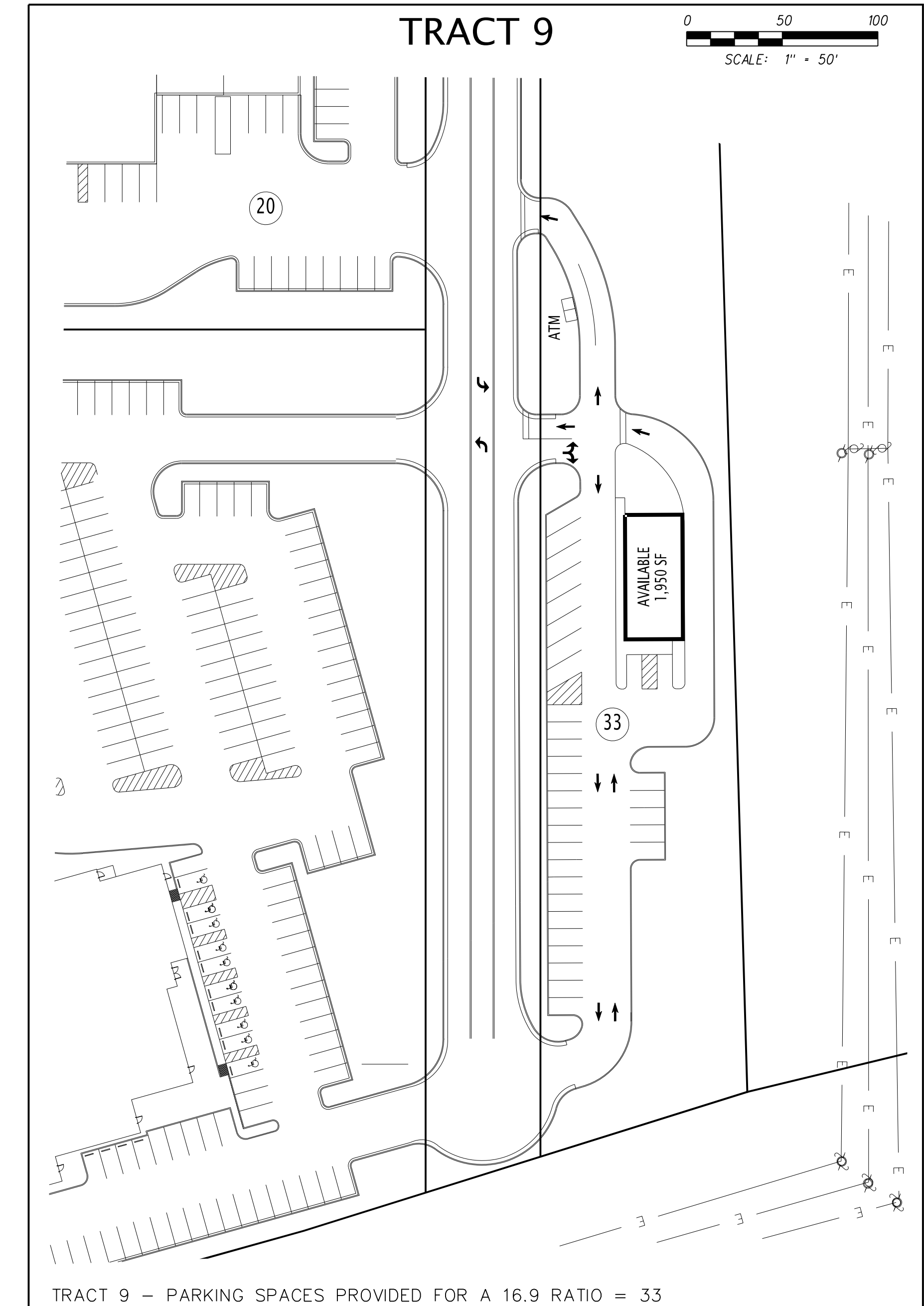

TRACT 9 - PARKING SPACES PROVIDED FOR A 16.9 RATIO = 33

NOTE: THIS SITE PLAN INDICATES THE GENERAL LAYOUT OF THE SHOPPING CENTER AND IS NOT A WARRANTY, REPRESENTATION, OR AGREEMENT ON THE PART OF THE LANDLORD THAT THE SHOPPING CENTER WILL BE EXACTLY AS DEPICTED HEREIN.



EXHIBIT

UNIVERSITY TOWN CENTRE  
 COUNTY ROUTE 19/24 AND INTERSTATE 79  
 GRANVILLE, WEST VIRGINIA

OVERALL SITE PLAN

MOUNTAINEER PROPERTY, LLC  
 2151 VOLUNTEER PARKWAY  
 BRISTOL, TENNESSEE 37620  
 423.968.5971 WWW.IRA-REALETY.COM

PROJ. NO.	DESIGNED BY	DRAWN BY	No.	Date
Project	411.004	Sheet	CSP-035	
Date	3/26/15	Scale	1"=200'	

©2015 FULGHUM MACINDOE & ASSOCIATES, INC. THIS DOCUMENT SHALL NOT BE LOANED, COPIED, REPRODUCED, TRANSFERRED TO ANOTHER PARTY OR SOLD AND IS WARRANTED AS AN INSTRUMENT OF SERVICE AND SHALL RETAIN ALL COMMON LAW STATUTORY AND OTHER RESERVED RIGHTS, INCLUDING THE COPYRIGHT.