

For Sale

6 Acres Land +/-



Tiedeman & I-480 Land Brooklyn, Ohio

Property Features

- Approximately 6 acres with 4 acres of buildable land
- \$250,000 per acre
- Zoned light industrial
- Located at the busy NE corner of Tiedeman & I-480 Interchange
- Across from the Plain Dealer
- Traffic count: I-480: 124,851 ADT
- Traffic count: Tiedeman: 22,269 ADT

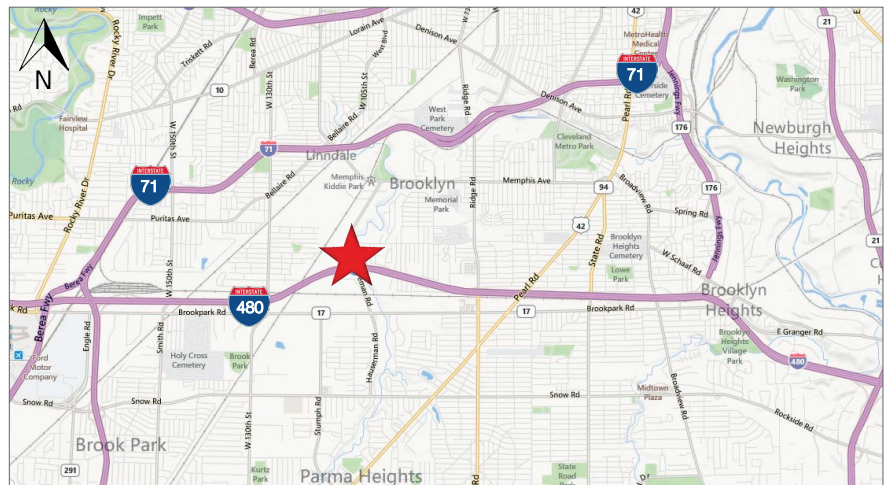

Demographics	1 Mile	3 Miles	5 Miles
Population	8,403	133,294	348,404
Daytime Population	10,758	63,314	169,742
Avg. Household Income	\$43,275	\$49,636	\$49,792

Jeffrey M. Kahn, President

216 455 0900 | jkahn@naidaus.com

Gerilyn Gleason, Sales Associate

216 455 0916 | ggleason@naidaus.com

[E](#) @GerilynGleason

NO WARRANTY OR REPRESENTATION, EXPRESS OR IMPLIED, IS MADE AS TO THE ACCURACY OF THE INFORMATION CONTAINED HEREIN, AND THE SAME IS SUBMITTED SUBJECT TO ERRORS, OMISSIONS, CHANGE OF PRICE, RENTAL OR OTHER CONDITIONS, PRIOR SALE, LEASE OR FINANCING, OR WITHDRAWAL WITHOUT NOTICE, AND OF ANY SPECIAL LISTING CONDITIONS IMPOSED BY OUR PRINCIPALS NO WARRANTIES OR REPRESENTATIONS ARE MADE AS TO THE CONDITION OF THE PROPERTY OR ANY HAZARDS CONTAINED THEREIN ARE ANY TO BE IMPLIED.

23240 Chagrin Blvd. Ste. 250
Cleveland, Ohio 44122
216 831 3310

naidaus.com

Aerial



Tiedeman & I-480 Land
Brooklyn, Ohio

Jeffrey M. Kahn, President
216 455 0900
jkahn@naid.us.com

Gerilyn Gleason, Sales Associate
216 455 0916
ggleason@naid.us.com



Business Property Specialists Inc. Broker

23240 Chagrin Blvd. Ste. 250
Cleveland, Ohio 44122
216 831 3310
naid.us.com