

# KORN WALKER BLOCK RETAIL

RETAIL FOR LEASE

Yesler Way and Occidental Avenue S, in Pioneer Square  
Seattle, WA 98104



Kara Farley | Blake Taylor

**WCCR**

West Coast Commercial Realty

# KORN WALKER BLOCK RETAIL

## RETAIL FOR LEASE

Yesler Way and Occidental Avenue S, in Pioneer Square  
Seattle, WA 98104

### OPPORTUNITY

The Korn Walker Block is a collection of eight historic buildings located in Seattle's Pioneer Square District, positioned at the northern gateway to Occidental Avenue. Several street-level retail and restaurant spaces are now available for lease, directly north of popular destination, Occidental Park. Interested businesses can take advantage of 2nd generation infrastructure, which includes two type 1 hood vented former restaurant and music venue/bar spaces. Become part of the reinvigorated pedestrian experience on Occidental Avenue by joining the current Korn Walker Block businesses, which include Lady Yum, Meyers Bar, Merchant Cafe, I Heart Sushi, and Trinity Nightclub.



Kara Farley | Blake Taylor

(206) 283-5212  
www.wccommercialrealty.com

# WCCR

West Coast Commercial Realty

DISCLAIMER: The above information has been secured from sources believed to be reliable, however, no representations are made to its accuracy. Prospective tenants or buyers should consult their professional advisors and conduct their own independent investigation. Site plan and configuration are subject to change. Properties are subject to change in price and/or availability without notice. West Coast Commercial Realty, LLC

# KORN WALKER BLOCK RETAIL

## RETAIL FOR LEASE

Yesler Way and Occidental Avenue S, in Pioneer Square  
Seattle, WA 98104

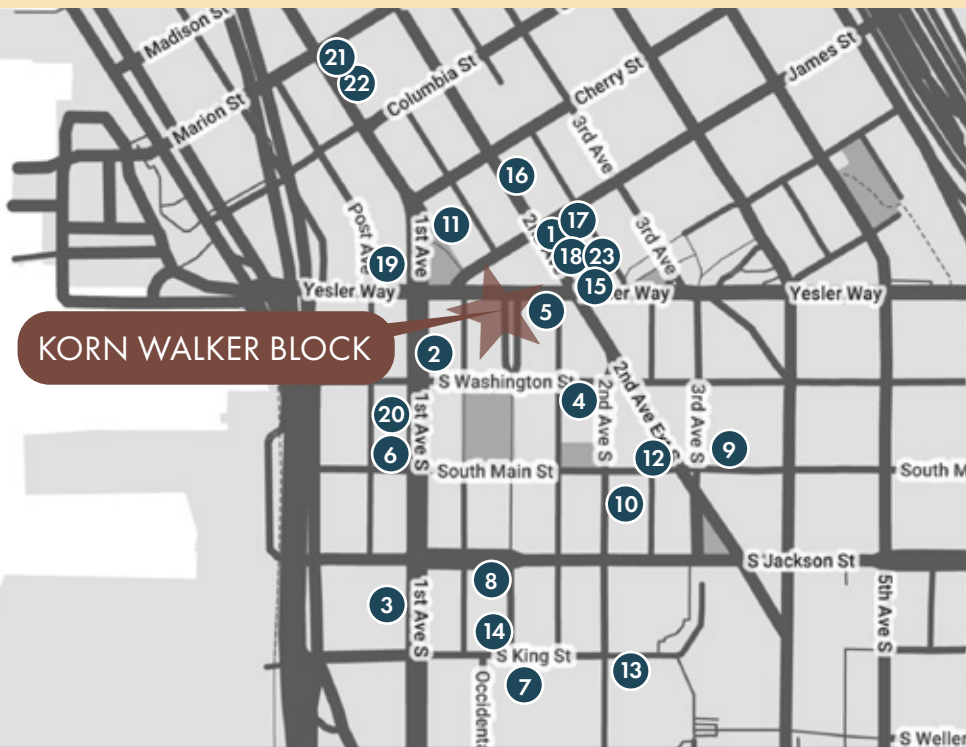

**KORN WALKER BLOCK**

### Pioneer Square Neighborhood

- |                                    |   |
|------------------------------------|---|
| 1. Collins Pub                     | 13. 13 Coins  |
| 2. Damn the Weather                | 14. Quality Athletics                               |
| 3. Il Terrazzo Carmine             | 15. Smith Tower Observatory                         |
| 4. McCoy's Firehouse Bar & Grill   | 16. Courtyard by Marriott                           |
| 5. Tat's Deli                      | 17. Gary Manuel Salon                               |
| 6. Ohsun                           | 18. The Works                                       |
| 7. Cone & Steiner                  | 19. 84 Yesler Seafood                               |
| 8. Stonington Gallery              | 20. Central Saloon                                  |
| 9. Foster/White Gallery            | 21. Bar Solea                                       |
| 10. The Marble Room                | 22. Café Hitchcock                                  |
| 11. Bill Speidels Underground Tour | 23. Shawn O'Donnell's<br>American Grill & Irish Pub |
| 12. Flatstick Pub                  |   |



Kara Farley | Blake Taylor

(206) 283-5212  
www.wcccommercialrealty.com

# WCCR

West Coast Commercial Realty

DISCLAIMER: The above information has been secured from sources believed to be reliable, however, no representations are made to its accuracy. Prospective tenants or buyers should consult their professional advisors and conduct their own independent investigation. Site plan and configuration are subject to change. Properties are subject to change in price and/or availability without notice. West Coast Commercial Realty, LLC

# KORN WALKER BLOCK RETAIL

## RETAIL FOR LEASE

Yesler Way and Occidental Avenue S, in Pioneer Square  
Seattle, WA 98104



### DEMOGRAPHICS



#### AVERAGE HOUSEHOLD INCOME

1-Mile: \$112,630  
2-Mile: \$125,580  
5-Mile: \$135,280



#### TOTAL POPULATION

1-Mile: 50,782  
2-Mile: 176,970  
5-Mile: 493,296



#### TOTAL EMPLOYEES

1-Mile: 50,782  
2-Mile: 176,970  
5-Mile: 493,296



Kara Farley | Blake Taylor

(206) 283-5212  
[www.wcccommercialrealty.com](http://www.wcccommercialrealty.com)

# WCCR

West Coast Commercial Realty

DISCLAIMER: The above information has been secured from sources believed to be reliable, however, no representations are made to its accuracy. Prospective tenants or buyers should consult their professional advisors and conduct their own independent investigation. Site plan and configuration are subject to change. Properties are subject to change in price and/or availability without notice. West Coast Commercial Realty, LLC

# KORN WALKER BLOCK RETAIL

## MAIN LEVEL FLOOR PLAN

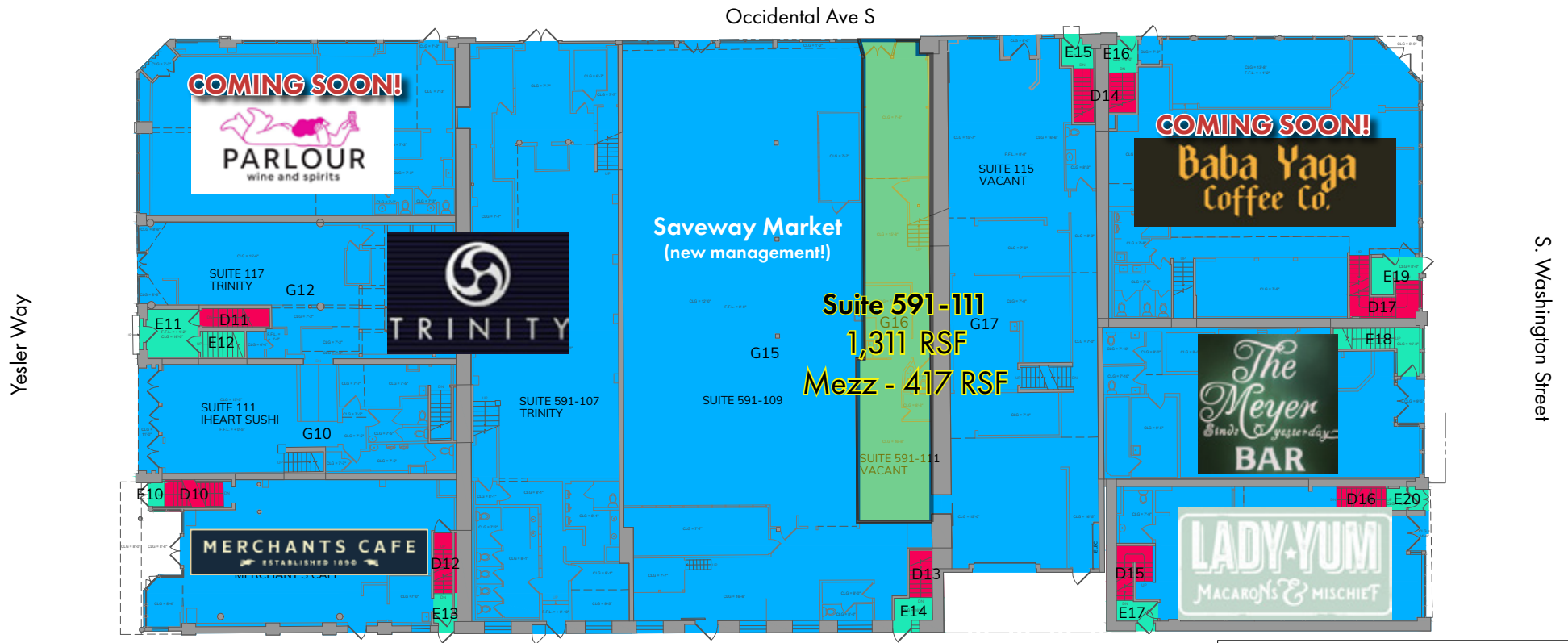

Kara Farley | Blake Taylor

(206) 283-5212  
www.wccommercialrealty.com

# WCCR

West Coast Commercial Realty

DISCLAIMER: The above information has been secured from sources believed to be reliable, however, no representations are made to its accuracy. Prospective tenants or buyers should consult their professional advisors and conduct their own independent investigation. Site plan and configuration are subject to change. Properties are subject to change in price and/or availability without notice. West Coast Commercial Realty, LLC

# KORN WALKER BLOCK RETAIL

## RETAIL FOR LEASE

Yesler Way and Occidental Avenue S, in Pioneer Square  
Seattle, WA 98104

111 Occidental Avenue S  
Suite 591-111  
**1,311 RSF**  
Mezzanine – **417 RSF**

Occidental Ave S

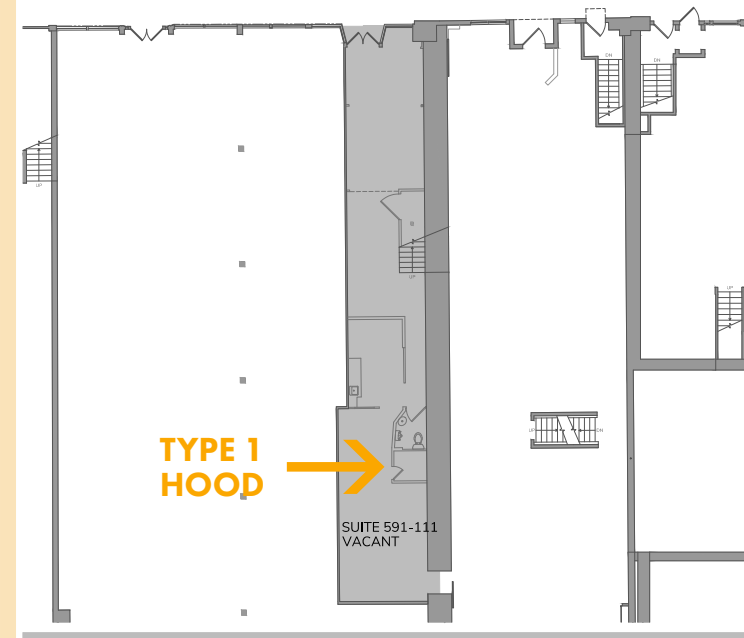

# WCCR

West Coast Commercial Realty

Kara Farley | Blake Taylor

(206) 283-5212  
www.wccommercialrealty.com



DISCLAIMER: The above information has been secured from sources believed to be reliable, however, no representations are made to its accuracy. Prospective tenants or buyers should consult their professional advisors and conduct their own independent investigation. Site plan and configuration are subject to change. Properties are subject to change in price and/or availability without notice. West Coast Commercial Realty, LLC

# KORN WALKER BLOCK RETAIL

RETAIL FOR LEASE

Yesler Way and Occidental Avenue S, in Pioneer Square  
Seattle, WA 98104



**PIONEER SQUARE  
SEATTLE'S ORIGINAL NEIGHBORHOOD**



Kara Farley | Blake Taylor

(206) 283-5212  
[www.wccommercialrealty.com](http://www.wccommercialrealty.com)

**WCCR**

West Coast Commercial Realty

DISCLAIMER: The above information has been secured from sources believed to be reliable, however, no representations are made to its accuracy. Prospective tenants or buyers should consult their professional advisors and conduct their own independent investigation. Site plan and configuration are subject to change. Properties are subject to change in price and/or availability without notice. West Coast Commercial Realty, LLC