



SITE ADDRESS:
1000 S Industrial Blvd | Euless, TX 76040



[PROPERTY OVERVIEW](#)

[ABOUT UD183](#)

[MASTER SITE PLAN](#)

[GET DIRECTIONS](#)



the Evolution of Industrial

DELIVERING Q2 2022

PROPERTY NAVIGATION

MASTER SITE PLAN

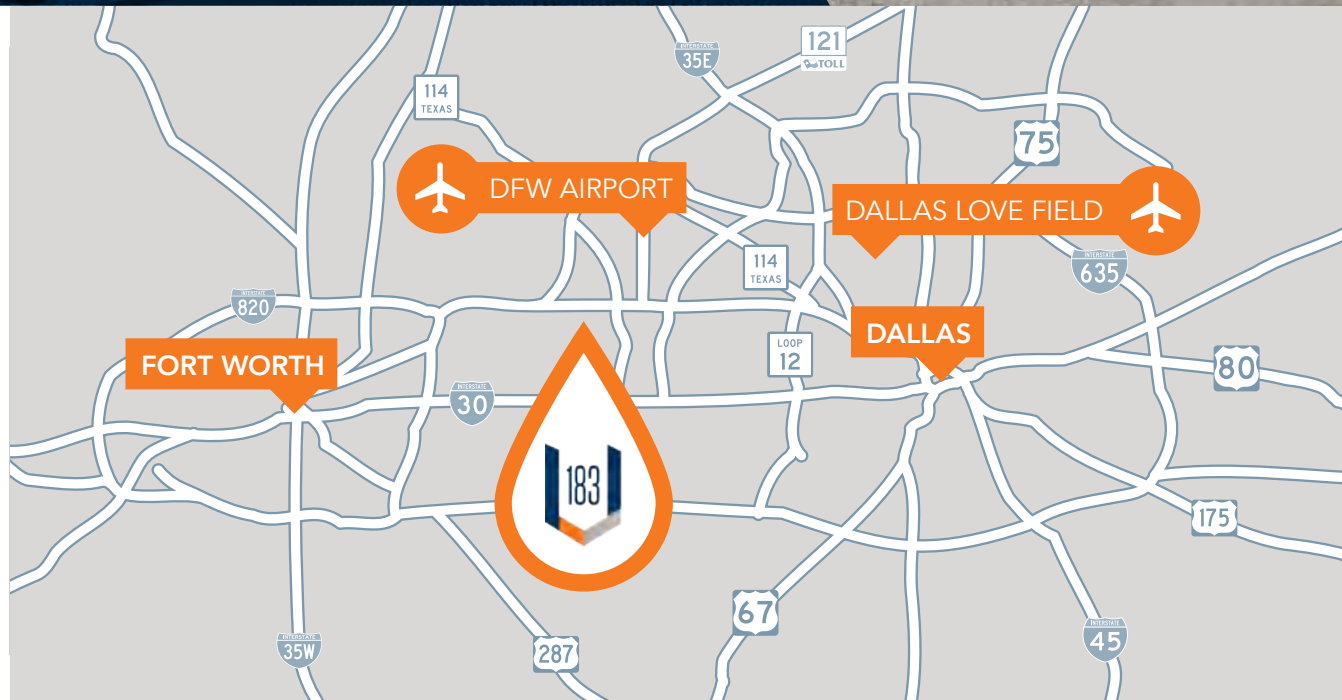
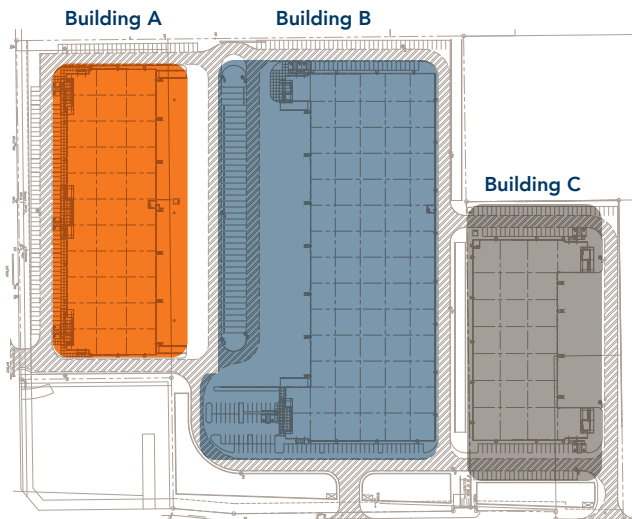



SITE ADDRESS:
 1000 S Industrial Blvd | Euless, TX 76040



[PROPERTY OVERVIEW](#)

[ABOUT UD183](#)

[MASTER SITE PLAN](#)

[GET DIRECTIONS](#)

Urban District 183 is a 3-building, 367,771-square-foot Class A industrial development strategically located in the center of the Metroplex. Just south of 183 in Euless of Industrial Blvd, the project is less than 4 miles from the South end of DFW Airport, and has immediate access to I30 from Industrial Blvd. Given the infill, central location, the project has access to both Fort Worth and Dallas' Tenant and Labor base.

- 3 Buildings
- 366,771 SF
- 15,000 – 191,010 SF available
- Q2 2022 delivery
- 8.3 miles to DFW airport
- 17.4 miles to Love Field.
- 15.6 miles to Fort Worth Central Business District
- 20.1 miles to Dallas Central Business District

the Evolution of Industrial

PROPERTY NAVIGATION

MASTER SITE PLAN

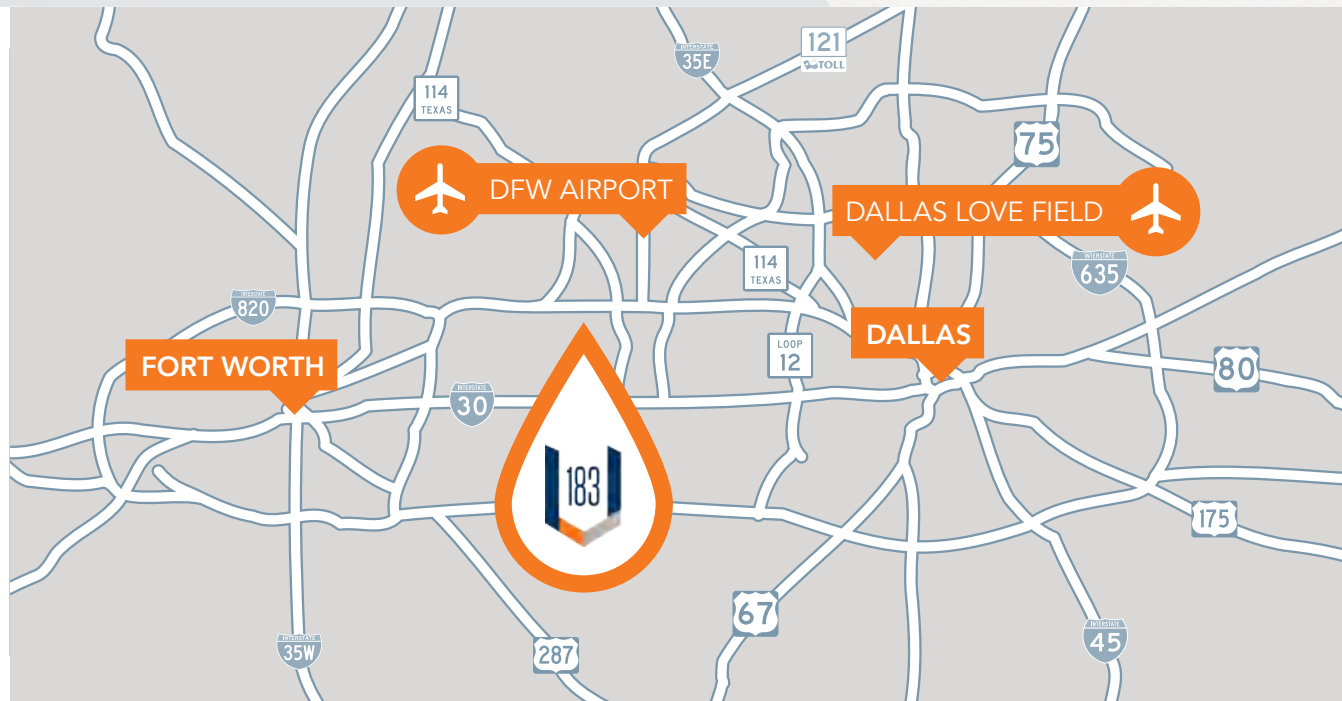
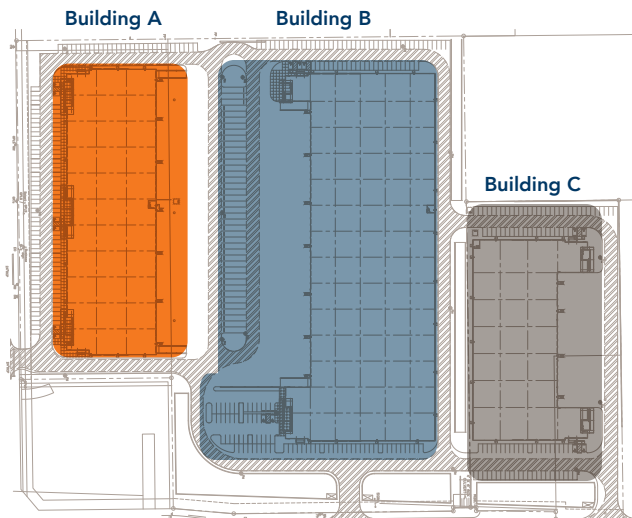

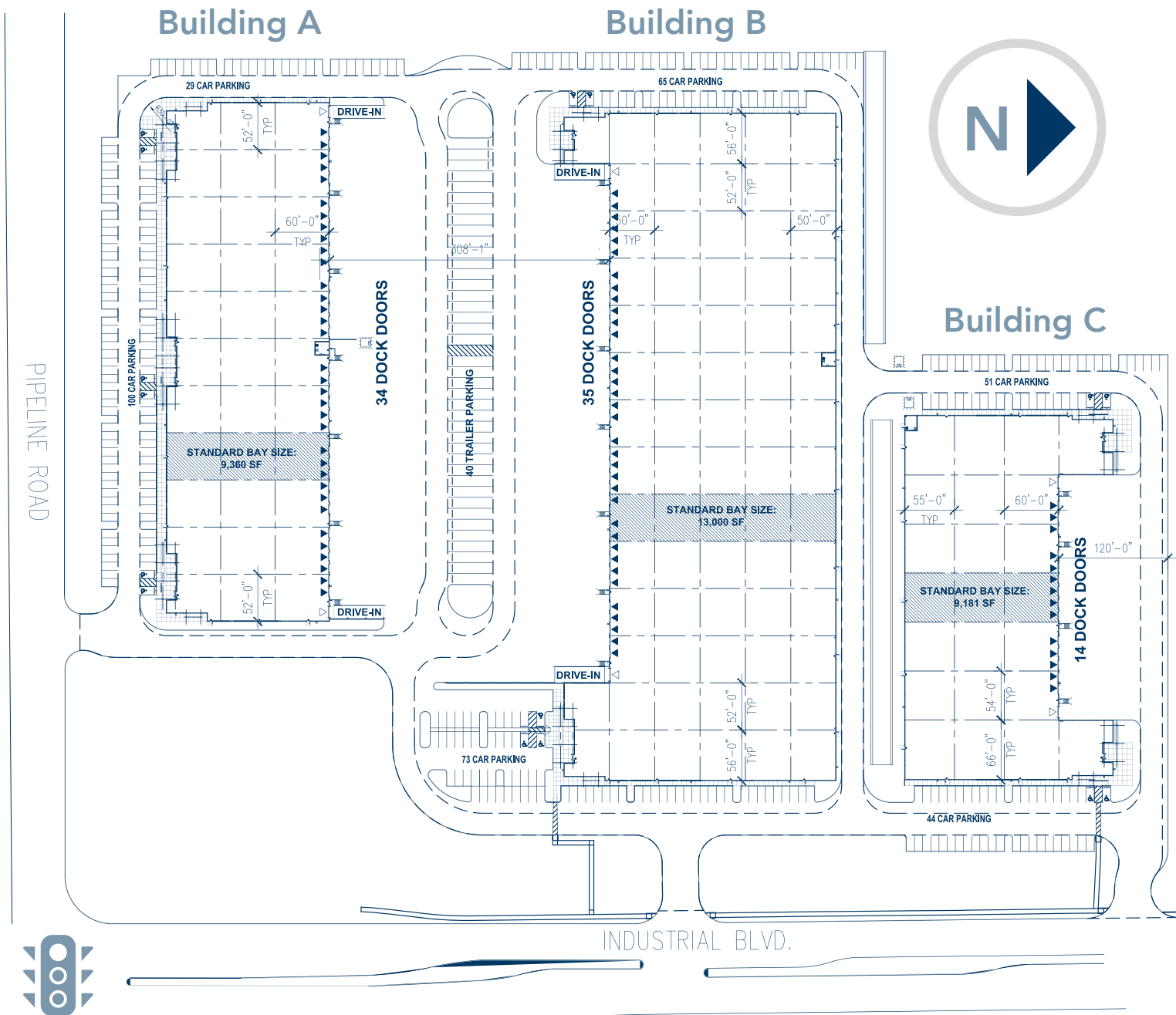

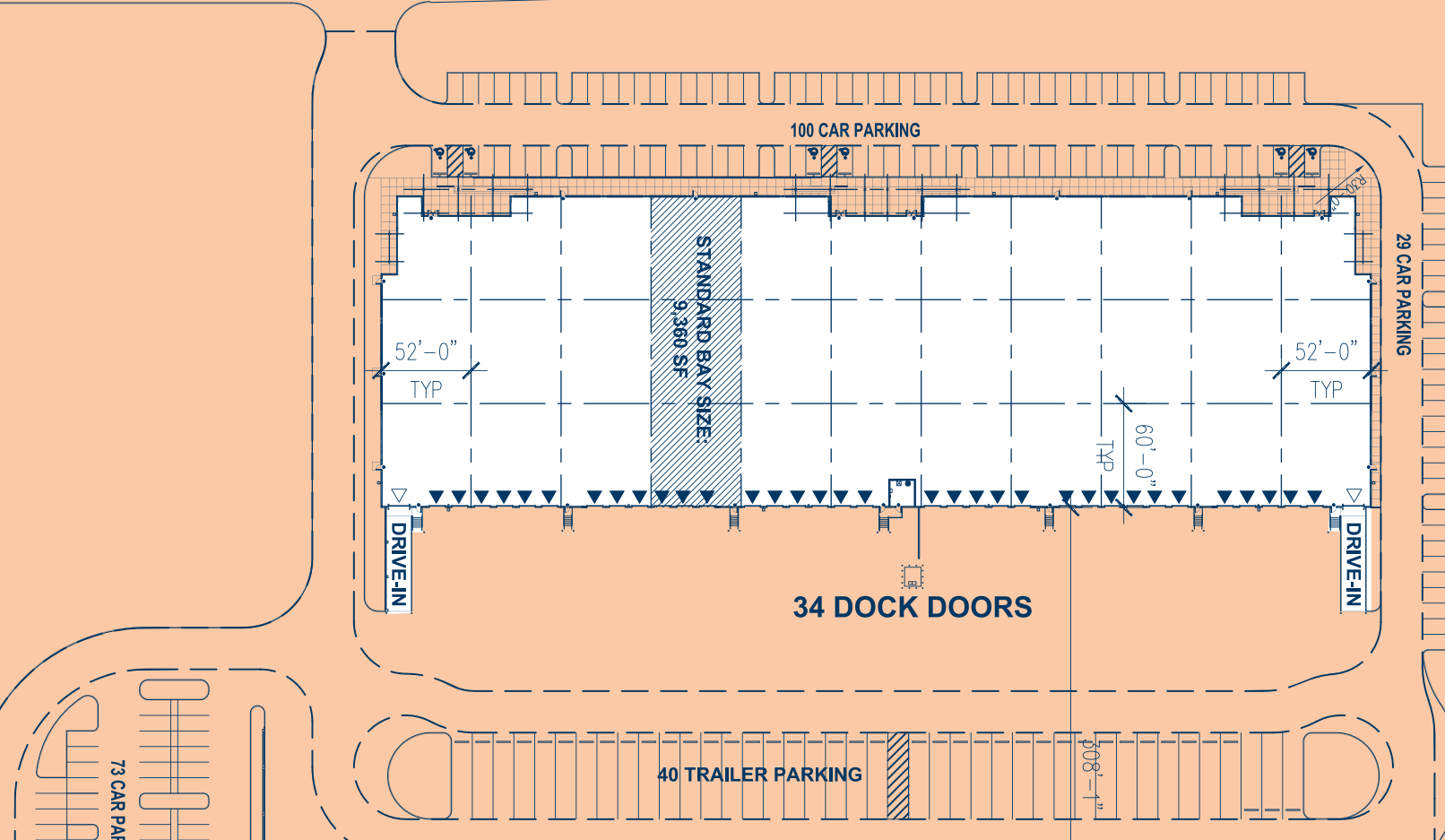

[PROPERTY NAVIGATION](#) **MASTER SITE PLAN**

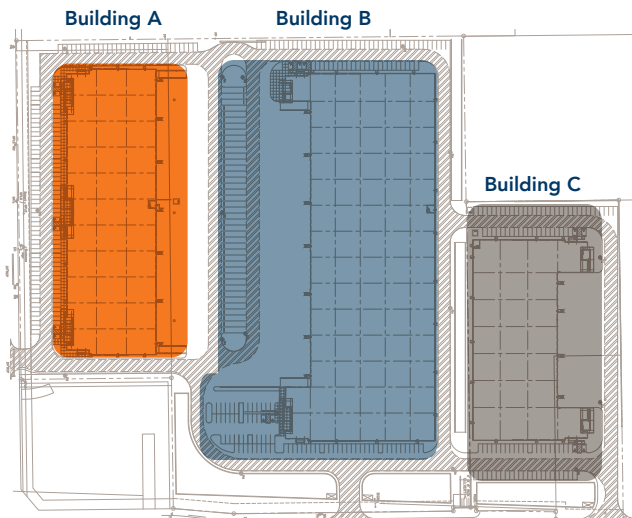

Building A 100,393 SF



SITE ADDRESS:
1010 S Industrial Blvd, Building A | Euless, TX 76040

Available SF (Divisible)	100,393 SF
Minimum Divisible	18,720 SF
Clear Height	28'
Drive-In Dock Doors	2
Dock Doors Usable	35
Car Parking	129
Trailer Parking	3
Site Area	Approx 6.627 ac



FORREST COOK
forrest.cook@streamrealty.com
 T: 817-877-1310
 M: 817-913-5999

LUKE DAVIS
ldavis@streamrealty.com
 T: 214-267-0420
 M: 817-637-2142

CHARLES BREWER
charles.brewer@streamrealty.com
 T: 214-560-2960
 M: 480-221-2191



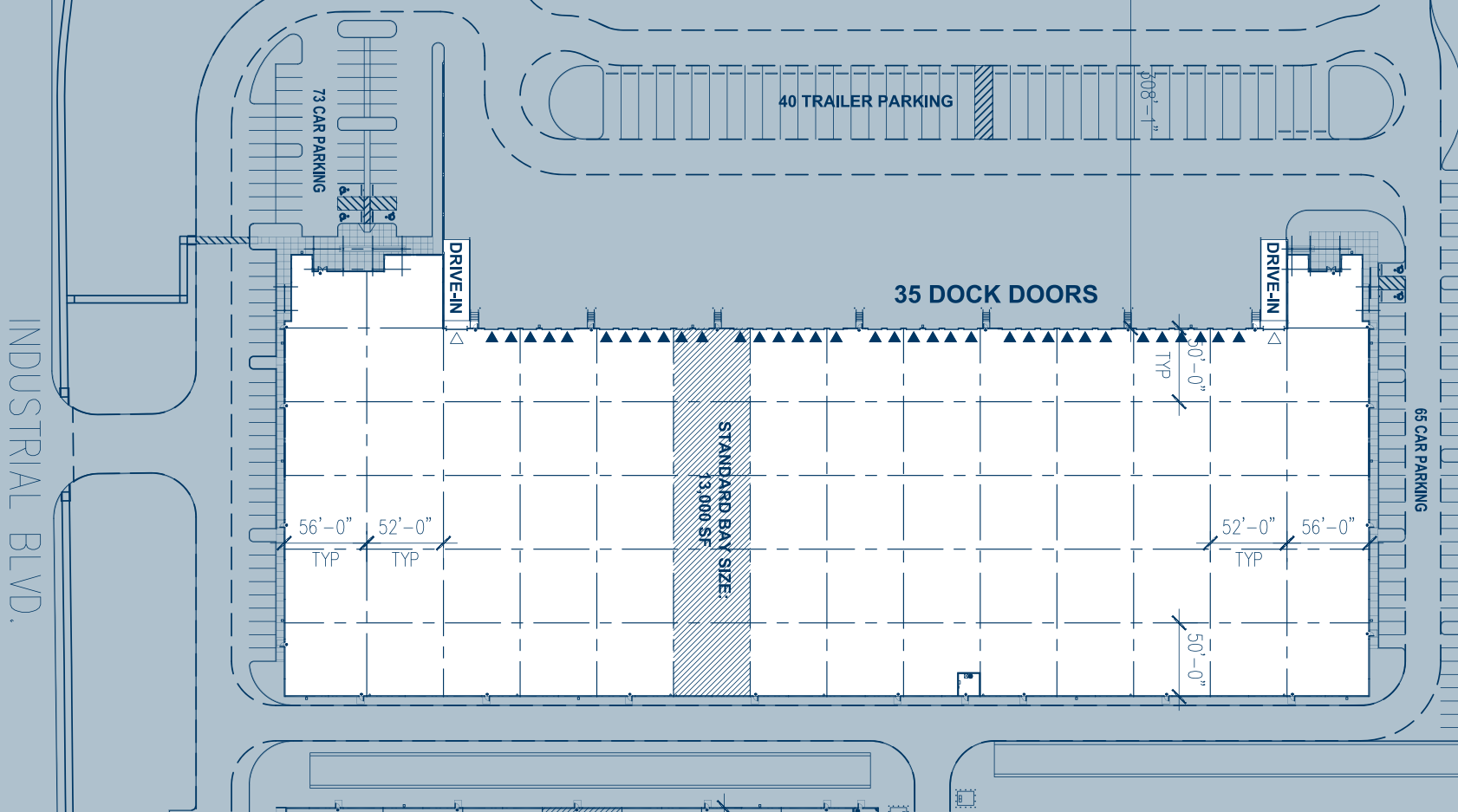

PROPERTY NAVIGATION

MASTER SITE PLAN

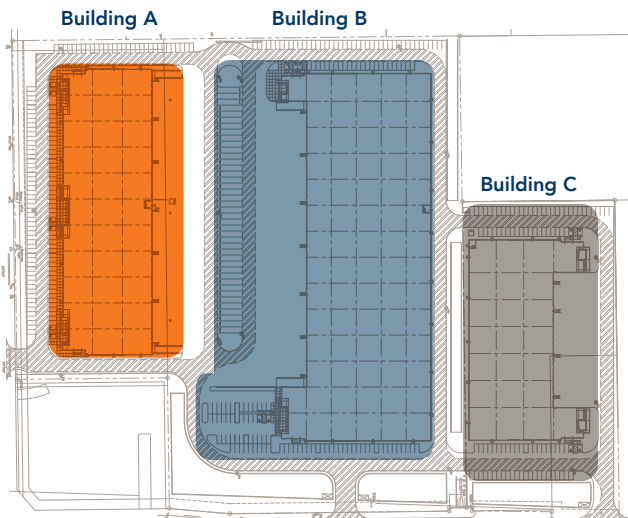

Building B 191,010 SF



SITE ADDRESS:
1010 S Industrial Blvd, Building B | Euless, TX 76040

Available SF (Divisible)	191,010 SF
Minimal Divisible	55,000 SF
Clear Height	32'
Drive-In Dock Doors	2
Dock Doors Usable	35
Car Parking	138
Trailer Parking	37
Site Area	Approx 11.011 ac



FORREST COOK
forrest.cook@streamrealty.com
 T: 817-877-1310
 M: 817-913-5999

LUKE DAVIS
ldavis@streamrealty.com
 T: 214-267-0420
 M: 817-637-2142

CHARLES BREWER
charles.brewer@streamrealty.com
 T: 214-560-2960
 M: 480-221-2191



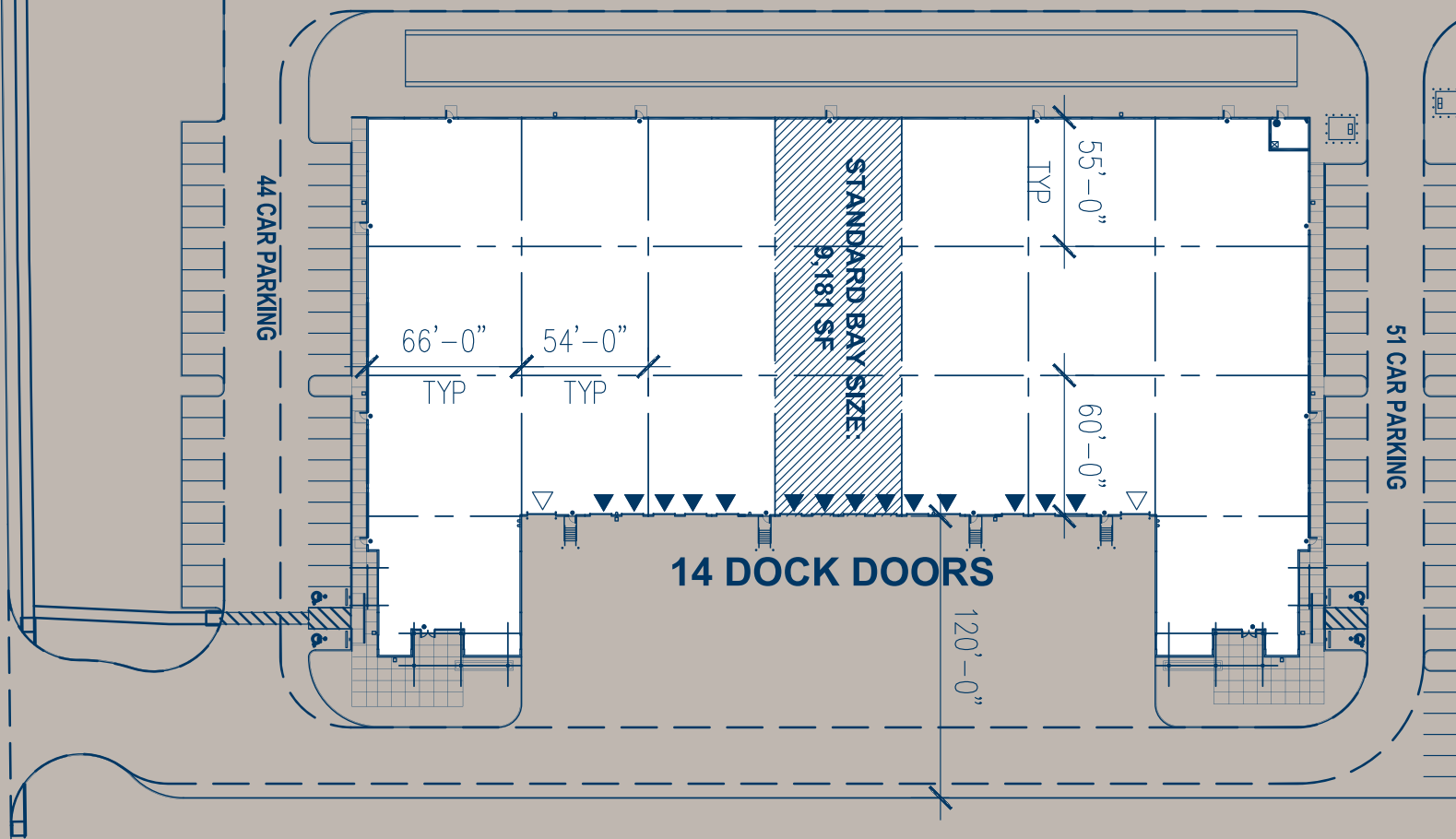

PROPERTY NAVIGATION

MASTER SITE PLAN

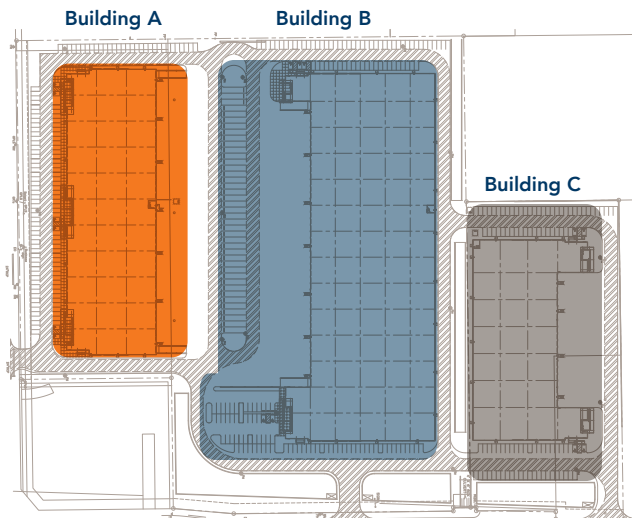

Building C 75,368 SF



SITE ADDRESS:
1000 S Industrial Blvd, Building C | Euless, TX 76040

Available SF (Divisible)	75,368 SF
Minimal Divisible	24,000 SF
Clear Height	28'
Dock Doors Usable	14
Car Parking	95
Site Area	Approx 4.378 ac



FORREST COOK
forrest.cook@streamrealty.com
 T: 817-877-1310
 M: 817-913-5999

LUKE DAVIS
ldavis@streamrealty.com
 T: 214-267-0420
 M: 817-637-2142

CHARLES BREWER
charles.brewer@streamrealty.com
 T: 214-560-2960
 M: 480-221-2191

