

# 1730 PENNSYLVANIA AVENUE, NW



## 4th Floor As-Built Plan Up to 22,806 SF

FOR LEASING INFORMATION  
PLEASE CONTACT

**Dan Dooley**  
202.420.2110  
DDooley@TishmanSpeyer.com

**Amy K. Brendler**  
202.420.2111  
ABrendler@TishmanSpeyer.com

**Rafael V. Notario**  
202.420.2118  
RNotario@TishmanSpeyer.com

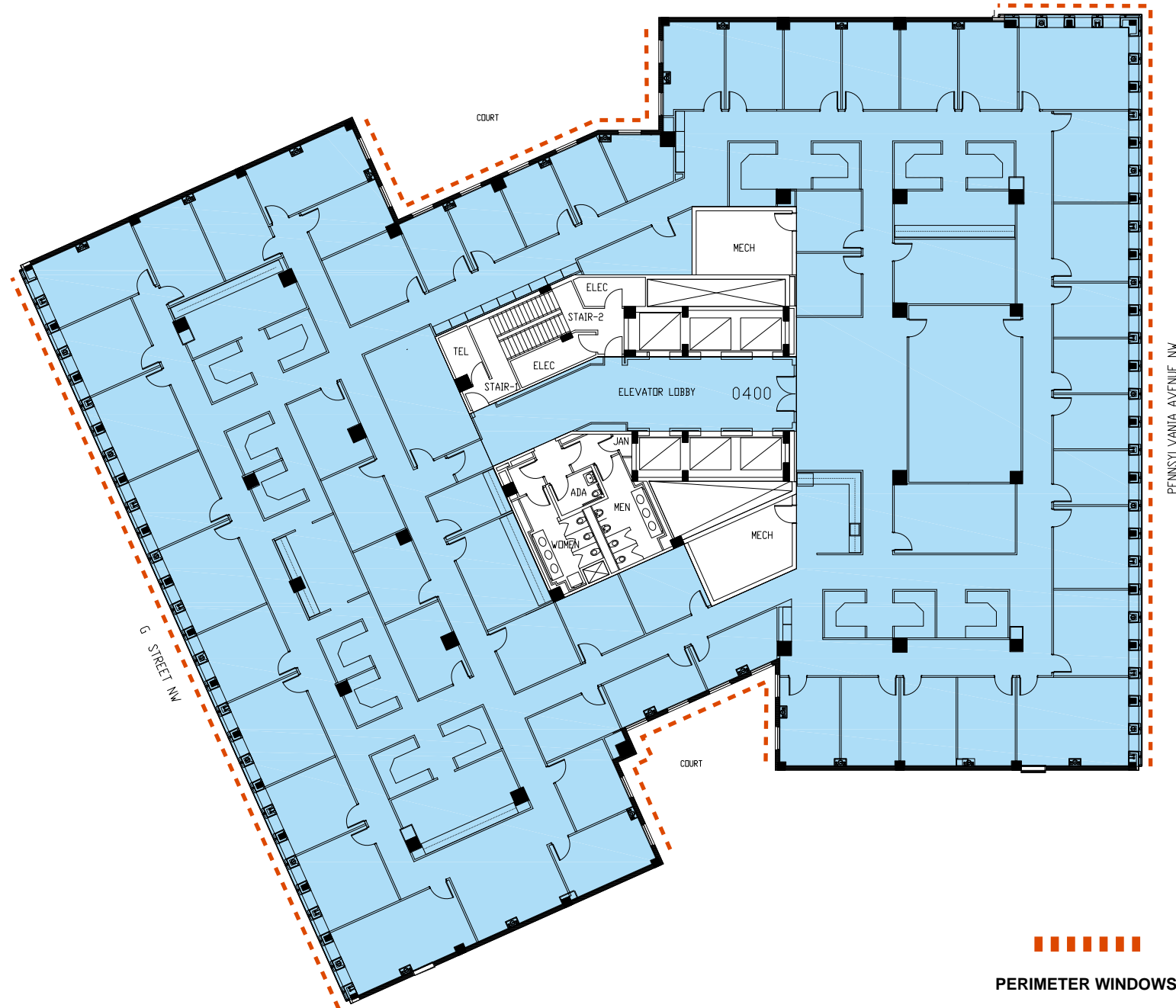

PERIMETER WINDOWS



TISHMAN SPEYER