

FOR LEASE

27990 SHERMAN AVE.

SUN CITY MEDICAL OFFICES

Menifee, CA 92585

PRESENTED BY:

BRETT LARSON, JD, CCIM

C: 951.532.4713

brett.larson@svn.com

CalDRE #01947115



PROPERTY SUMMARY



OFFERING SUMMARY

LEASE RATE:	\$2.10 SF/yr (NNN)
BUILDING SIZE:	10,315 SF
AVAILABLE SF:	4,218 - 5,363 SF
YEAR BUILT / RENOVATED:	1983 / 2018
ZONING:	Economic Development Corridor - McCall Boulevard (EDC-MB)
MARKET:	Inland Empire
SUBMARKET:	SW Riverside County

BRETT LARSON, JD, CCIM

C: 951.532.4713

CalDRE #01947115

brett.larson@svn.com

PROPERTY OVERVIEW

Sun City Medical Offices are located in Menifee, CA, less than 1 mile from Interstate 215 and the Menifee Valley Medical Center.

Beautifully renovated in 2018, this move-in ready medical office space is ideal for any large primary care or specialty practice.

Sun City Medical Offices are surrounded by several established residential neighborhoods and a new retail center is currently under development just north of the property.

SUN CITY MEDICAL OFFICES 27990 Sherman Ave. Menifee, CA 92585

SVN | INSIGHT COMMERCIAL REAL ESTATE ADVISORS 2

We obtained the information above from sources we believe to be reliable. However, we have not verified its accuracy and make no guarantee, warranty or representation about it. It is submitted subject to the possibility of errors, omissions, change of price, rental or other conditions, prior sale, lease or financing, or withdrawal without notice. We include projections, opinions, assumptions or estimates for example only, and they may not represent current or future performance of the property. You and your tax and legal advisors should conduct your own investigation of the property and transaction. All SVN offices are independently owned and operated.

HIGHLIGHTS



BRETT LARSON, JD, CCIM

C: 951.532.4713

CalDRE #01947115

brett.larson@svn.com

PROPERTY FEATURES

- Fully-improved, move-in ready 4,218 - 5,363 SF medical office space for lease
- Single-story, patient-accessible building
- Includes...
 - Large shared waiting area
 - Reception area
 - Nine [9] exam rooms
 - Four [4] ADA-compliant restrooms
 - Physician's offices
 - Large centralized nurse's station
 - Large conference room
 - Large break room
 - Storage
 - If desired, two [2] large procedure rooms
- Abundant parking in dedicated lot
- Separate rear physician / employee entrance
- Closed-circuit video monitoring security system in place
- Less than 1 mile from Menifee Valley Medical Center

SUN CITY MEDICAL OFFICES 27990 Sherman Ave. Menifee, CA 92585

SVN | INSIGHT COMMERCIAL REAL ESTATE ADVISORS 3

We obtained the information above from sources we believe to be reliable. However, we have not verified its accuracy and make no guarantee, warranty or representation about it. It is submitted subject to the possibility of errors, omissions, change of price, rental or other conditions, prior sale, lease or financing, or withdrawal without notice. We include projections, opinions, assumptions or estimates for example only, and they may not represent current or future performance of the property. You and your tax and legal advisors should conduct your own investigation of the property and transaction. All SVN offices are independently owned and operated.

FLOOR PLAN

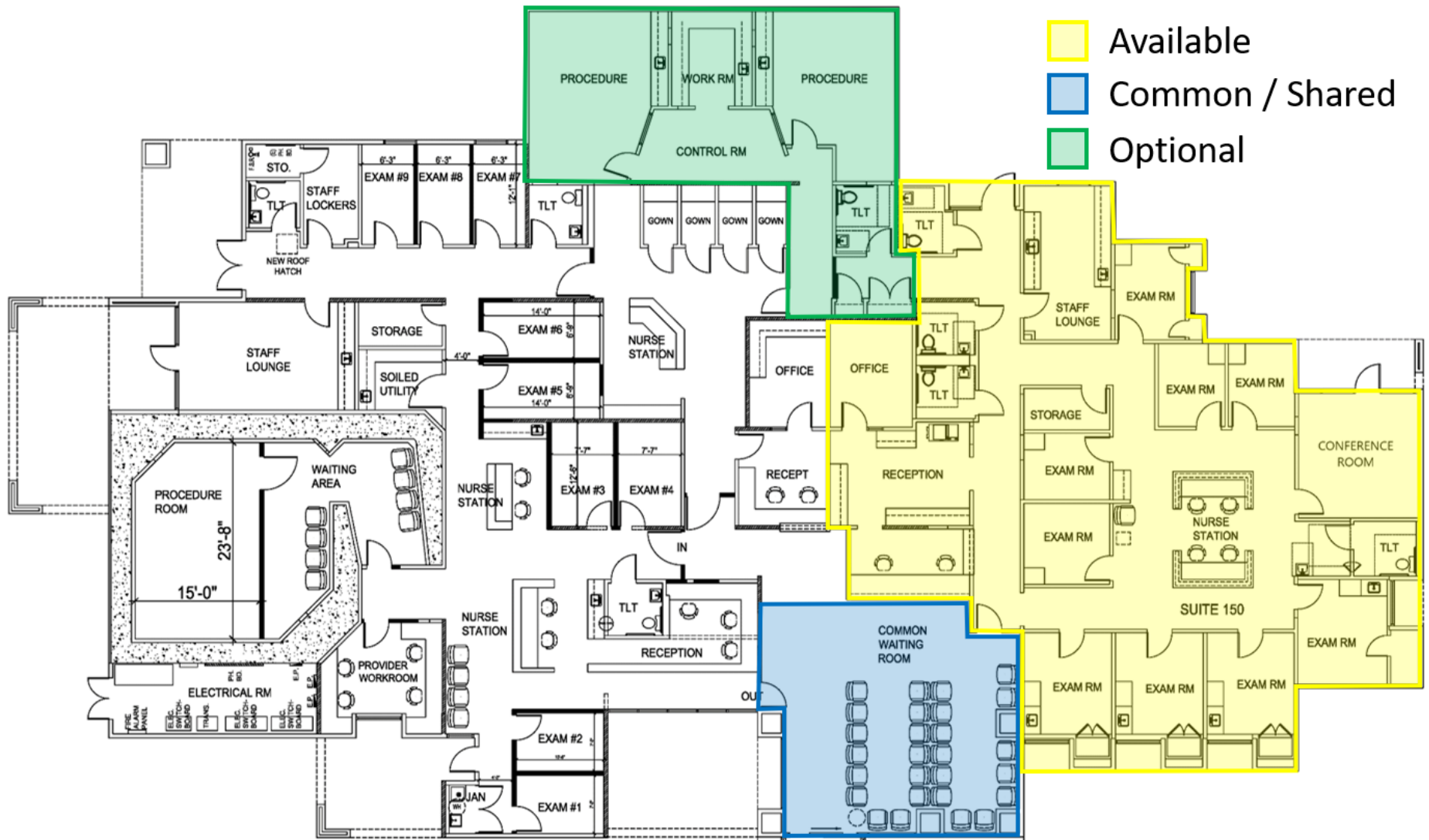

BRETT LARSON, JD, CCIM
 C: 951.532.4713
 CalDRE #01947115
 brett.larson@svn.com

We obtained the information above from sources we believe to be reliable. However, we have not verified its accuracy and make no guarantee, warranty or representation about it. It is submitted subject to the possibility of errors, omissions, change of price, rental or other conditions, prior sale, lease or financing, or withdrawal without notice. We include projections, opinions, assumptions or estimates for example only, and they may not represent current or future performance of the property. You and your tax and legal advisors should conduct your own investigation of the property and transaction. All SVN offices are independently owned and operated.

INTERIOR PHOTOS



BRETT LARSON, JD, CCIM

C: 951.532.4713

CalDRE #01947115

brett.larson@svn.com

SUN CITY MEDICAL OFFICES 27990 Sherman Ave. Menifee, CA 92585

SVN | INSIGHT COMMERCIAL REAL ESTATE ADVISORS 5

We obtained the information above from sources we believe to be reliable. However, we have not verified its accuracy and make no guarantee, warranty or representation about it. It is submitted subject to the possibility of errors, omissions, change of price, rental or other conditions, prior sale, lease or financing, or withdrawal without notice. We include projections, opinions, assumptions or estimates for example only, and they may not represent current or future performance of the property. You and your tax and legal advisors should conduct your own investigation of the property and transaction. All SVN offices are independently owned and operated.

AERIAL MAP

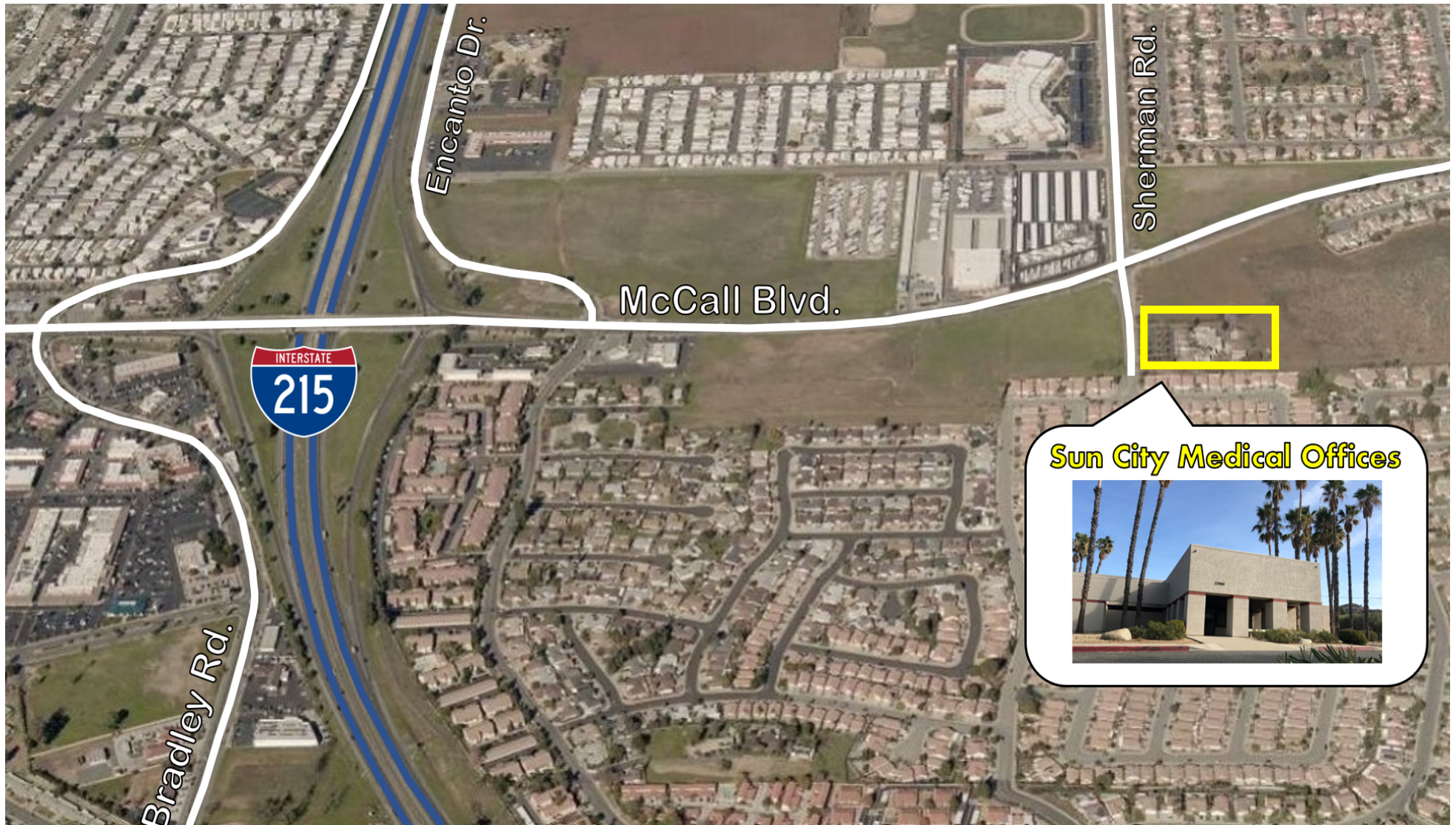

BRETT LARSON, JD, CCIM

C: 951.532.4713

CalDRE #01947115

brett.larson@svn.com

SUN CITY MEDICAL OFFICES 27990 Sherman Ave. Menifee, CA 92585

SVN | INSIGHT COMMERCIAL REAL ESTATE ADVISORS 6

We obtained the information above from sources we believe to be reliable. However, we have not verified its accuracy and make no guarantee, warranty or representation about it. It is submitted subject to the possibility of errors, omissions, change of price, rental or other conditions, prior sale, lease or financing, or withdrawal without notice. We include projections, opinions, assumptions or estimates for example only, and they may not represent current or future performance of the property. You and your tax and legal advisors should conduct your own investigation of the property and transaction. All SVN offices are independently owned and operated.

LOCATION MAP



BRETT LARSON, JD, CCIM

C: 951.532.4713

CalDRE #01947115

brett.larson@svn.com

SUN CITY MEDICAL OFFICES 27990 Sherman Ave. Menifee, CA 92585

SVN | INSIGHT COMMERCIAL REAL ESTATE ADVISORS 7

We obtained the information above from sources we believe to be reliable. However, we have not verified its accuracy and make no guarantee, warranty or representation about it. It is submitted subject to the possibility of errors, omissions, change of price, rental or other conditions, prior sale, lease or financing, or withdrawal without notice. We include projections, opinions, assumptions or estimates for example only, and they may not represent current or future performance of the property. You and your tax and legal advisors should conduct your own investigation of the property and transaction. All SVN offices are independently owned and operated.