

28,060 SF

Industrial Space For Lease



Prologis Commerce Business Park

5603 Randolph Street
Commerce, CA 90040 USA



LOCATION

- Rare Freestanding Low Coverage Facility
- Long Beach (710) Freeway Visibility
- Excellent Access to Major Freeways and Downtown Los Angeles

FACILITY

- 28,060 SF Building
- 28,060 SF Available
- 3,500 SF Offices
- +/-29% Coverage
- Huge Fenced & Secured Yard
- 4 Dock High Positions
- 3 (16' x 20') Ground Level Doors
- 24' Clearance
- .45/3000 Sprinklers
- 285' Truck Court
- 1800 Amps, 277/480 Volts (2 Panels: 1200 Amps & 600 Amps)
- 49 Automobile Parking Stalls (Planned)

28,060 SF

Industrial Space For Lease

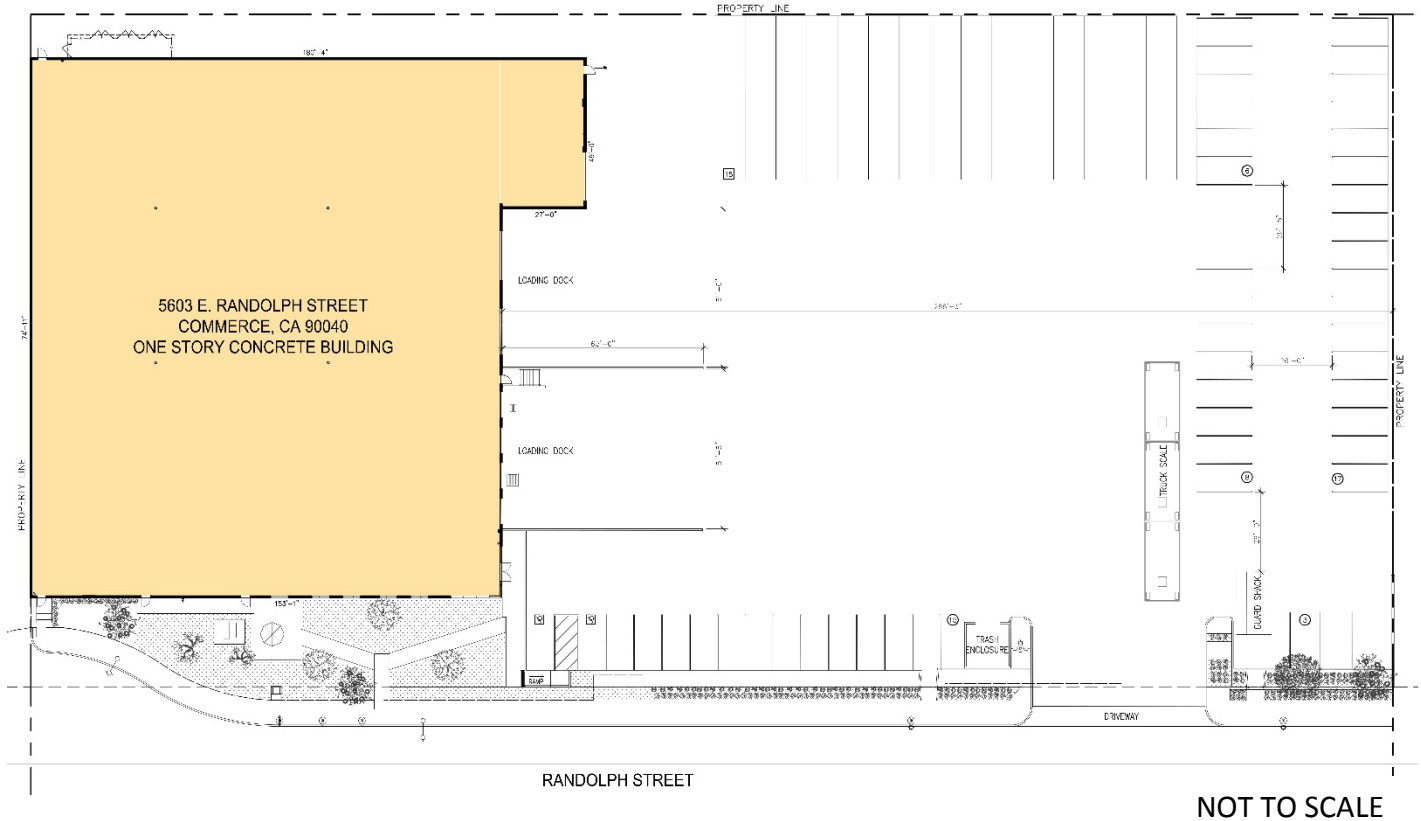

Newmark Knight Frank

John McMillan
CalDRE License #01103292
john.mcmillan@ngkf.com
ph +1 310 491 2048
2301 Rosecrans Avenue, Suite 4100
El Segundo, CA 90245 USA

Newmark Knight Frank

Jeff Sanita
CalDRE License #01242202
jeff.sanita@ngkf.com
ph +1 310 491 2003
2301 Rosecrans Avenue, Suite 4100
El Segundo, CA 90245 USA

Newmark Knight Frank

Greg Stumm
CalDRE License #01954921
greg.stumm@ngkf.com
ph +1 310 491 2079
2301 Rosecrans Avenue, Suite 4100
El Segundo, CA 90245 USA

Prologis

Analise Guttman
CalDRE License #01966053
aguttman@prologis.com
ph +1 562 345 9239
2141 Rosecrans Avenue, Suite 1151
El Segundo, CA 90703 USA