

# Vacant Land

2929 S Ruth Street – Sulphur, LA

# NAI Latter & Blum



## Property Features

- Approximately 3 acres available on Ruth Street, just south of Interstate 10
- Site is located across from Stine's and First Federal Bank of Louisiana
- Prime location with many potential uses
- Approximately 320' of frontage on Ruth Street
- I1 "Light Industrial" Zoning (Parish)
- 1,580 SF building on site included with sale
- Contact listing agent for additional information

\*Co-listed with Coldwell Banker Gallerie Realty

## Listing Price

- \$1,275,000.<sup>00</sup>

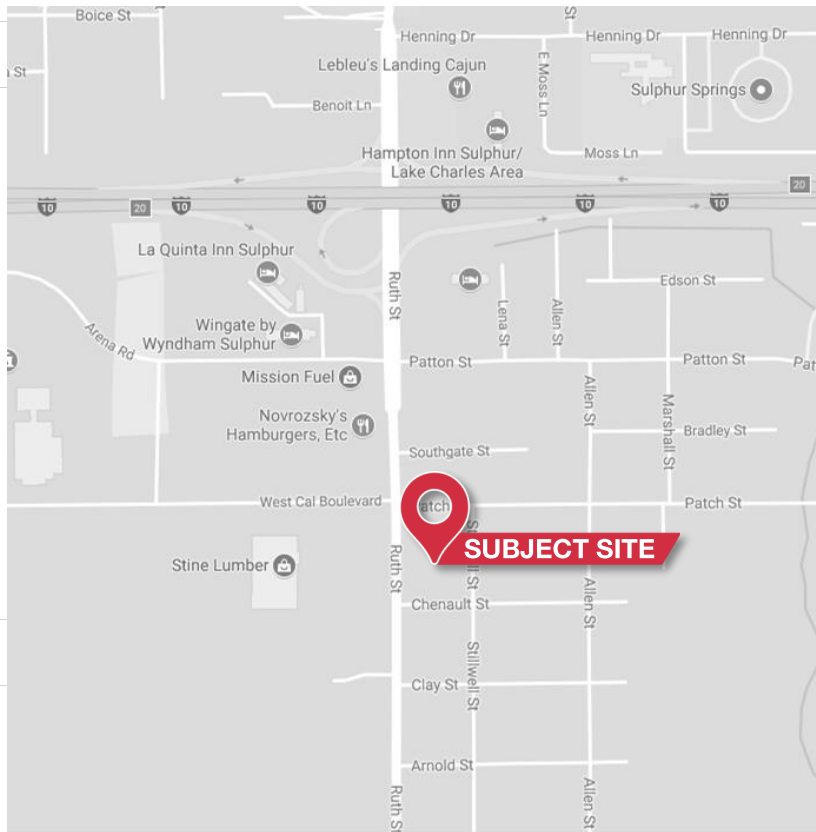

**Cheryl Addison**

+1 337 794 1599 • [cheryladison@latterblum.com](mailto:cheryladison@latterblum.com)

1424 Ryan Street  
Lake Charles, LA 70601  
337.310.1333

[latterblum.com](http://latterblum.com)

# Vacant Land

2929 S Ruth Street – Sulphur, LA

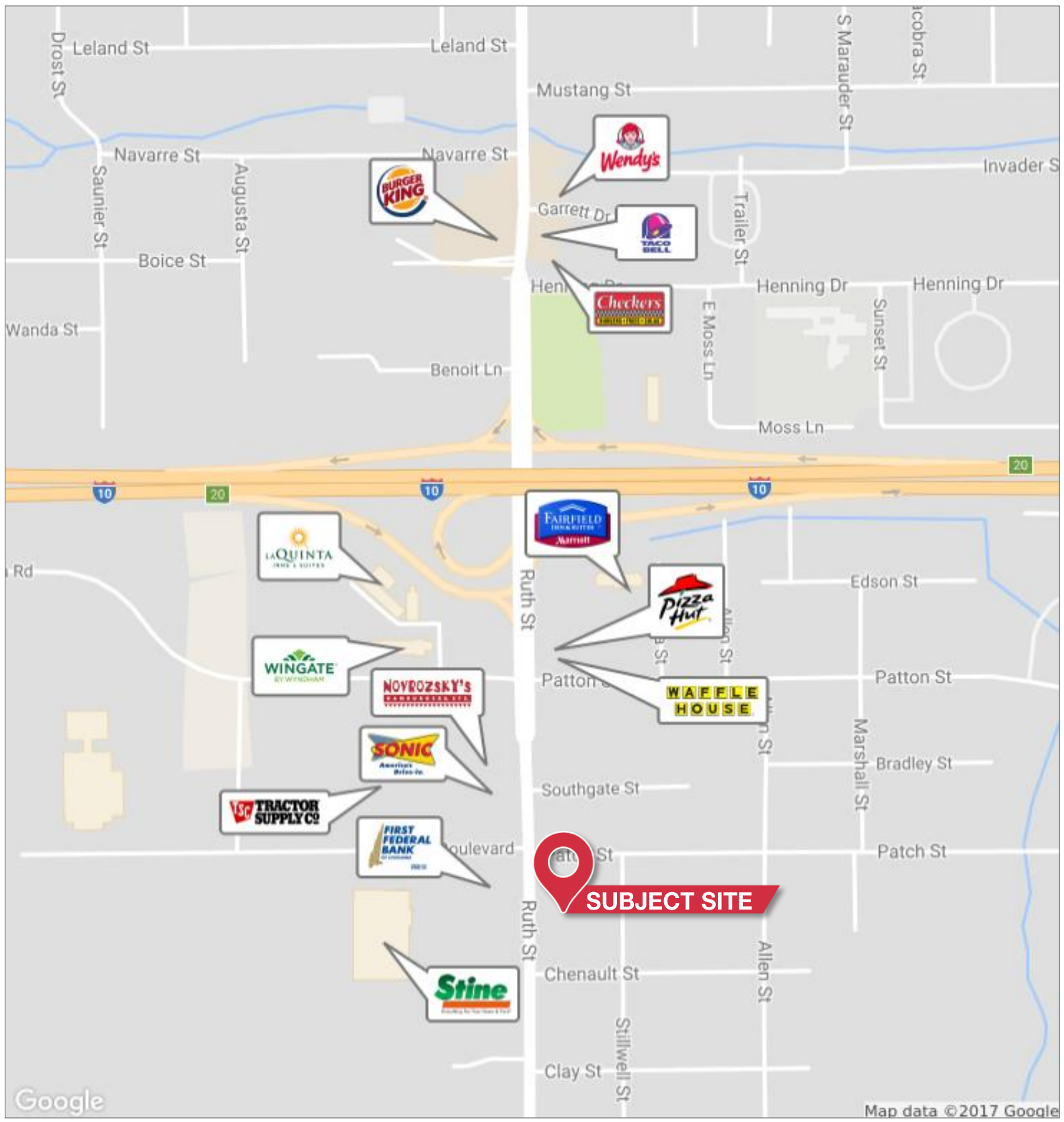

**Cheryl Addison**

+1 337 794 1599 • [cherylladdison@latterblum.com](mailto:cherylladdison@latterblum.com)

1424 Ryan Street  
Lake Charles, LA 70601  
337.310.1333  
[latterblum.com](http://latterblum.com)