



4852 Frusta Drive

4852 Frusta Drive, Columbus, Ohio 43207

Property Features

- ±9,600 SF Unit With ±500 SF Office Available for Lease
(Additional 7,000 SF Possible)
- 17' to 22' Ceiling Height
- 3 Phase Power - 480
- 1 Dock / 1 Drive-in Doors (10' x 14')
- LED Lights
- Strategically Located Near Alum Creek, I-270, & Rickenbacker Area

Lease Rate: \$8.00 MG

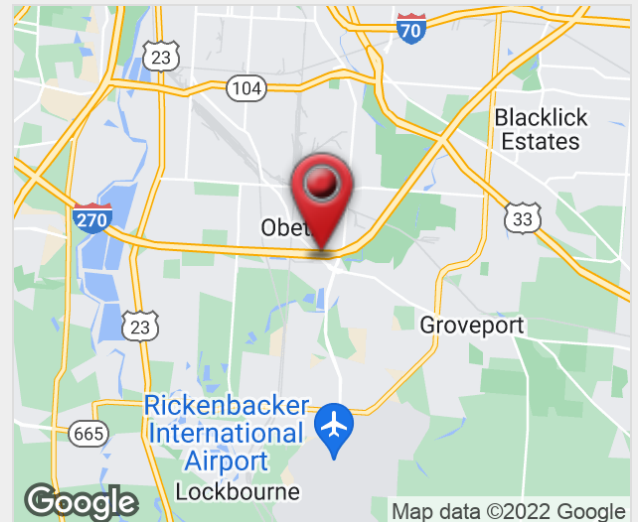

For more information:

Dan Sheeran

614 629 5216 • dsheeran@ohioequities.com

Mike Semon

614 629 5217 • mjsemon@ohioequities.com

Dan Sheeran, Jr.

614 629 5228 • djsheeran@ohioequities.com

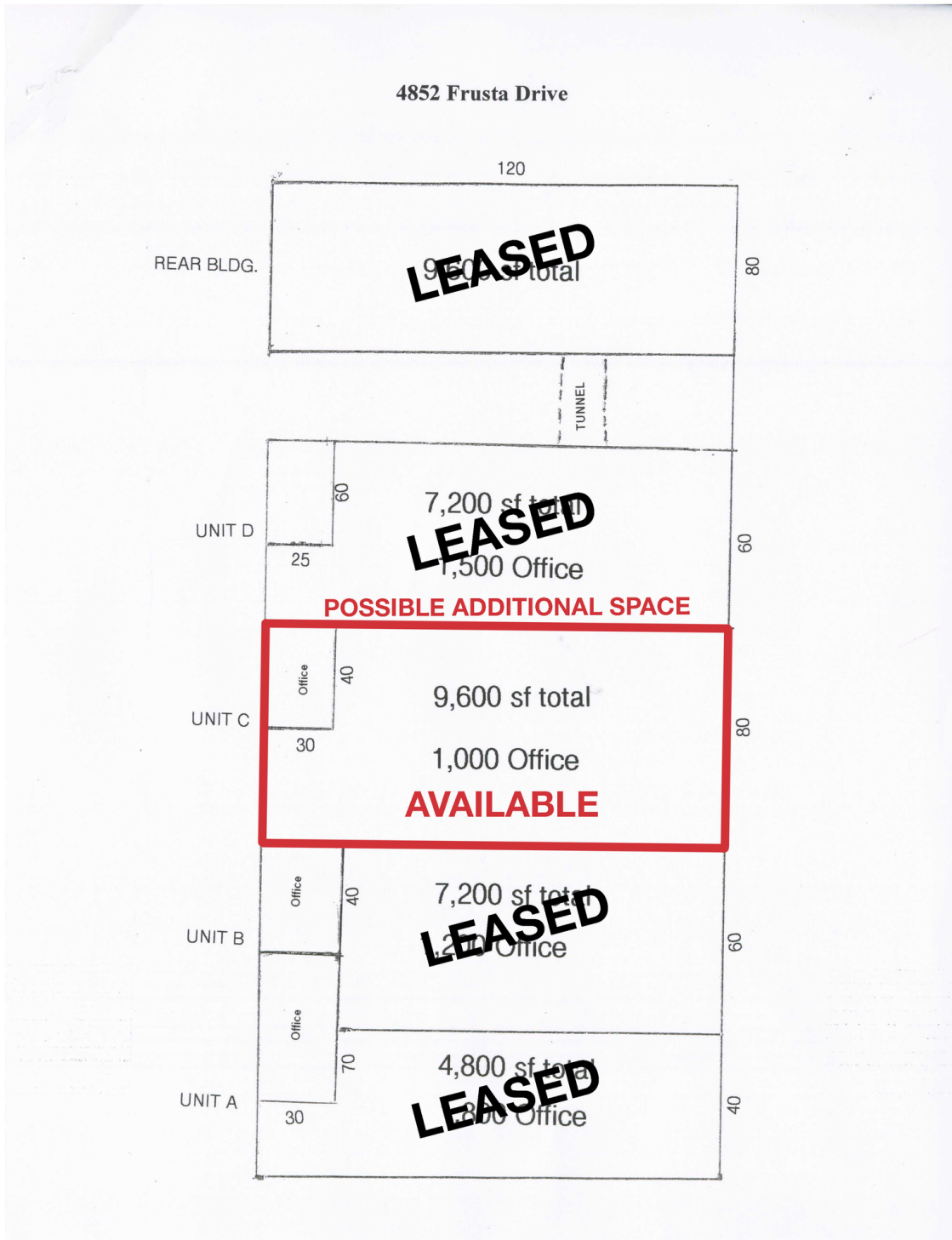

Location Map

