

10 Lower Thames Street, EC3

From 5,457 – 16,457 sq ft

Newly Refurbished Offices

SUBJECT TO CONTRACT

Location

The property is located on the south side of Lower Thames Street and benefits from excellent communications. It is a short walk from Monument, Bank, Fenchurch Street and London Bridge underground and mainline stations, providing access to Northern, Jubilee, Waterloo & City, Central, Circle and District lines, as well as mainline rail services.

Description

A landmark office building with an iconic blue glazed elevation on the north side of the River Thames.

The offices are the headquarters of the Express Newspaper Group and it is proposed that the offices are refurbished during 2018.

Amenities

- Refurbishment to be undertaken including refurbished reception, entrance and common parts
- Ground floor café amenity
- Panoramic river views
- Air conditioning
- Fully accessible raised floors
- 24 hour security and manned reception
- Bicycle racks and shower facilities

Viewing

Viewing strictly by appointment through sole agents Cushman & Wakefield.

Lease

The premises are available on a floor by floor basis on flexible terms directly from the Landlord.

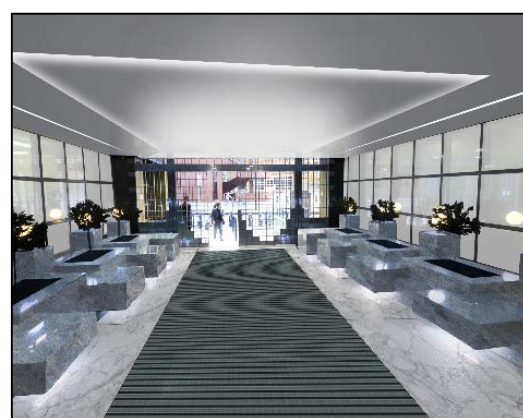

Costs	Per sq ft exclusive
Guiding Rent	From £40.00
Rates (estimated)	£17.70
Service Charge	TBC

Floors	Area (sq ft)	Area (sq m)
9 th	11,000 (approx.)	1,022 (approx.)
5 th	5,457	507
TOTAL	16,457	1,529

* Floor areas subject to verification.

10 Lower Thames Street, EC3

From 5,457 – 16,457 sq ft

Newly Refurbished Offices

For more information, contact:

Andrew Parker

+44 (0) 20 3296 4288

andrew.parker@cushwake.com

Alex Novelli

+44 (0) 20 3296 2133

alex.novelli@cushwake.com

Tom Fayers

+44 (0) 20 3296 4226

tom.fayers@cushwake.com

Location

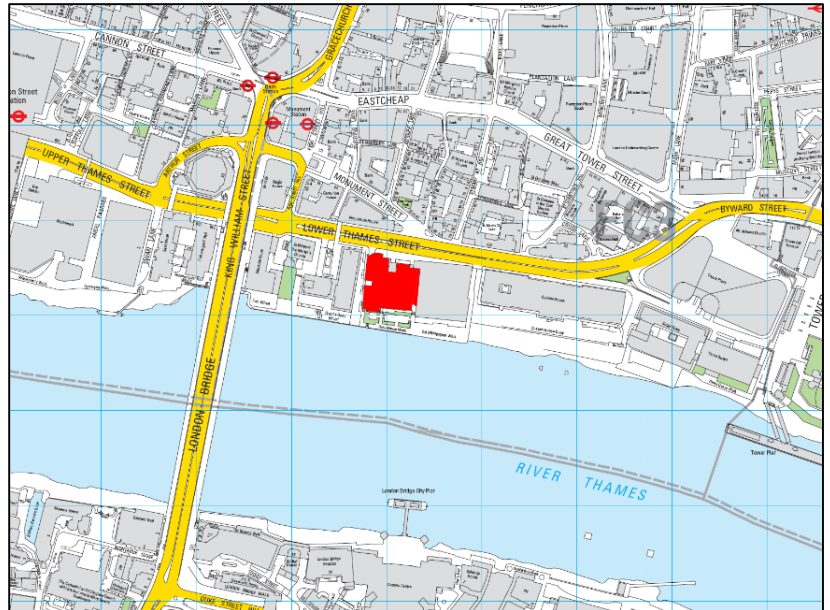

Typical Upper Floor Plan

