

For Lease

**7037-7 COMMONWEALTH AVE.
Jacksonville, Florida 32220
Warehouse / Flex - Westside Submarket**



- **10,968** sq. ft. - total space
- **AVAILABLE – Nov. 1st**
- Westside location
- (2) Dock high doors
- (1) Grade Level door
- 9673 sq.ft. Warehouse
- 1295 sq.ft. Office space
- Zoned IBP
- 24' Ceiling Height
- Wet sprinkler system
- Masonry – Tilt wall construction
- Year built 1997

Lease Rate: \$9.50 PSF NNN

Contact:

Lauri Smith

(904) 356-2228

lsmith@escresults.com

Easton, Sanderson & Company

**Industrial - Commercial R.E. Sales, Leasing & Management
300 E. State Street (Suite G) Jacksonville, FL. 32202**

www.escresults.com Licensed Real Estate Brokers



For Lease

7037-7 COMMONWEALTH AVE.

Jacksonville, Florida 32220

Warehouse / Flex - Westside Submarket



Contact:

Lauri Smith

(904) 356-2228

lsmith@escresults.com

Easton, Sanderson & Company

Industrial - Commercial R.E. Sales, Leasing & Management

300 E. State Street (Suite G) Jacksonville, FL. 32202

www.escresults.com Licensed Real Estate Brokers



Floor Plan

7037-7 COMMONWEALTH AVE.

Jacksonville, Florida 32220

Warehouse / Flex - Westside Submarket

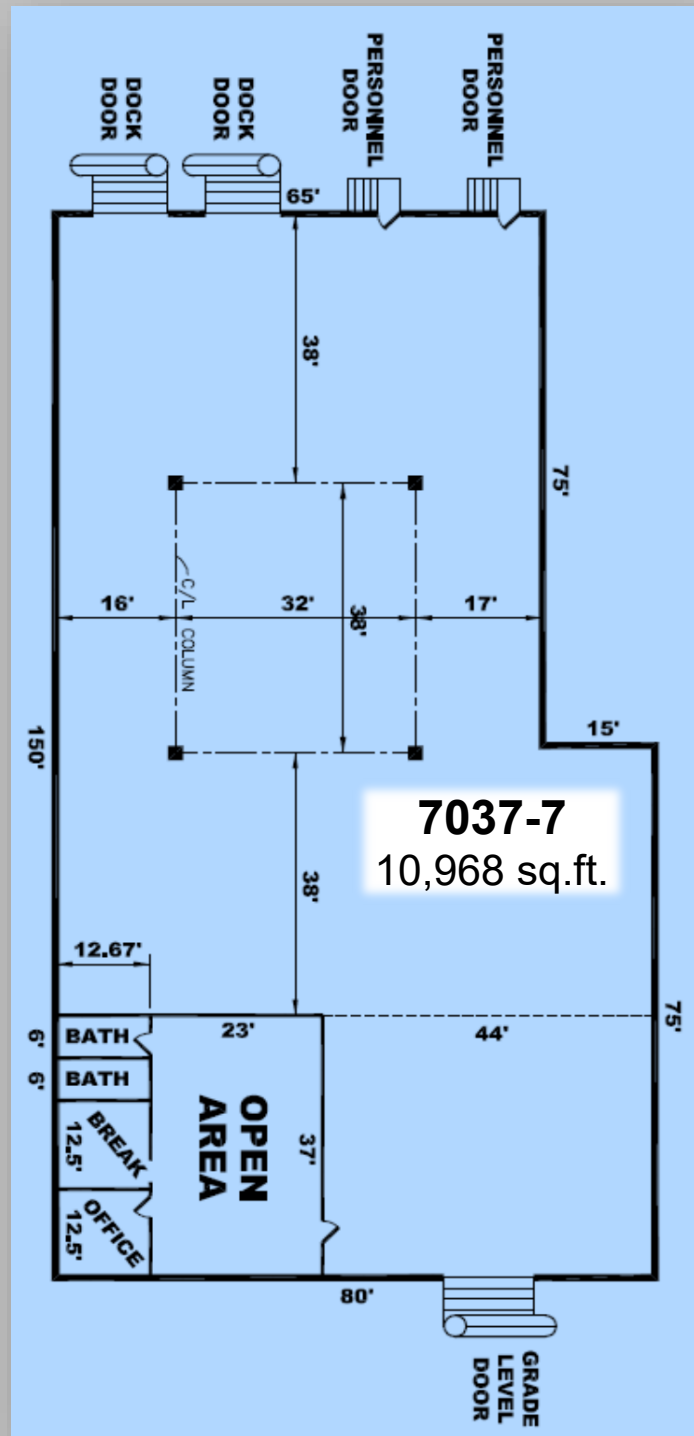

Contact:

Lauri Smith

(904) 356-2228

lsmith@escresults.com

Easton, Sanderson & Company

Industrial - Commercial R.E. Sales, Leasing & Management

300 E. State Street (Suite G) Jacksonville, FL. 32202

www.escresults.com Licensed Real Estate Brokers



Location Map

COMMONWEALTH COMMERCE CENTER

Jacksonville, Florida 32220

Warehouse / Flex - Westside Submarket



Contact:

Lauri Smith

(904) 356-2228

lsmith@esresults.com

Easton, Sanderson & Company

Industrial - Commercial R.E. Sales, Leasing & Management

300 E. State Street (Suite G) Jacksonville, FL. 32202

www.esresults.com Licensed Real Estate Brokers

