

# RETAIL/OFFICE/MEDICAL

## SPACE FOR LEASE

222 E. WILLIAM STREET, DELAWARE, OHIO 43015



SCOTT CUBBERLY SENIOR ADVISOR

MOBILE 614.395.5718 | DIRECT 614.334.7843  
SCUBBERLY@EQUITY.NET

**equity** | brokerage

The information contained herein has been obtained from the property owner or other sources that we deem reliable. Although we have no reason to doubt its accuracy, no representation or warranty is made regarding the information, and the property is offered "as is". The submission may be modified or withdrawn at any time by the property owner.

# PROPERTY HIGHLIGHTS

RETAIL/OFFICE/MEDICAL

SPACE FOR LEASE

222 E. WILLIAM STREET., DELAWARE, OHIO 43015

- +/- 2,880 SF available for lease
- Zoned B-3; street-side signage available
- Conveniently located off US 23 North
- Within walking distance to downtown Delaware
- 3-phase electric; fiber optic cable
- 15,044 vehicles per day on E. William Street
- Building owner is a licensed Ohio real estate agent
- Lease rate: \$18.75 psf NNN



# SPACE PLAN

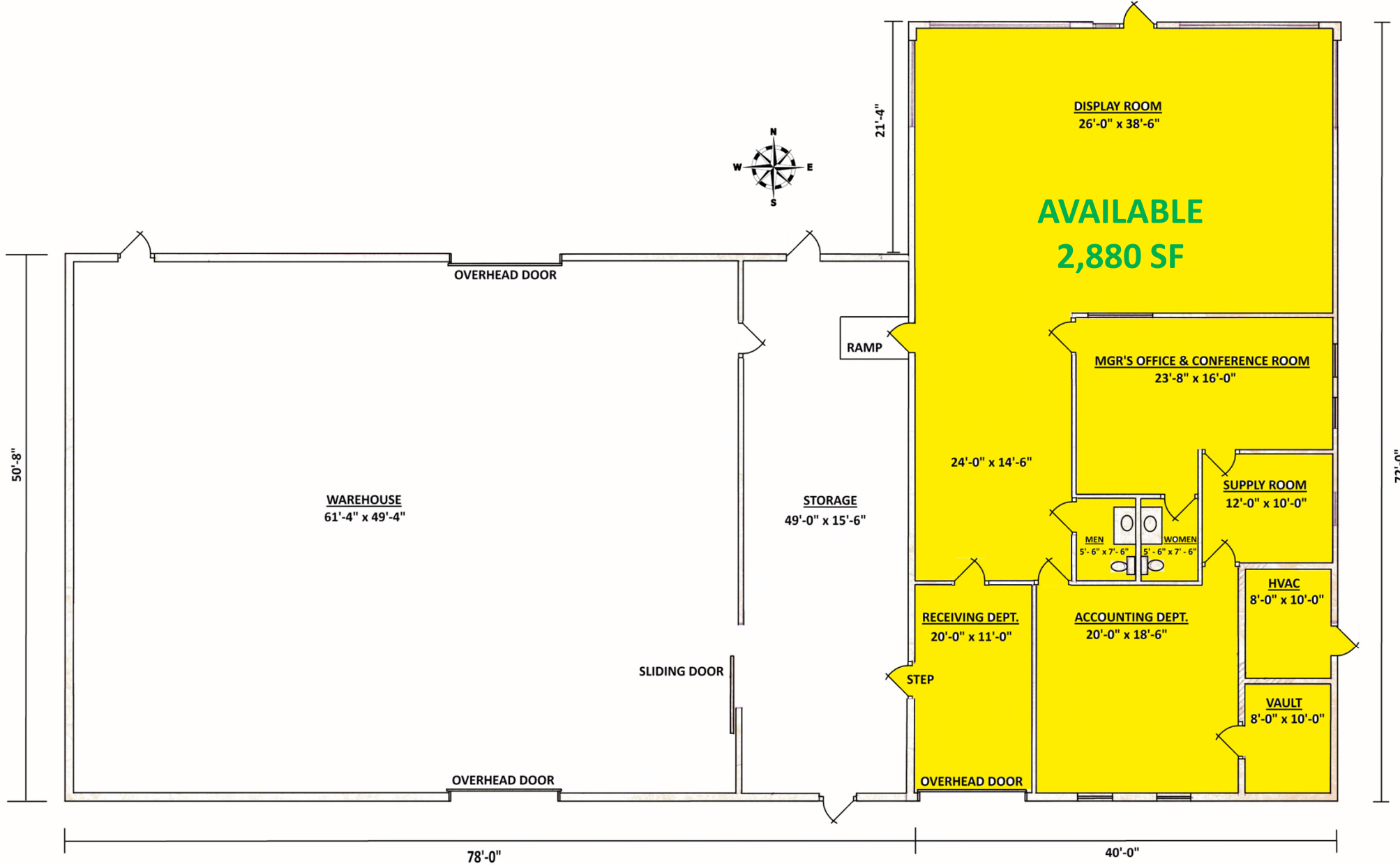

# CLOSE AERIAL



# 1-MILE RADIUS DEMOS

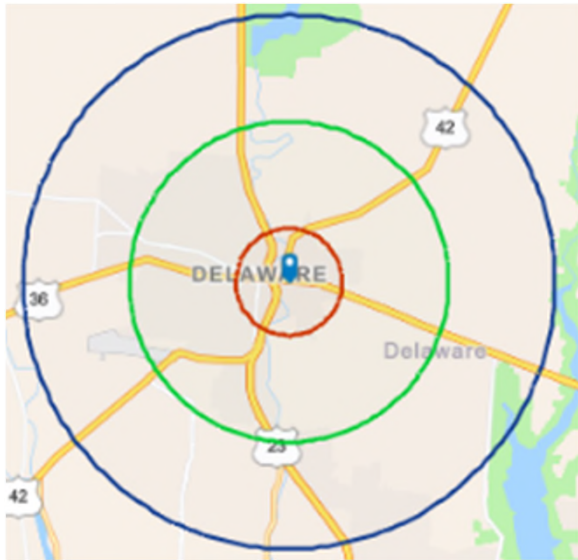

## KEY FACTS

**7,855**  
Population

**2.4**  
Average  
Household Size

**34.3**  
Median Age

**\$62,502**  
Median Household Income

## BUSINESS

**521**

Total Businesses

**5,541**

Total Employees

## EDUCATION

**5%**

No High School  
Diploma

**32%**

High School  
Graduate

**29%**

Some  
College

**34%**

Bachelor's/Grad/Prof  
Degree

## INCOME



**\$32,185**  
Per Capita  
Income



**\$62,502**  
Median  
Household  
Income



**\$85,915**  
Average  
Household  
Income

## EMPLOYMENT



**64.1**  
White  
Collar %



**19.1**  
Blue  
Collar %



**16.8**  
Services  
%

**equity** | brokerage

The information contained herein has been obtained from the property owner or other sources that we deem reliable. Although we have no reason to doubt its accuracy, no representation or warranty is made regarding the information, and the property is offered "as is." The submission may be modified or withdrawn at any time by the property owner.

# 3-MILE RADIUS DEMOS

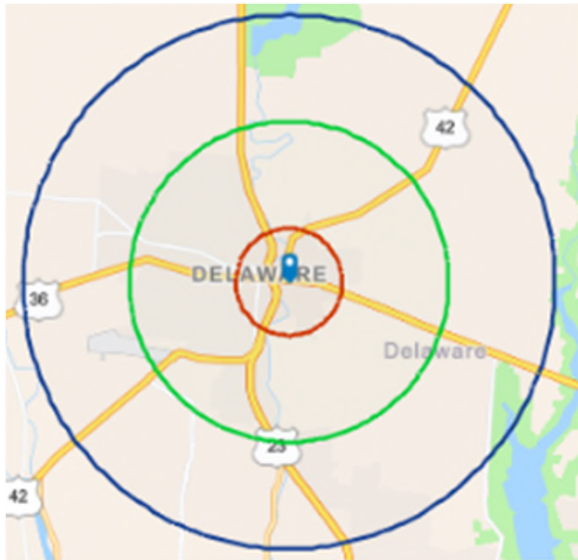

## KEY FACTS

**36,264**  
Population

**2.4**  
Average  
Household Size

**36.5**  
Median Age

**\$78,547**  
Median Household Income

## BUSINESS

**1,127**

Total Businesses

**13,706**

Total Employees

## EDUCATION

**4%**

No High School  
Diploma

**28%**

High School  
Graduate

**28%**

Some  
College

**40%**

Bachelor's/Grad/Prof  
Degree

## INCOME



**\$37,957**  
Per Capita  
Income



**\$78,547**  
Median  
Household  
Income



**\$95,988**  
Average  
Household  
Income

## EMPLOYMENT

**65.0**  
White  
Collar %

**19.9**  
Blue  
Collar %

**15.1**  
Services  
%

**equity** | brokerage

The information contained herein has been obtained from the property owner or other sources that we deem reliable. Although we have no reason to doubt its accuracy, no representation or warranty is made regarding the information, and the property is offered "as is." The submission may be modified or withdrawn at any time by the property owner.

# 5-MILE RADIUS DEMOS

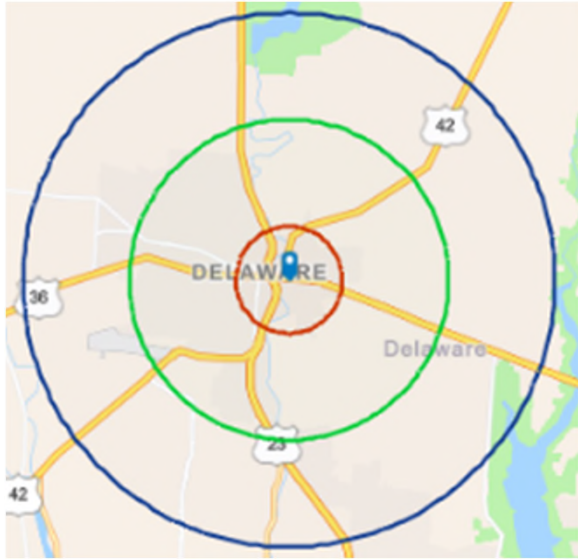

## KEY FACTS

**53,649**  
Population

**2.6**  
Average  
Household Size

**37.0**  
Median Age

**\$86,433**  
Median Household Income

## BUSINESS

**1,424**

Total Businesses

**17,417**

Total Employees

## EDUCATION

**4%**

No High School  
Diploma

**24%**

High School  
Graduate

**26%**

Some  
College

**46%**

Bachelor's/Grad/Prof  
Degree

## INCOME



**\$42,006**  
Per Capita  
Income



**\$86,433**  
Median  
Household  
Income



**\$110,760**  
Average  
Household  
Income

## EMPLOYMENT

**68.5**  
White  
Collar %

**16.7**  
Blue  
Collar %

**14.8**  
Services  
%

**equity** | brokerage

The information contained herein has been obtained from the property owner or other sources that we deem reliable. Although we have no reason to doubt its accuracy, no representation or warranty is made regarding the information, and the property is offered "as is." The submission may be modified or withdrawn at any time by the property owner.