

2100 Morrison Ave - Bismarck ND



3,000 SF or 6,000 SF
INDUSTRIAL SPACE FOR LEASE \$ 8.25 PSF GROSS RENT

RETAIL • INVESTMENTS • OFFICE • INDUSTRIAL • SITE SELECTION • LEASING • BUILD TO SUIT • BROKERAGE



PROPERTY INFORMATION

⇒ 6,000 sf Available @ \$8.25 psf Gross Rent
 - 1,500 sf Office, 4,500 sf Shop

OR

⇒ 3,000 sf Available @ \$8.25 psf Gross Rent
 - 1,500 sf Office, 1,500 sf Shop

⇒ Built in 2011

⇒ Office w/ lobby

⇒ 3 Private offices

⇒ Break room w/ kitchenette

⇒ Copier / office equipment room

⇒ (3) 12' x 14' Overhead doors

⇒ Floor drains

Tenant is responsible for:

- ⇒ All utilities
- ⇒ Renters insurance
- ⇒ Interior maintenance

Landlord is responsible for:

- ⇒ Real estate taxes
- ⇒ Building insurance
- ⇒ General snow removal

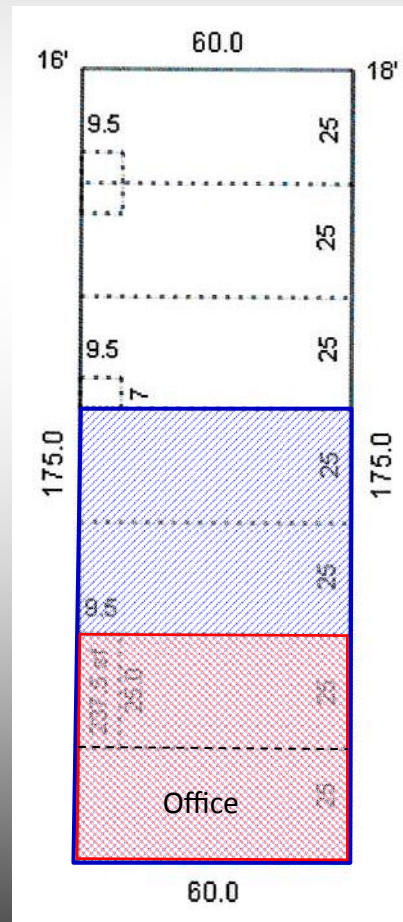

Lease Options:

- 6,000 sf
- or
- 3,000 sf





RETAIL • INVESTMENTS • OFFICE • INDUSTRIAL • SITE SELECTION • LEASING • BUILD TO SUIT • BROKERAGE





DANIEL COMPANIES

The Leader in Commercial Real Estate

Serving commercial real estate customers with unmatched market knowledge, experience, and well-deserved reputation for integrity. They know the Bismarck-Mandan commercial real estate market better than anyone. This powerful team delivers powerful results.



Bill Daniel, CCIM

701 220 2455



Kyle Holwagner, CCIM, SIOR

701 400 5373

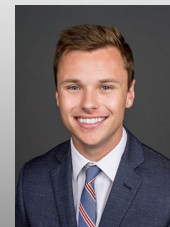

Taylor Daniel, REALTOR®

701 391 4262



Regina Crothers, REALTOR®

701 471 3140

304 E. Rosser Ave., Suite 200 • Bismarck, ND 58501 • 701.223.8488

DanielCompanies.com



RETAIL • INVESTMENTS • OFFICE • INDUSTRIAL • SITE SELECTION • LEASING • BUILD TO SUIT • BROKERAGE