

2030 E. 52nd Street N.
Sioux Falls, SD 57103

PROPERTY HIGHLIGHTS

- One loading dock
- 14'x12' overhead door
- Sprinkler
- 440mp 3-phase power
- Side wall height: 26'
- Floor drain
- Landlord will consider direct lease based on terms

LOCATION DESCRIPTION

Located in northeast Sioux Falls in the Sioux Empire Development Park IV

Area neighbors include Linde Welding Gas & Equipment Center, AVPro Edge, Midwestern Mechanical, Core & Main, Convergent, Pepsi Bottling Group, Lift Solutions, K&J Trucking, Marco Technologies, Vander Haag's Inc

Lease Rate	\$7.50 PSF NNN
NNN Expenses	\$1.80 PSF
Space Available	5,775 SF

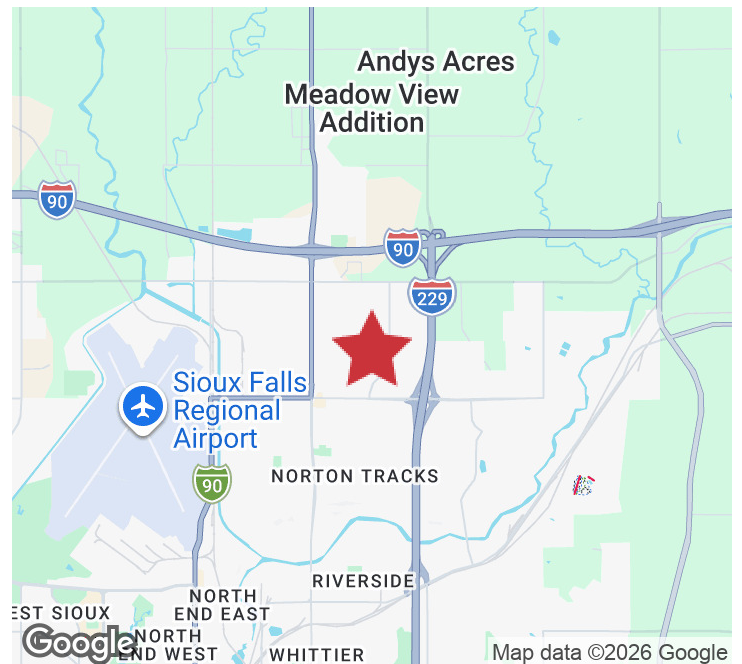

BILL CONNELLY

Vice President

bconnelly@naisiouxfalls.com

605.254.2360

2500 W. 49th St. Suite 100

Sioux Falls, SD 57105

605.357.7100

naisiouxfalls.com

FLOOR PLAN

2030 E. 52ND STREET N.
Sioux Falls, SD 57103

FOR SUBLEASE

Industrial Space

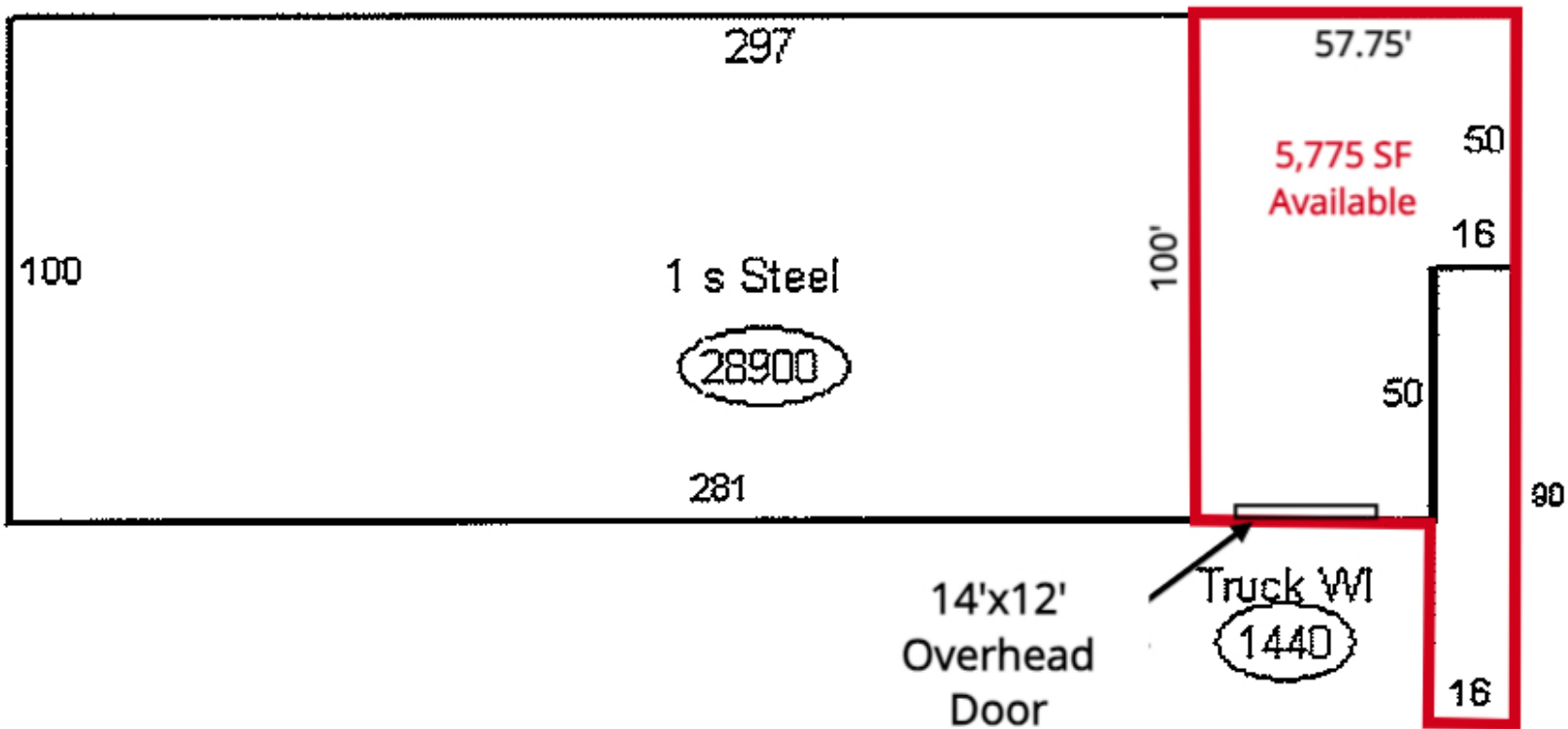

PHOTOS

2030 E. 52ND STREET N.
Sioux Falls, SD 57103

FOR SUBLEASE
Industrial Space



AERIAL

2030 E. 52ND STREET N.
Sioux Falls, SD 57103

FOR SUBLEASE
Industrial Space



SUBJECT PROPERTY

Map data ©2025 Imagery ©2025 Airbus, Maxar Technologies, USDA/FPAC/Geo