

NUMBER 10 LOWER THAMES STREET

LONDON EC3

Riverside Offices To Let
3,634 – 29,995 Sq Ft

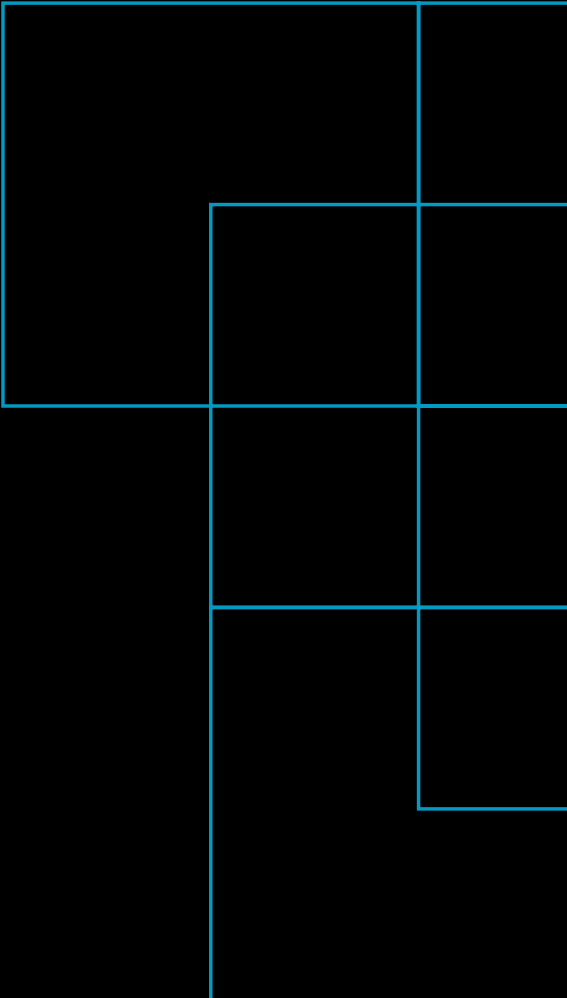

3,634 – 29,995 SQ FT
OF FULLY REFURBISHED
RIVERSIDE OFFICE
SPACE IN A
LANDMARK BUILDING



SPECIFICATION



**Refurbished
reception and
common parts**



**Ground floor
café amenity**



Panoramic river views



Lower ground
floor gym



New LED lighting



**Private terrace
(5th and
6th floors)**



**24 hour security
and manned
reception**



Bicycle racks and shower facilities

ACCOMMODATION

Floor	Sq Ft	Sq M
6th (Part)	3,634	338
5th (Part)	3,994	371
1st	22,367	2,078
Total	29,995	2,786



VIEW FROM THE FIRST FLOOR

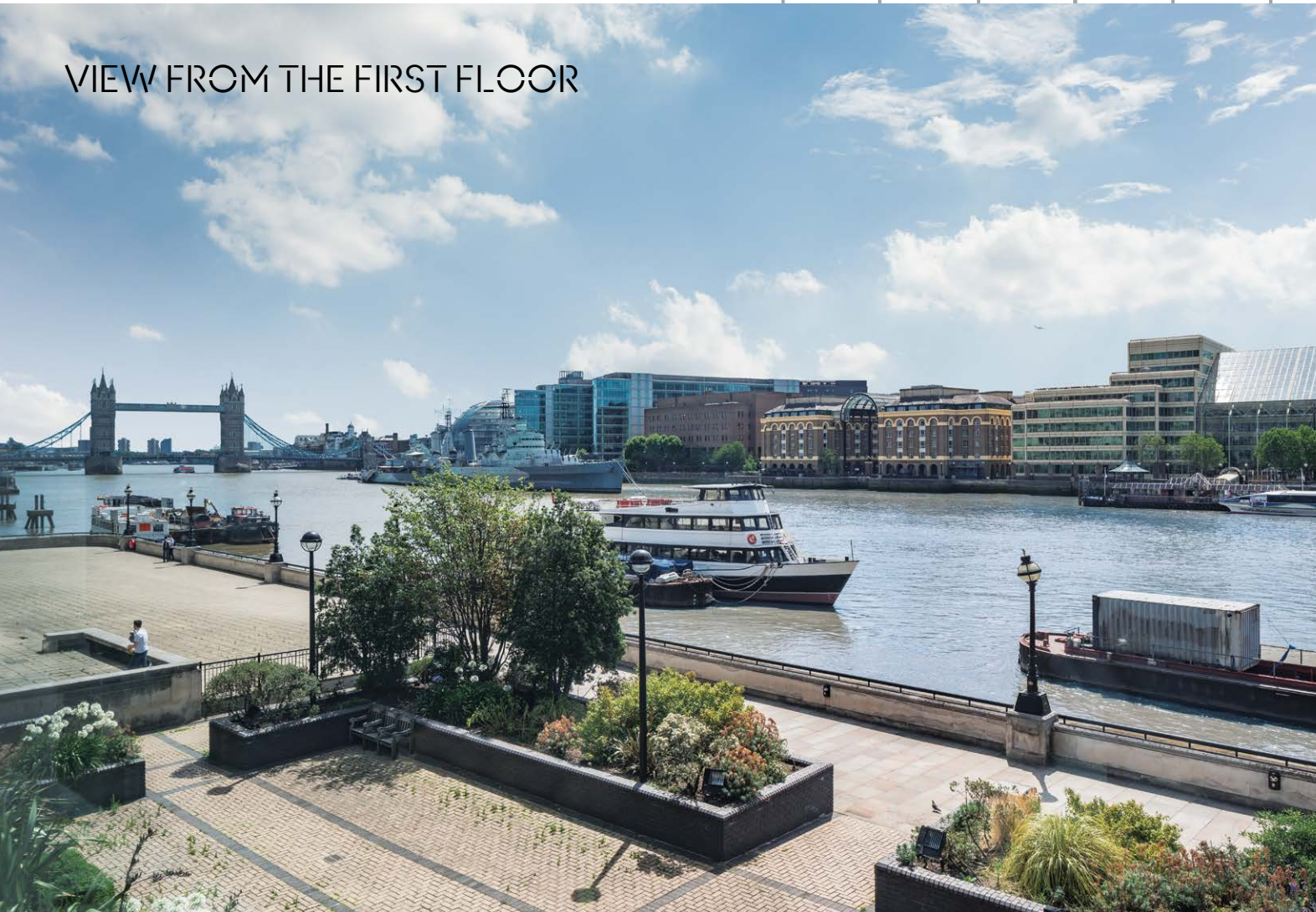

1ST FLOOR PLAN

22,367 SQ FT / 2,078 SQ M

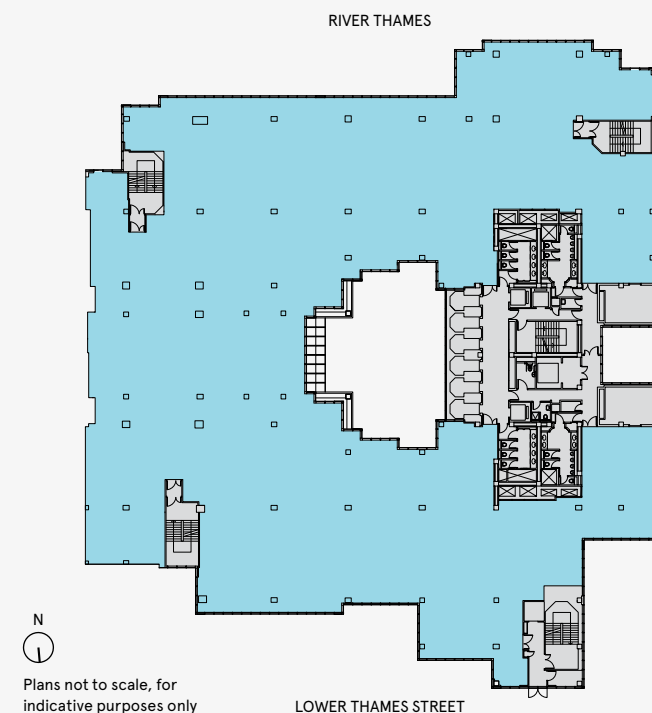

1ST FLOOR SPACE PLAN

22,367 SQ FT / 2,078 SQ M

Workstations	196	4 person meeting room	02
Management Offices	01	Receptionist	02
12 person meeting room	02		
8 person meeting rooms	02		
6 person meeting rooms	02	Total Headcount	199

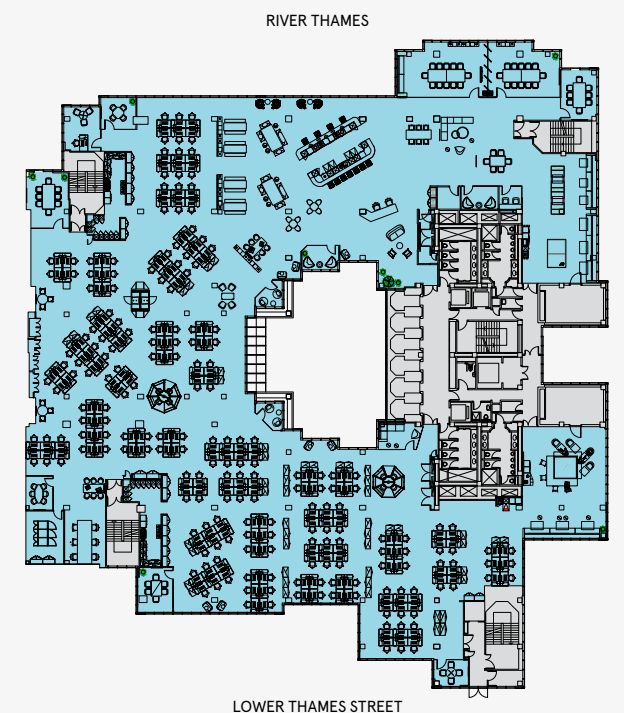

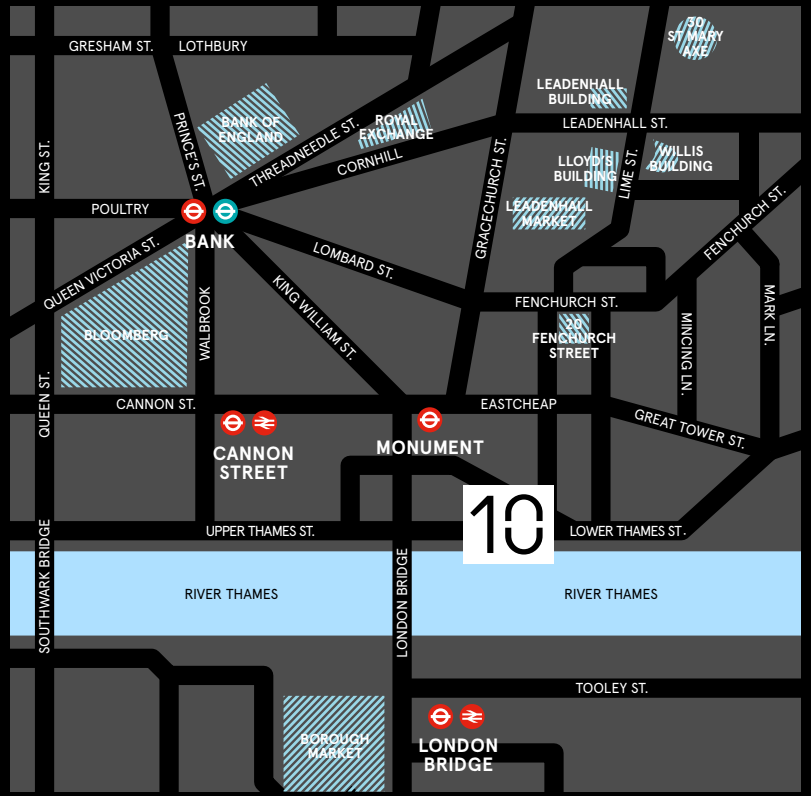

LOCATION

Located on the bank of the River Thames close to London Bridge. The Building has excellent transport links from Monument, Cannon Street, Bank & London Bridge providing fast and frequent services across London and the south east.

MONUMENT



3 min walk

CANNON STREET



5 min walk

BANK



6 min walk

LONDON BRIDGE



9 min walk

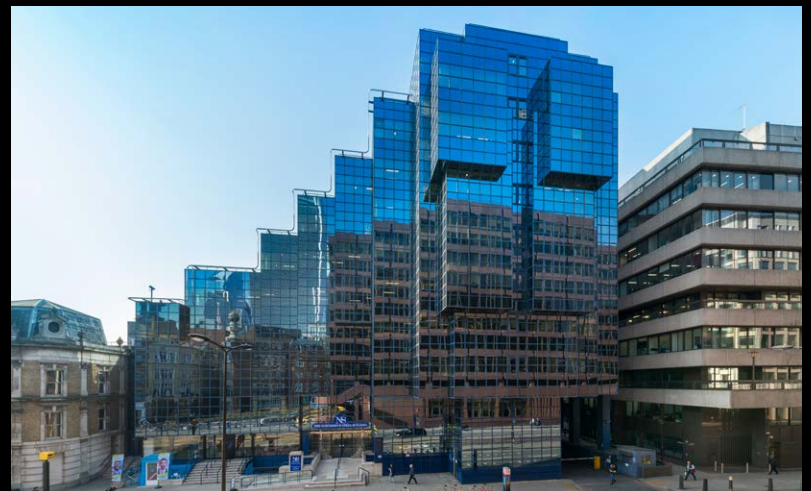

VIEWING

Strictly through joint sole letting agents.

TERMS

Upon application.

Tom Fayers
07973 821 247
tom.fayers@cushwake.com

Andrew Parker
07826 946 330
andrew.parker@cushwake.com



Jack Wells
07741 900 431
jw@newtonperkins.com

Jon Beilin
07976 392 016
jb@newtonperkins.com

