

- MAIN ENTRANCE
- ← EXIT
- E ELECTRICAL ROOM
- F FIRE RISER ROOM
- ☒ ROOF HATCH

EXHIBIT A

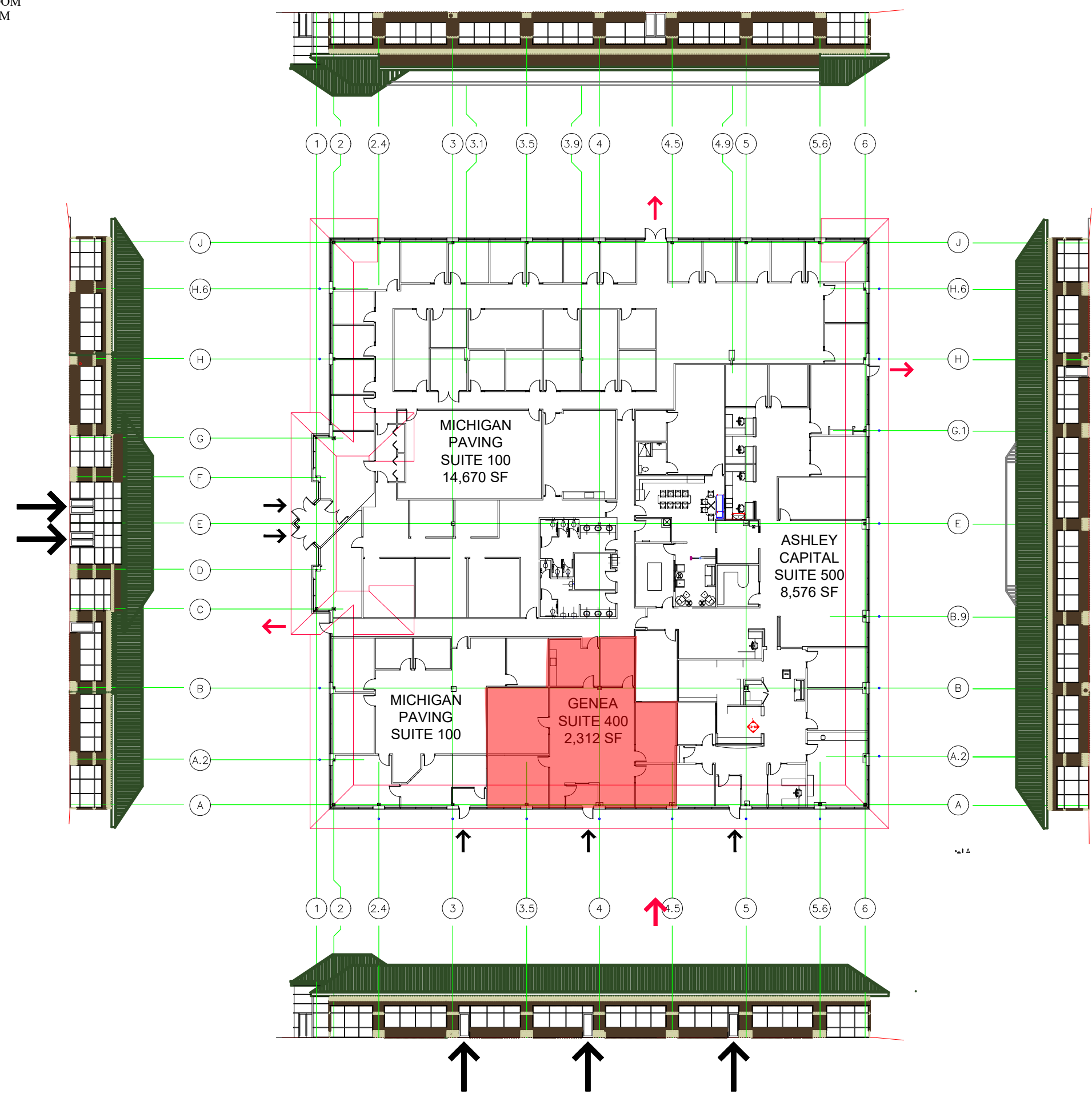

Trademark Commons

2575 Haggerty Road
Canton, MI 48188

BUILDING SHELL

- CLEAR HEIGHT
- 9 FT CEILINGS

FLOOR DOCK AREA - 4" CONCRETE
 • REINFORCED W/ STEEL & FIBERMESH
 OVER 6 MIL VAPOR BARRIER ON
 4" MIN COMPACTED GRAN. FILL.

WALLS

- 6" GALV. METAL STUDS @ 16" O.C.
 W/BATT INSUL. INFILL (R-19 MIN.)
 1/2" INSUL. SHEATHING
 MIN. 1" AIR SPACE
 BRICK VENEER W/HORIZ. JT. REINF.
 @ 24" O.C. & GALV. MTL. METAL
 BRICK TIES @ 24" O.C. E.W.

ROOF

- BALLASTED SINGLE PLY EPDM
 OVER R-15.3 RIGID INSUL. ON
 1 1/2" - 22 GA. TYPE "B" METAL ROOF
 DECK OVER STEEL JOISTS

STEEL FRAME

- COMBINATION WEB 8"X4" AND
 6"X6" TUBE STRUCTURAL COLUMNS
 WITH A JOIST / JOIST GIRDER SYSTEM

BUILDING SYSTEMS

ELECTRICAL SERVICE

- ONE (1) 300 KVA 480/277 VOLT
 3 PHASE

OFFICE LIGHTING

- RECESSED LIGHT FIXTURES WITH
 T-8 LAMPS

NATURAL GAS SERVICE

- ?

HEATING

- GAS FIRED PACKAGE
 ROOT TOP UNITS SUPPLYING
 HEATING AND COOLING

DOMESTIC WATER

- 2" FROM 8" CITY WATER MAIN

FIRE PROTECTION

- ?

SANITARY

- 6" INTO 10" CITY MAIN



NORTH