



**KBS** Millrock North  
6440 South Millrock Drive

**KBS**

KBS.com

**FOR MORE INFORMATION**

**Brandon Fugal**  
+1 801 947 8300  
brandon.fugal@colliers.com

**Jordan Wall**  
+1 801 947 8300  
jordan.wall@colliers.com

**Josh Smith**  
+1 801 947 8300  
josh.smith@colliers.com



www.colliers.com





# Floor Plans

GARDEN LEVEL - 11,321 RSF

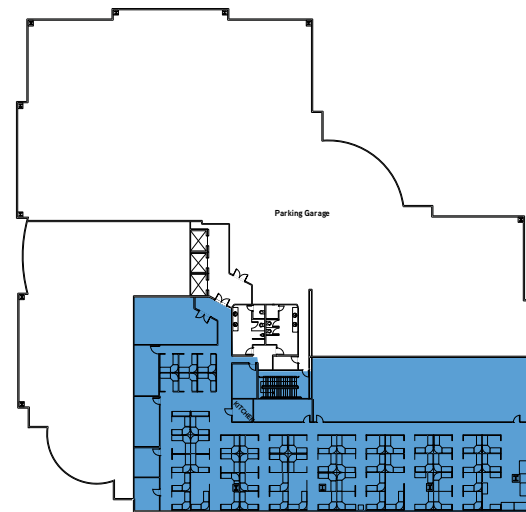

THIRD FLOOR - 10,346 RSF



FOURTH FLOOR - 10,550 RSF



# Property Highlights

- 32,217 rentable square feet
- \$34.00/SF full service lease rate
- Large efficient floor plates
- Full lobby renovations recently completed
- Ample structured/covered parking
- Unbeatable views of the Wasatch Mountains and the Salt Lake Valley
- Millrock Park offers a 22 acre campus with over six acres of green space

# New Lobby /Business Lounge /Fitness Center

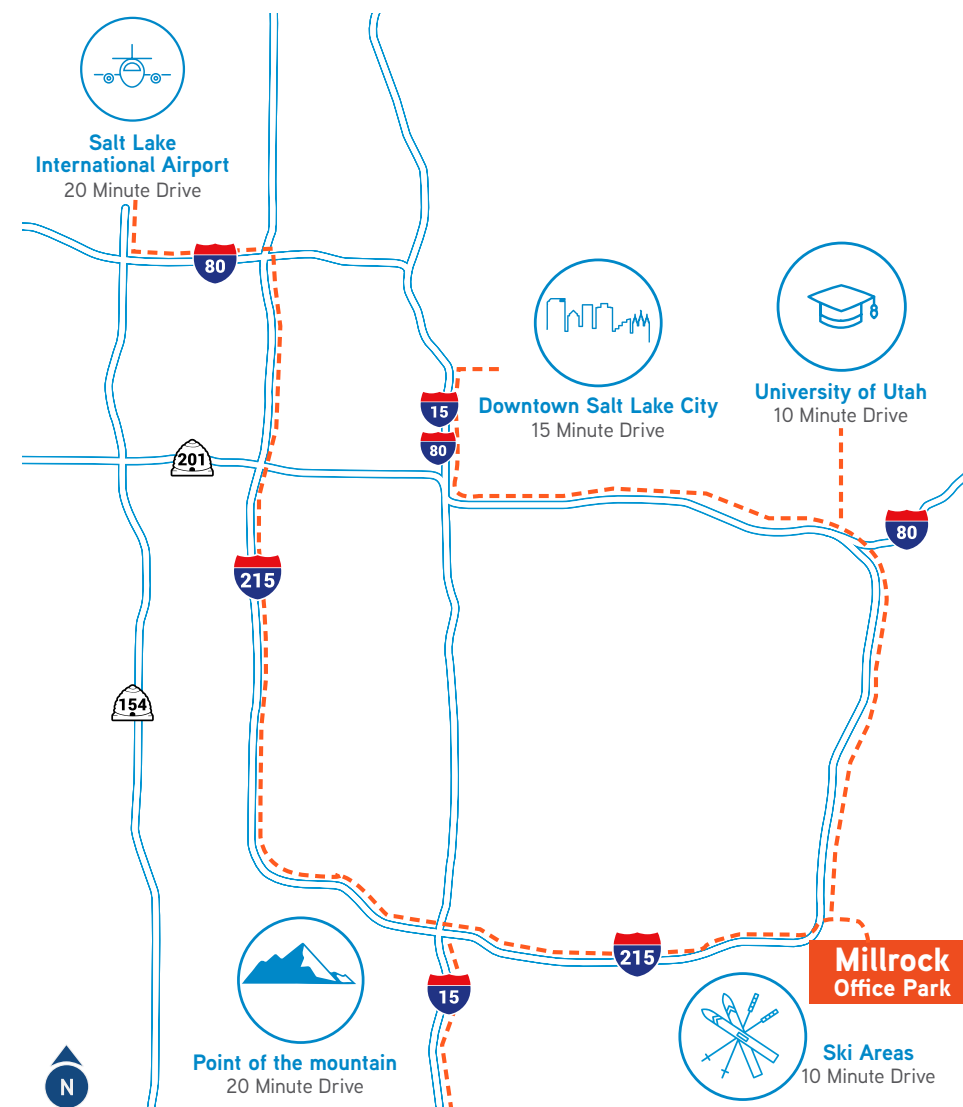

## RESTAURANTS



## HOTELS



## SERVICES/RETAIL

