

PRINTED 06/04/15 - FILE: \\LGA\Servers\lga\Documents\1502\150203 West Front Village Pad Building 3\150203 West Front Village Pad Building 3.dwg

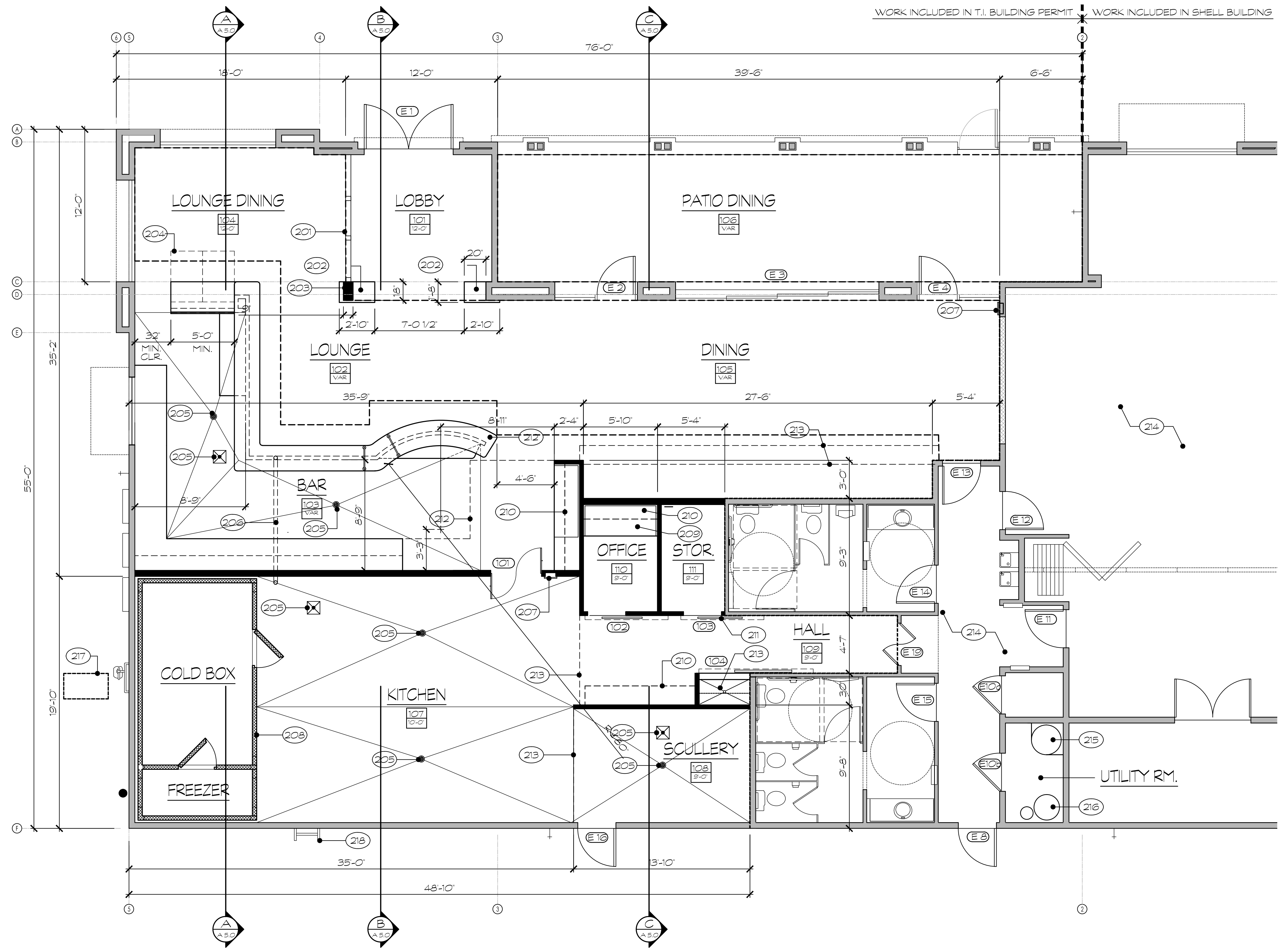

WORK INCLUDED IN T.I. BUILDING PERMIT | WORK INCLUDED IN SHELL BUILDING

# FLOOR PLAN

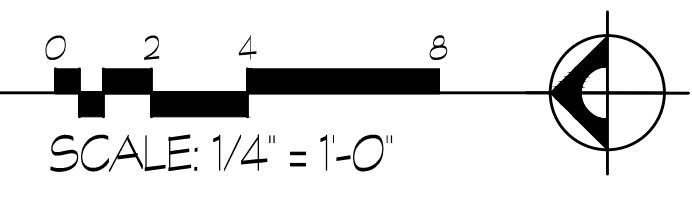

**WALL LEGEND**

- [A] NEW WALLS 2X6 DF FRAMING @ 16" O.C. WITH FULL DEPTH SOUND INSULATION. FINISH: 5/8" GYP. BD.
- [B] BUILDING SHELL WALLS

## CONSTRUCTION NOTES

MOISTURE CONTENT OF BUILDING MATERIALS USED IN WALL AND FLOOR FRAMING IS CHECKED BEFORE ENCLOSURE AN OPERATION AND MAINTENANCE MANUAL SHALL BE PROVIDED TO THE BUILDING OCCUPANT OWNER.

INSULATION:  
 - R-21 IN EXTERIOR WALLS  
 - R-19 IN INTERIOR WALLS  
 - R-38 IN CEILING

PAPER-FACED INSULATION IS PROHIBITED IN ATTICS OR OTHER VENTILATED SPACES. REFER TO TITLE 24 REPORT FOR MORE INFORMATION.

FINISHES:  
 ADHESIVES, SEALANTS, AND CAULKS SHALL BE COMPLIANT WITH PRODUCT-WEIGHTED MIR LIMITS FOR ROC AND OTHER TOXIC COMPOUNDS  
 AEROSOL PAINTS AND OTHER COATINGS SHALL BE COMPLIANT WITH PRODUCT-WEIGHTED MIR LIMITS FOR ROC AND OTHER TOXIC CHEMICALS.

## FLOOR PLAN KEYNOTES

- 201 WOOD FRAMED PARTITION - REFER TO INTERIOR ELEVATIONS
- 202 PARTIAL WALL - REFER TO INTERIOR ELEVATIONS
- 203 NEW WALL - REFER TO WALL SCHEDULE
- 204 ADA COMPLIANT SERVING COUNTER
- 205 FLOOR DRAIN/SINK - REFER TO PLUMBING PLANS
- 206 UNDER SLAB SODA LINE - REFER TO DETAIL
- 207 FIRE EXTINGUISHER - REFER TO INTERIOR ELEVATIONS
- 208 WALK-IN COLD BOX - REFER TO EQUIPMENT PLAN
- 209 BUILT-IN DESK
- 210 SHELF(S) ABOVE
- 211 SLIDING BARN DOOR - REFER TO DOOR SCHEDULE
- 212 REFER TO INTERIOR ELEVATIONS CASEWORK INFORMATION
- 213 REFER TO SHEET A 21 FOR CEILING
- 214 BUILDING SHELL - NOT A PART
- 215 WATER HEATER - REFER TO PLUMBING PLANS
- 216 WATER SOFTENER - REFER TO PLUMBING PLANS
- 217 GREASE INTERCEPTOR
- 218 ROOF ACCESS LADDER - PART OF SHELL BUILDING PERMIT



SANTA BARBARA OFFICE  
 322 N. VILLAGES STREET  
 SANTA BARBARA, CA 93103  
 TEL: (805) 238-9800  
 www.lgarchitect.com

PASO ROBLES OFFICE  
 330 10TH STREET  
 PASO ROBLES, CA 93446  
 www.lgarchitect.com



CONSULTANT

WEST FRONT VILLAGE  
 PAD BUILDING 3

ATASCADERO, CA 93422  
 APN: 156-131-023

NO.	DESCRIPTION	DATE
▲	DESIGN DEVELOPMENT	04-01-15
▲	PG SUBMITTAL NO. 1	06-04-15
▲		
▲		
▲		
▲		
▲		
▲		
▲		

SHEET CONTENTS

FLOOR PLAN

PROJECT NUMBER: 15-102.03

PAGE NUMBER

A 2.0

COPYRIGHT © 2015. ALL DESIGNS, DETAILS AND PLANS INDICATED OR REPRESENTED BY THIS DRAWING ARE OWNED BY AND ARE THE PROPERTY OF LARRY GABRIEL ARCHITECT, AND WERE CREATED, DEVELOPED AND DESIGNED FOR USE ON AND IN CONNECTION WITH THE SPECIFIC PROJECT. NONE OF THIS SHALL BE USED BY OR DISCLOSED TO ANY PERSON, FIRM OR CORPORATION WITHOUT THE WRITTEN CONSENT OF LARRY GABRIEL ARCHITECT.