

±21,229 SF OF RETAIL SPACES AVAILABLE

PARK EAST | 200 MESNAGER ST | LOS ANGELES, CA 90012

LEE & ASSOCIATES  
COMMERCIAL REAL ESTATE SERVICES

district  
REALTY GROUP

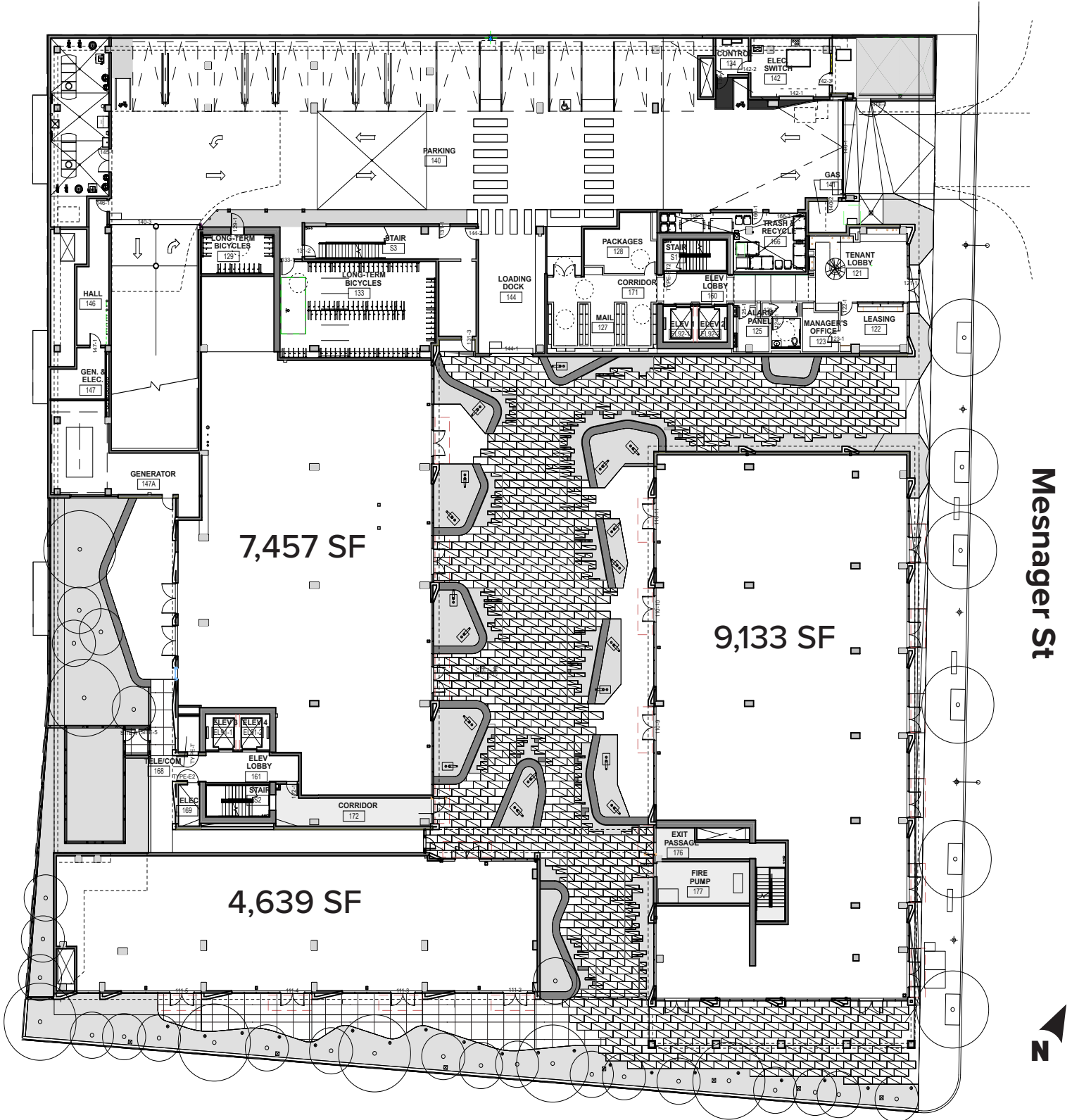

Messenger St

FOR MORE INFORMATION, PLEASE CONTACT

NOTE: Drawing not to scale. All measurements and sizes are approximate. Lessee to Verify

**EVAN JURGENSEN**  
Senior Vice President | LIC NO 01967347  
e ejurgensen@lee-associates.com  
o 323.922.3733

**EON I. LEW**  
CEO & Founder, District Realty Group | LIC NO 01730294  
e eon@districtrealtygroup.com  
c 213.769.6262

**AXEL ERICKSON**  
Senior Associate, District Realty Group | LIC NO 02159963  
e axel@districtrealtygroup.com  
c 213.797.0827

LEE & ASSOCIATES  
COMMERCIAL REAL ESTATE SERVICES

district  
REALTY GROUP

LEE & ASSOCIATES  
COMMERCIAL REAL ESTATE SERVICES

Lee & Associates® Los Angeles, Inc. Corp. ID 02174865 1201 North Main Street, Los Angeles, CA 90012  
District Realty Group Corp. ID 02044848 4334 W Sunset Blvd, Los Angeles, CA 90029

LEE-ASSOCIATES.COM/DOWNTOWNLA  
DISTRICTREALTYGROUP.COM

The information supplied herein is deemed to be reliable, however, it is provided without any representations, warranty or guarantee, expressed or implied. Tenant to verify all and to conduct independent investigation and verification of all material information, including, but not limited to environmental, survey, and zoning. Consult your attorney, accountant, or other professional advisor.