

COLORS

- BLUE (PROCESS BLUE)
- BLACK
- WHITE

GENERAL NOTES

- NEW DOUBLE-SIDES MONUMENT SIGN
- > 4" DEEP MONUMENT SIGN (NON-ILLUMINATED)
- > 4" ALUMINUM CHANNEL FRAME
- > 3" SQ. ALUMINUM TUBE MOUNTING (BLACK)
- > 1" DEEP ALUMINUM PAN SIGN FACES
- > 1/2" ACRYLIC LOGO/LETTERS
- > 1/4" ACRYLIC NUMBERS/WEBSITE
- > 1/2" ACRYLIC ADDRESS NUMBERS
- > TENANT PANELS TO BE REMOVABLE
- * CONCRETE/STONE COLUMNS BY OTHERS

POWER REQUIREMENTS:

* N/A - NON-ILLUMINATED SIGN

SIGN CALCULATIONS:

PROPOSED SIGN: 24 sq. ft.
(MAX. ALLOWED)

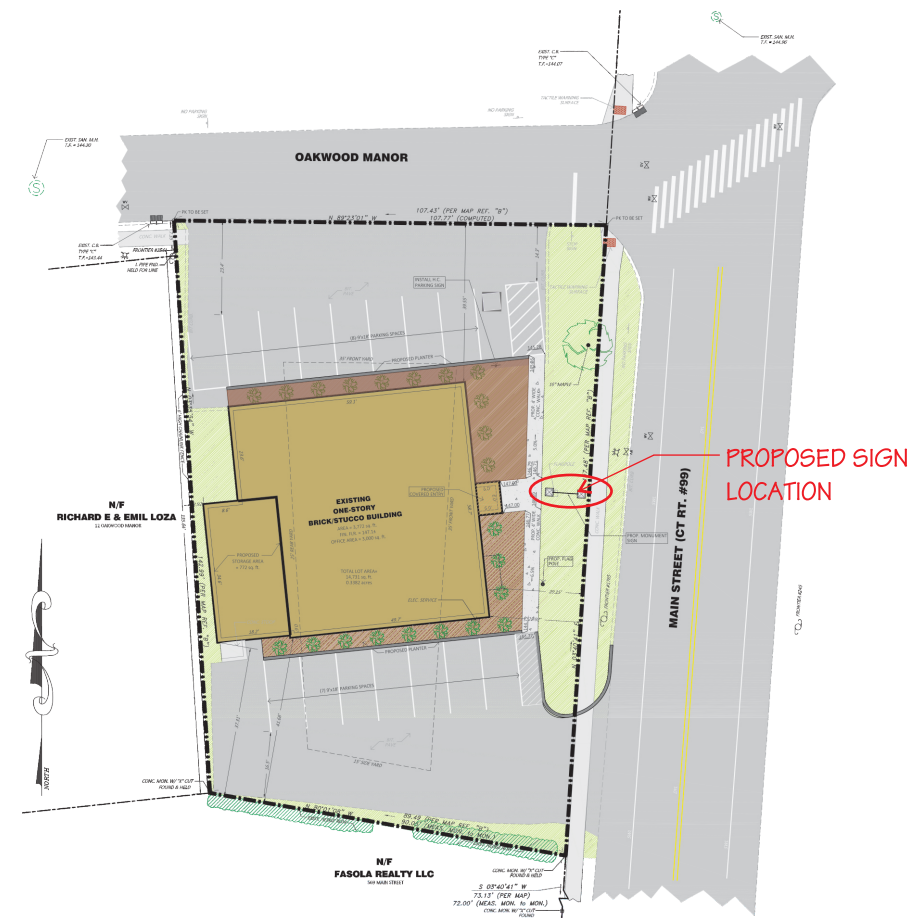

CONNECTICUT
780 FOUR ROD RD.
BERLIN, CT
PHONE (860) 829-9060

MASSACHUSETTS
21 LARSEN WAY
NORTH ATTLEBORO, MA
PHONE (508) 809-4638

THIS DRAWING IS THE PROPERTY OF NATIONAL SIGN CORPORATION AND ALL RIGHTS TO ITS USE FOR REPRODUCTION ARE RESERVED BY NATIONAL SIGN CORP.

CLIENT/PROJECT
jlncontracting
GENERAL CONTRACTING • CONSTRUCTION SERVICES

LOCATION: 573 MAIN ST
CROMWELL, CT

FILE NAME: JLN CONTRACTING
CROMWELL, CT

DRAWING NO. 70398-03

SCALE SCALE 1/2"=1'

DRAWN BY: D³

DATE: 9/10/21

PROJECT MANAGER
JEFF BARAL

REVISIONS
REV. 1: 01/09/2020