



# Center 53

**3RD FLOOR**  
**UP TO 36,516 RSF**  
**FOR SUBLEASE**

**\$28.00 PSF**

## CENTER 53

433 WEST ASCENSION WAY  
MURRAY, UT



**CUSHMAN &  
WAKEFIELD**



## CAMPUS OVERVIEW

- Newly built high end campus
- Full service fitness center with showers
- Conference center with catering area, vending amenities, and exterior entry points
- Structured parking with covered access
- Centrally located with direct access to I-15 and I-215
- Walking distance to TRAX and FrontRunner stations
- Food truck area with a rotating truck schedule
- On-site property management

# CENTER 53 | THIRD FLOOR

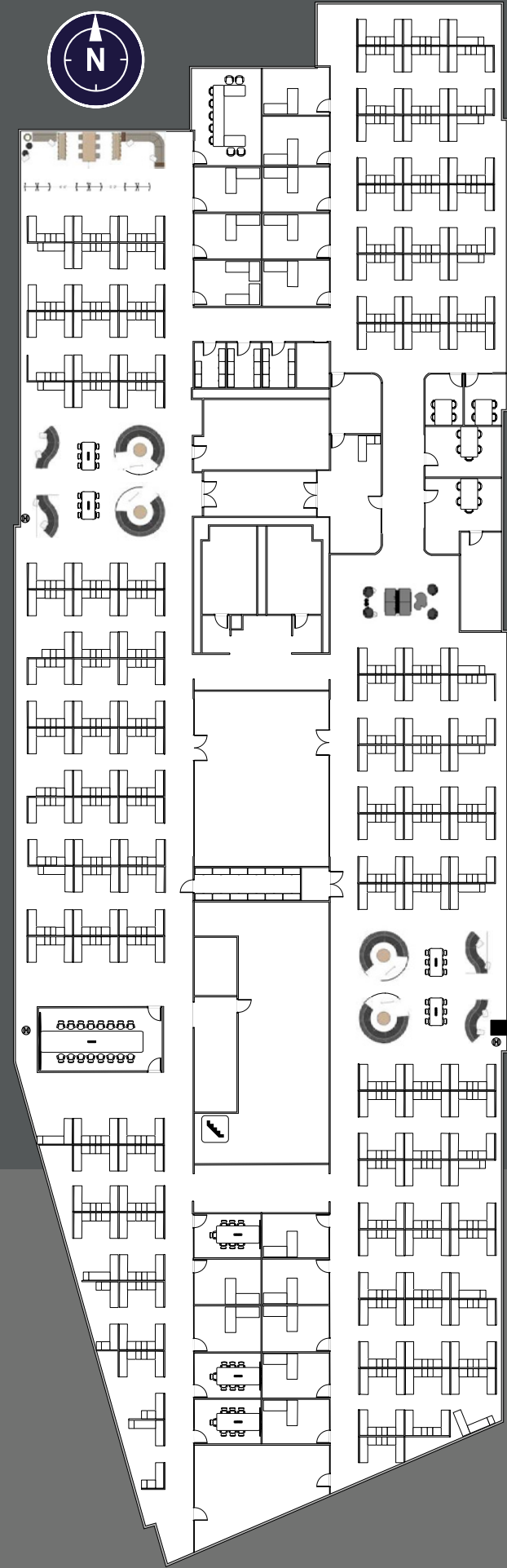
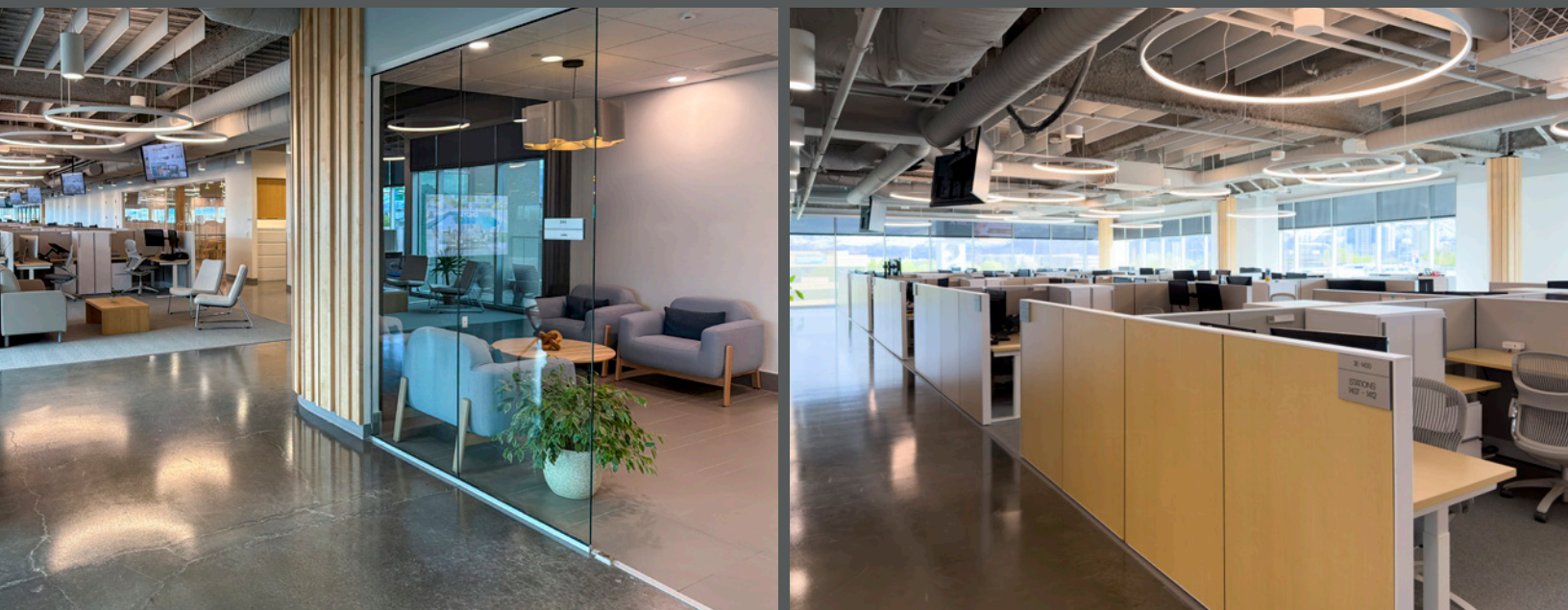

## SPACE OVERVIEW

- Newly built out plug-n-play space
- Healthy mix of open workspace, offices, and collaboration areas
- High tech finishes with glass throughout
- Two break rooms
- Floor to ceiling glass with views of Mount Olympus
- East facing private exterior deck
- LED: March 21, 2033



# CENTER 53 | THIRD FLOOR

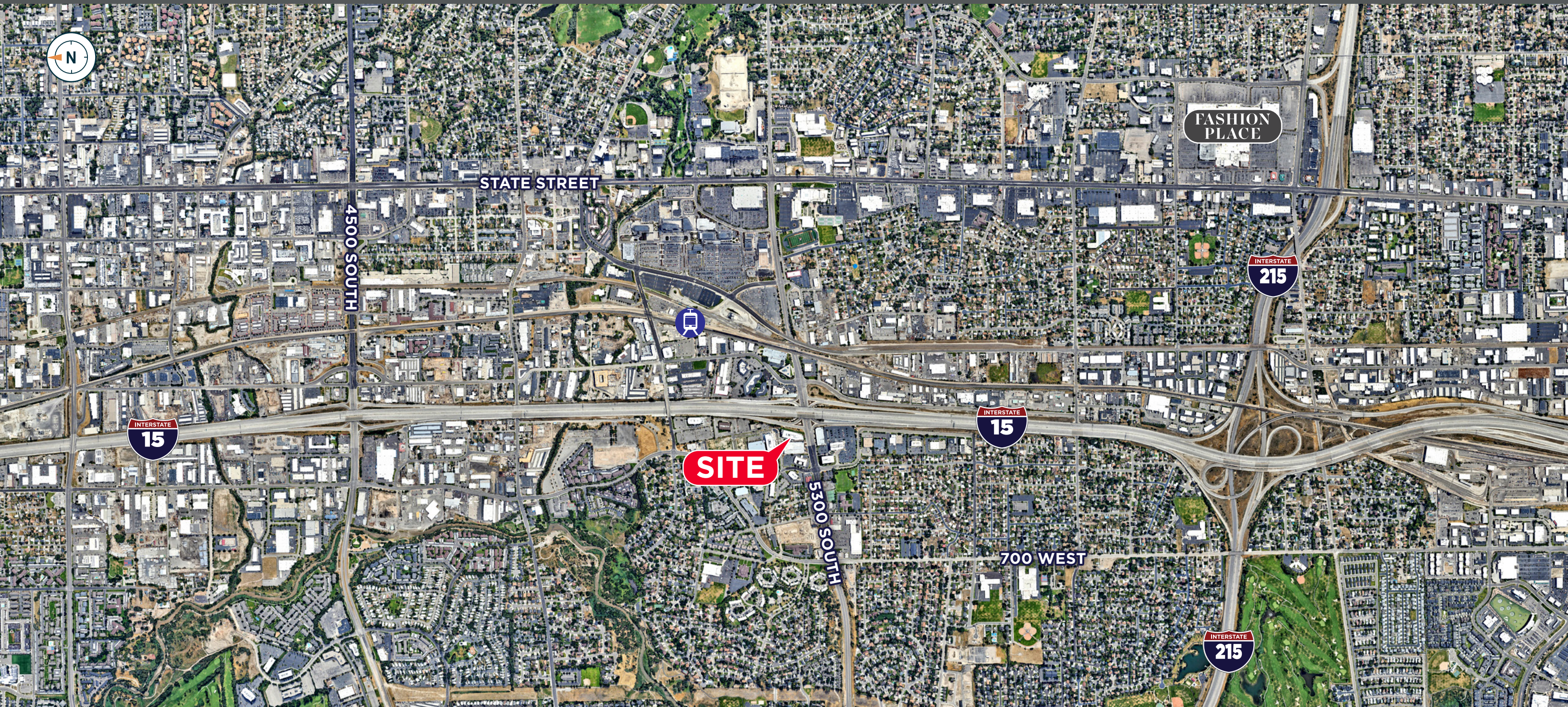

## LOCATION HIGHLIGHTS

2 MINUTES FROM



14 MINUTES FROM



SALT LAKE CITY INTERNATIONAL

12 MINUTES FROM



BIG COTTONWOOD CANYON

17 MINUTES FROM



LITTLE COTTONWOOD CANYON

9 MINUTES FROM

FASHION PLACE

12 MINUTES FROM  
FORT UNION AREA  
SHOPPING, DINING,  
ENTERTAINMENT

15 MINUTES FROM



DOWNTOWN  
SALT LAKE CITY

8 MINUTES FROM



MURRAY PARKWAY  
GOLF COURSE

# CENTER 53

433 WEST ASCENSION WAY  
MURRAY, UT

MARKETED BY

**DANA BAIRD, CCIM**

Executive Managing Director

801 303 5526

[dana.baird@cushwake.com](mailto:dana.baird@cushwake.com)

**MIKE RICHMOND**

Executive Managing Director

801 303 5434

[mike.richmond@cushwake.com](mailto:mike.richmond@cushwake.com)

**HANNAH KING**

Associate

801 303 5440

[hannah.king1@cushwake.com](mailto:hannah.king1@cushwake.com)