

AMANECER BUSINESS PARK
944 Calle Amanecer, Suite N
San Clemente, CA

1,480 Square Feet
\$1.50 SF/MO
Triple Net

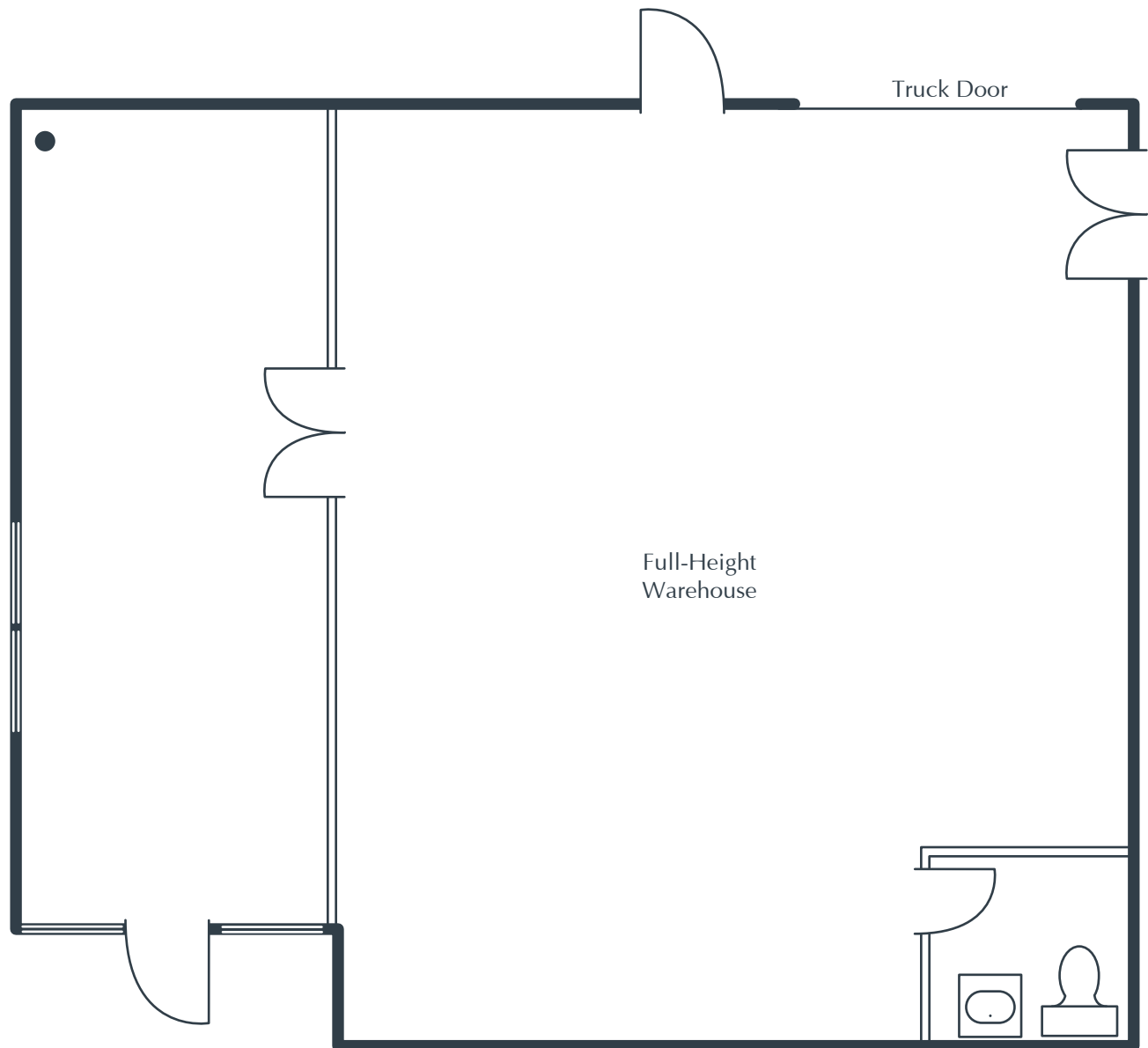

Notes:

- Reception
- Restroom
- Open Work Area
- Approximately 1,180 sq. ft. of Full-Height Warehouse with Ground-Level Truck Door
- Part of a Professionally Managed Business Park

CONTACT INFORMATION:

All rates, terms, floor plans and building facts subject to change without notice.

ea 09.10.2021

Laura Preston-Fayerman/Senior Leasing Director
Phone: 949.719.7205
Mobile: 949.274.3424
E-mail: lfayerman@olenproperties.com

Olen Properties Corp.
Seven Corporate Plaza
Newport Beach, CA 92660
949.644.OLEN
www.olenproperties.com

