

# EL FUERTE BUSINESS PARK

2788, 2790, 2792, 2794, 2796 Loker Avenue  
Carlsbad, CA 92010



**TENANT INCENTIVE** 

**6 MONTHS OF  
HALF ABATED BASE RENT  
ON A 3 YEAR LEASE**

**(ALL DEALS MUST BE FOR  
QUALIFIED TENANTS)**

**FOR LEASE**

**INDUSTRIAL BUSINESS PARK**

±1,013 - ±2,290 SF AVAILABLE



# PROPERTY HIGHLIGHTS

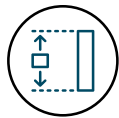

Clear Height: 16'-18'



Flex and Industrial Suites



Gas Potentially Available



Exterior Improvements Underway



Grade-Level Loading



Central North County Location



Sprinklered Suites



Close Proximity to Palomar-McClellan Airport, Shopping, Restaurants, and Housing



On-Site Deli

# AVAILABILITIES

INDUSTRIAL				
UNIT	SIZE	DESCRIPTION	LEASE RATE	AVAILABILITY
<b>2790 Loker Avenue / Suite 105</b>	1,114 SF	Reception, Restroom, Warehouse, and One (1) Grade Level Roll-Up Door	\$1.75/SF + *Est. NNN	Now
<b>2790 Loker Avenue / Suite 108</b>	1,013 SF	Reception, Restroom, Warehouse, and One (1) Grade Level Roll-Up Door	\$1.75/SF + *Est. NNN	Now
<b>2796 Loker Avenue / Suite 103</b>	1,772 SF	Reception, Private Office, Restroom, Warehouse, and 1 Grade Level Roll-Up Door	\$1.69/SF + *Est. NNN	Now
<b>2796 Loker Avenue / Suite 105</b>	2,290 SF	Reception, Private Office, Restroom, Warehouse, and 1 Grade Level Roll-Up Door	\$1.59/SF + *Est. NNN	Now
<b>2796 Loker Avenue / Suite 109</b>	1,766 SF	Reception, Private Office, Restroom, Warehouse, and 1 Grade Level Roll-Up Door	\$1.69/SF + *Est. NNN	Now

\*Est. NNN: \$0.55/SF



# FLOOR PLAN

## 2790 LOKER AVENUE

**105**

SUITE AVAILABLE

**1,114**

TOTAL SQUARE FEET

**100 Amps, 3-Phase**

POWER

**\$1.75/ SF NNN**

LEASE RATE + \*Est. NNN: \$0.55/SF

**Now**

DATE AVAILABLE

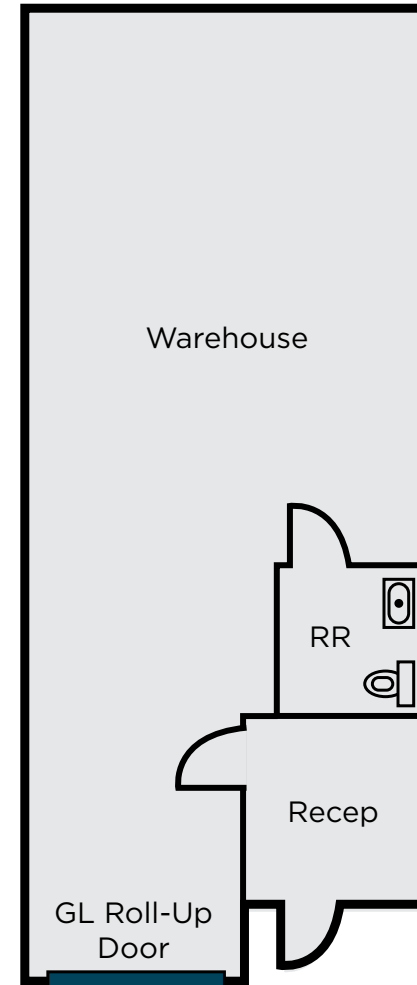

# FLOOR PLAN

## 2790 LOKER AVENUE

**108**

SUITE AVAILABLE

**1,013**

TOTAL SQUARE FEET

**100 Amps, 3-Phase**

POWER

**\$1.75/ SF NNN**

LEASE RATE + \*Est. NNN: \$0.55/SF

**Now**

DATE AVAILABLE

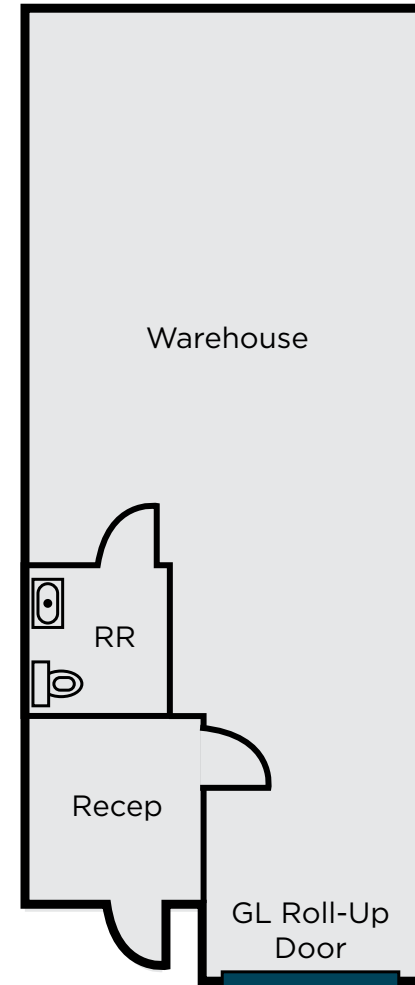

# FLOOR PLAN

## 2796 LOKER AVENUE

**103**

SUITE AVAILABLE

**1,772**

TOTAL SQUARE FEET

**100 Amps, 3-Phase**

POWER

**\$1.69/ SF NNN**

LEASE RATE + \*Est. NNN: \$0.55/SF

**Now**

DATE AVAILABLE

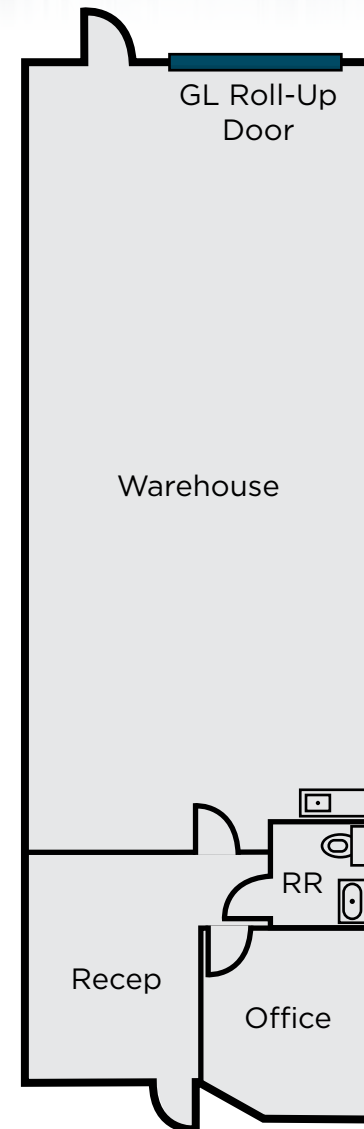

# FLOOR PLAN

## 2796 LOKER AVENUE

**105**

SUITE AVAILABLE

**2,290**

TOTAL SQUARE FEET

**100 Amps, 3-Phase**

POWER

**\$1.59/ SF NNN**

LEASE RATE + \*Est. NNN: \$0.55/SF

**Now**

DATE AVAILABLE

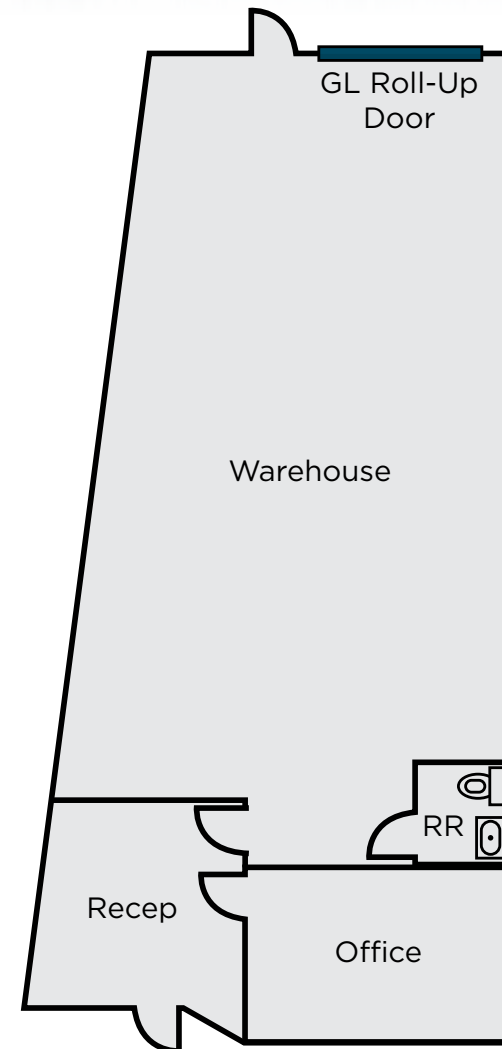

# FLOOR PLAN

## 2796 LOKER AVENUE

**109**

SUITE AVAILABLE

**1,766**

TOTAL SQUARE FEET

**200 Amps, 3-Phase**

POWER

**\$1.69/ SF NNN**

LEASE RATE + \*Est. NNN: \$0.55/SF

**Now**

DATE AVAILABLE

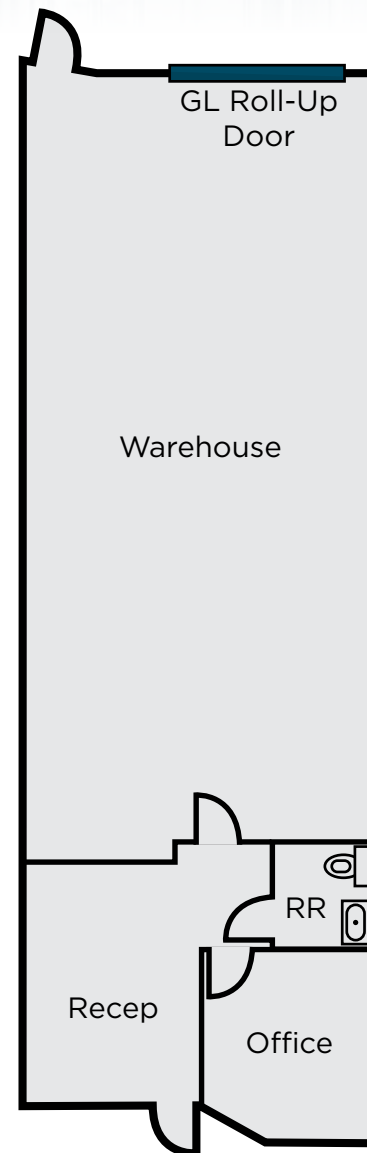

# PHOTOS



# LOCATION



# EL FUERTE BUSINESS PARK

FOR LEASE

CIP REAL ESTATE

## CONTACT BROKERS

**CONOR BOYLE**

760.458.5739  
conor.boyle@cushwake.com  
Lic. No.01813305

**TYLER STEMLEY**

760.908.4270  
tyler.stemley@cushwake.com  
Lic. No.02003867

**CARSON ODABASHIAN**

760.431.3836  
carson.odabashian@cushwake.com  
Lic. No.02207230

©2026 Cushman & Wakefield. All rights reserved. The information contained in this communication is strictly confidential. This information has been obtained from sources believed to be reliable but has not been verified. NO WARRANTY OR REPRESENTATION, EXPRESS OR IMPLIED, IS MADE AS TO THE CONDITION OF THE PROPERTY (OR PROPERTIES) REFERENCED HEREIN OR AS TO THE ACCURACY OR COMPLETENESS OF THE INFORMATION CONTAINED HEREIN, AND SAME IS SUBMITTED SUBJECT TO ERRORS, OMISSIONS, CHANGE OF PRICE, RENTAL OR OTHER CONDITIONS, WITHDRAWAL WITHOUT NOTICE, AND TO ANY SPECIAL LISTING CONDITIONS IMPOSED BY THE PROPERTY OWNER(S). ANY PROJECTIONS, OPINIONS OR ESTIMATES ARE SUBJECT TO UNCERTAINTY AND DO NOT SIGNIFY CURRENT OR FUTURE PROPERTY PERFORMANCE.



**CUSHMAN &  
WAKEFIELD**