

Architecture
Interior Design
Engineering
Landscape Architecture
at: 249 East Main Street
Suite 100
Lexington, Kentucky 40507
or: (609) 254-6623
www.cmwae.com

NOT FOR
CONSTRUCTION

REVISED CONCEPT 'B'
PARK HILLS SHOPPING CENTER
3120 - 3130 PIMLICO PARKWAY
LEXINGTON, KENTUCKY

CONCEPT PHASE

Issue Date: APRIL, 2022
Drawn By: ABS
Checked By: -
Revisions:

Mark Date
AHJ SEAL



Project Number
22016.01

© 2022 CMW

'B'

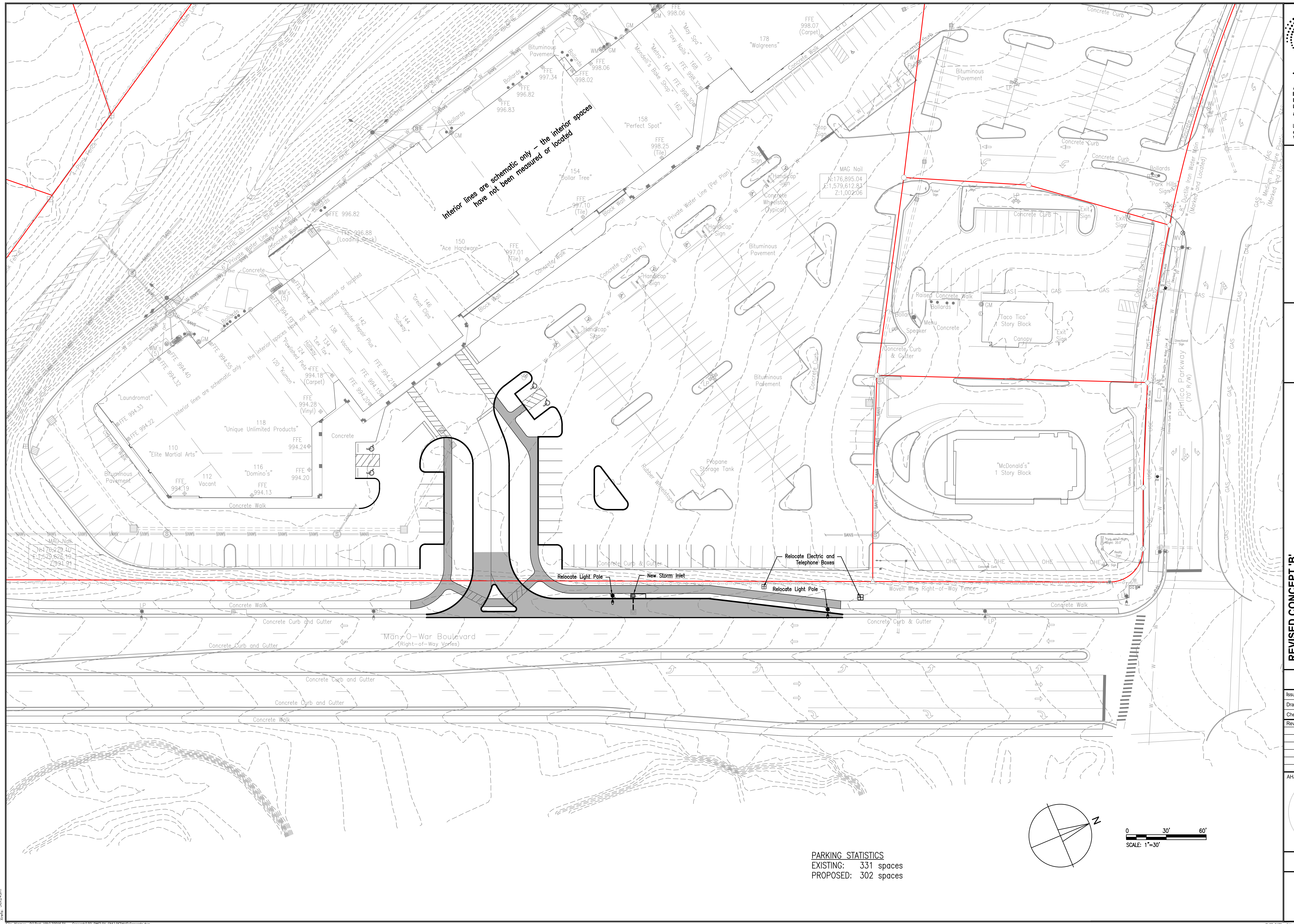

Interior lines are schematic only - the interior spaces have not been measured or located

MAG Nail
N: 176,895.04
E: 1,579,612.82
Z: 1,002.06

MAG Nail
N: 176,895.04
E: 1,579,612.82
Z: 1,002.06

PARKING STATISTICS
EXISTING: 331 spaces
PROPOSED: 302 spaces

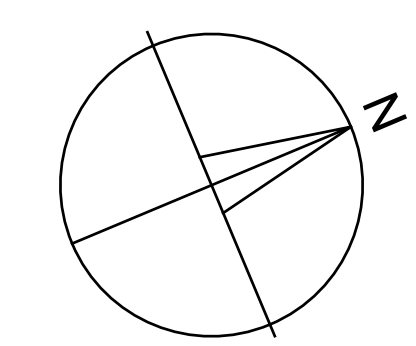

0 30' 60'
SCALE: 1"=30'

Xref: 3022.dwg

